

## ER Collet Features

We offer the widest ER Collets product range in the industry.

**Quality Standard-** Made to DIN 6499 Specification

**Material-** High Tensile Chromium Molybdenum Alloy provides greater hardness and less material deformation compared to traditional spring steel collets

**Tolerance-** Guaranteed to be within .0001" or better run out at the collet nose

**Accuracy-** Less than .0004" at 4 X Dia.

**Inspection-** 100% collet inspection, checked 3 times for concentricity

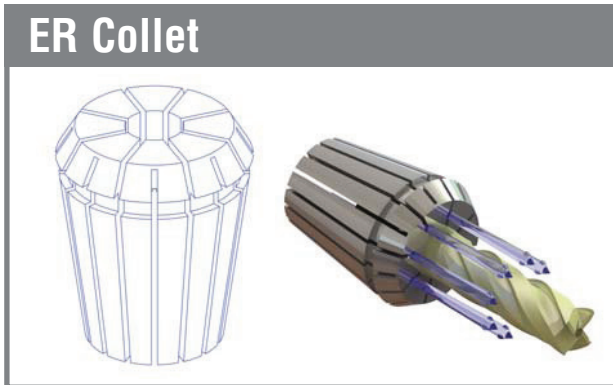

### ER Standard Type Collet

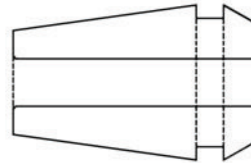

**Flexibility and Durability:**

We offers the ultimate trifecta: Wide clamping range, ultra precision, and super high pressure. Our 1300 PSI capable collets have a wide .031" collapse range and the ability to maintain less than .0001 run out at the collet nose.

### ER Counter-Bored Type Collet

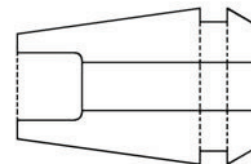

**Ultra Precision for MicroCutters:**

Our High Precision "On Size" Collets have 25% longer collet bore lengths than competitors, resulting in stronger gripping power at higher RPM's. The High Pressure Coolant Collet's special design reduces cutter vibration due to high pressure.

### High Precision ER Tap Collet

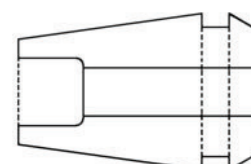

**Extreme rigidity, high pressure performance:**

Our Tap Collets are designed for all ANSI, DIN, ISO, JIS Specification Taps. 1300 PSI capable Coolant Tap Collets increase tool life by dissipating heat and preventing chip build-up.

### Dimensional Data

Style	D	D1	L	Collet Range	Coolant Collet Size Range
ER16	17.2mm	11.3mm	27.0mm	0.5 - 10.0mm	4.0 - 10.0mm (3/16" - 17/64")
ER20	21.2mm	14.5mm	31.0mm	1.0 - 13.0mm	5.0 - 13.0mm (5/32" - 1/2")
ER25	26.2mm	18.5mm	35.0mm	1.0 - 16.0mm	6.0 - 16.0mm (7/32" - 5/8")
ER32	33.2mm	24.4mm	40.0mm	2.0 - 20.0mm	10.0 - 20.0mm (1/4" - 25/32")
ER40	41.2mm	31.2mm	46.0mm	3.0mm - 26.0mm	10.0 - 26.0mm

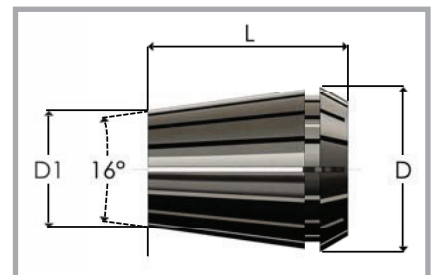

# ER8 and ER11 Collets

## ER8 Collets

Size range: 1.0mm-5.0mm (0.019"-0.196")

METRIC		
Part Number	Size	Collapse Range
ER8-039	1.0mm	1.0-0.5mm
ER8-059	1.5mm	1.5-1.0mm
ER8-078	2.0mm	2.0-1.5mm
ER8-098	2.5mm	2.5-2.0mm
ER8-118	3.0mm	3.0-2.5mm
ER8-137	3.5mm	3.5-3.0mm
ER8-157	4.0mm	4.0-3.5mm
ER8-177	4.5mm	4.5-4.0mm
ER8-196	5.0mm	5.0-4.5mm
ER8-09S	9 Pieces Set 0.5mm - 5.0mm by 0.5mm	



Our patented Coolant Collets are designed for use with cylindrical shank tools (no flats). Cutting tool should be inserted the full length of the collet. If these conditions are not met, coolant leakage may result. Seals up to maximum coolant pressure of 1000PSI.

## ER11 Collets

Size range: 1/32" - 17/64"

Size range: 1.0mm-7.0mm  
(0.019"-0.275")

Size range: 3/16" - 17/64"

Size range: 4.0mm-7.0mm

INCH		
Part Number	Size	Collapse Range
E11-002	1/32"	.031-.027"
E11-003	3/64"	.047-.031"
E11-004	1/16"	.063-.047"
E11-005	5/64"	.078-.063"
E11-006	3/32"	.094-.078"
E11-007	7/64"	.109-.094"
E11-008	1/8"	.125-.109"
E11-009	9/64"	.141-.125"
E11-010	5/32"	.156-.141"
E11-011	11/64"	.172-.156"
E11-012	3/16"	.187-.172"
E11-013	13/64"	.203-.187"
E11-014	7/32"	.219-.203"
E11-015	15/64"	.234-.219"
E11-016	1/4"	.250-.234"
E11-017	17/64"	.266-.250"

METRIC		
Part Number	Size	Collapse Range
E11-039	1.0mm	1.0-0.5mm
E11-059	1.5mm	1.5-1.0mm
E11-078	2.0mm	2.0-1.5mm
E11-098	2.5mm	2.5-2.0mm
E11-118	3.0mm	3.0-2.5mm
E11-137	3.5mm	3.5-3.0mm
E11-157	4.0mm	4.0-3.5mm
E11-177	4.5mm	4.5-4.0mm
E11-196	5.0mm	5.0-4.5mm
E11-216	5.5mm	5.5-5.0mm
E11-236	6.0mm	6.0-5.5mm
E11-255	6.5mm	6.5-6.0mm
E11-275	7.0mm	7.0-6.5mm

INCH-COOLANT-THRU		
Part Number	Size	Collapse Range
-	1/32"	-
-	3/64"	-
-	1/16"	-
-	5/64"	-
-	3/32"	-
-	7/64"	-
-	1/8"	-
-	9/64"	-
-	5/32"	-
-	11/64"	-
E11-012(C)	3/16"	.187" - .183"
E11-013(C)	13/64"	.203" - .199"
E11-014(C)	7/32"	.218" - .214"
E11-015(C)	15/64"	.234" - .230"
E11-016(C)	1/4"	.250" - .246"
E11-017(C)	17/64"	.265" - .261"

METRIC-COOLANT-THRU		
Part Number	Size	Collapse Range
-	1.0mm	-
-	1.5mm	-
-	2.0mm	-
-	-	-
-	2.5mm	-
-	3.0mm	-
-	3.5mm	-
E11-157(C)	4.0mm	4.0mm - 3.5mm
E11-177(C)	4.5mm	4.5mm - 4.0mm
E11-196(C)	5.0mm	5.0mm - 4.5mm
E11-216(C)	5.5mm	5.5mm - 5.0mm
E11-236(C)	6.0mm	6.0mm - 5.5mm
E11-255(C)	6.5mm	6.5mm - 6.0mm
E11-275(C)	7.0mm	7.0mm - 6.5mm

## ER11 Collets Sets

E11-14S	14 Piece Set 1/16" - 1/4" by 64ths
E11-12S	12 Piece Set 1.0mm - 7.0mm by 0.5mm

## ER11 Coolant Collets Sets

E11-6S(C)	6 Piece Set 3/16" - 17/64" by 64ths
E11-7S(C)	7 Piece Set 3.9mm - 7.0mm by 0.5mm

## ER16 Collets



Our patented Coolant Collets are designed for use with cylindrical shank tools (no flats). Cutting tool should be inserted the full length of the collet. If these conditions are not met, coolant leakage may result. Seals up to maximum coolant pressure of 1000PSI.

Size range: 1/32" - 13/32"

Size range: 1.0mm - 10.0mm  
(0.039"-0.393")

Size range: 3/32" - 13/32"

Size range: 4.0mm-10.0mm  
(0.157"-0.393")

INCH		
Part Number	Size	Collapse Range
E16-002	1/32"	.031" - .027"
E16-004	1/16"	.063" - .047"
E16-006	3/32"	.094" - .078"
-	7/64"	-
E16-008	1/8"	.125" - .109"
-	9/64"	-
E16-010	5/32"	.156" - .125"
-	11/64"	-
E16-012	3/16"	.187" - .156"
-	13/64"	-
E16-014	7/32"	.219" - .187"
-	15/64"	-
E16-016	1/4"	.250" - .219"
-	17/64"	-
E16-018	9/32"	.281" - .250"
-	19/64"	-
E16-020	5/16"	.312" - .281"
-	21/64"	-
E16-022	11/32"	.344" - .312"
-	23/64"	-
E16-024	3/8"	.375" - .344"
-	25/64"	-
E16-026	13/32"	.406" - .375"

METRIC		
Part Number	Size	Collapse Range
E16-039	1.0mm	1.0-0.5mm
E16-059	1.5mm	1.5-1.0mm
E16-078	2.0mm	2.0-1.5mm
E16-098	2.5mm	2.5-2.0mm
E16-118	3.0mm	3.0-2.5mm
E16-137	3.5mm	3.5-3.0mm
E16-157	4.0mm	4.0-3.5mm
E16-177	4.5mm	4.5-4.0mm
E16-196	5.0mm	5.0-4.5mm
E16-216	5.5mm	5.5-5.0mm
E16-236	6.0mm	6.0-5.5mm
E16-255	6.5mm	6.5-6.0mm
E16-275	7.0mm	7.0-6.5mm
E16-295	7.5mm	7.5-7.0mm
E16-314	8.0mm	8.0-7.5mm
E16-334	8.5mm	8.5-8.0mm
E16-354	9.0mm	9.0-8.5mm
E16-374	9.5mm	9.5-9.0mm
E16-393	10.0mm	10.0-9.5mm

INCH-COOLANT-THRU		
Part Number	Size	Collapse Range
-	1/32"	-
-	1/16"	-
E16-006(C)	3/32"	.094" - .089"
E16-007(C)	7/64"	.109" - .105"
E16-008(C)	1/8"	.125" - .121"
E16-009(C)	9/64"	.140" - .136"
E16-010(C)	5/32"	.156" - .152"
E16-011(C)	11/64"	.171" - .167"
E16-012(C)	3/16"	.187" - .183"
E16-013(C)	13/64"	.203" - .199"
E16-014(C)	7/32"	.219" - .203"
E16-015(C)	15/64"	.234" - .219"
E16-016(C)	1/4"	.250" - .234"
E16-017(C)	17/64"	.266" - .250"
E16-018(C)	9/32"	.281" - .266"
E16-019(C)	19/64"	.297" - .281"
E16-020(C)	5/16"	.312" - .297"
E16-021(C)	21/64"	.328" - .312"
E16-022(C)	11/32"	.344" - .328"
E16-023(C)	23/64"	.359" - .344"
E16-024(C)	3/8"	.375" - .359"
E16-025(C)	25/64"	.391" - .375"
E16-026(C)	13/32"	.406" - .391"

METRIC-COOLANT-THRU		
Part Number	Size	Collapse Range
-	1.0mm	-
-	1.5mm	-
-	2.0mm	-
-	2.5mm	-
-	3.0mm	-
-	3.5mm	-
E16-157(C)	4.0mm	4.0mm - 3.5mm
E16-177(C)	4.5mm	4.5mm - 4.0mm
E16-196(C)	5.0mm	5.0mm - 4.5mm
E16-216(C)	5.5mm	5.5mm - 5.0mm
E16-236(C)	6.0mm	6.0mm - 5.5mm
E16-255(C)	6.5mm	6.5mm - 6.0mm
E16-275(C)	7.0mm	7.0mm - 6.5mm
E16-295(C)	7.5mm	7.5mm - 7.0mm
E16-314(C)	8.0mm	8.0mm - 7.5mm
E16-334(C)	8.5mm	8.5mm - 8.0mm
E16-354(C)	9.0mm	9.0mm - 8.5mm
E16-374(C)	9.5mm	9.5mm - 9.0mm
E16-393(C)	10.0mm	10.0mm - 9.5mm

### ER16 Collets Sets

E16-12S	12 Piece Set 1/32" - 13/32" by 32nds
E16-09S	9 Piece Set 1.0mm - 10.0mm by 1mm

### ER16 Coolant Collets Sets

E16-11S(C)	11 Piece Set 3/32" - 13/32" by 32nds
E16-13S(C)	13 Piece Set 4.0mm - 10.0mm by 0.5mm

See dimensional data for ER16 Collets on page 31.

# ER20 Collets



Size range: 1/16" - 1/2"

INCH		
Part Number	Size	Collapse Range
E20-004	1/16"	.063" - .047"
E20-006	3/32"	.094" - .078"
E20-008	1/8"	.125" - .109"
E20-010	5/32"	.156" - .125"
-	11/64"	-
E20-012	3/16"	.187" - .156"
-	13/64"	-
E20-014	7/32"	.219" - .187"
-	15/64"	-
E20-016	1/4"	.250" - .219"
-	17/64"	-
E20-018	9/32"	.281" - .250"
-	19/64"	-
E20-020	5/16"	.312" - .281"
-	21/64"	-
E20-022	11/32"	.344" - .312"
-	23/64"	-
E20-024	3/8"	.375" - .344"
-	25/64"	-
E20-026	13/32"	.406" - .375"
-	27/64"	-
E20-028	7/16"	.437" - .406"
-	29/64"	-
E20-030	15/32"	.469" - .437"
-	31/64"	-
E20-032	1/2"	.500" - .469"



Size range: 5/32" - 1/2"

INCH-COOLANT-THRU		
Part Number	Size	Collapse Range
-	1/16"	-
-	3/32"	-
-	1/8"	-
E20-010(C)	5/32"	.156" - .152"
E20-011(C)	11/64"	.172" - .167"
E20-012(C)	3/16"	.187" - .183
E20-013(C)	13/64"	.203" - .199"
E20-014(C)	7/32"	.219" - .203"
E20-015(C)	15/64"	.234" - .219"
E20-016(C)	1/4"	.250" - .234"
E20-017(C)	17/64"	.266" - .250"
E20-018(C)	9/32"	.281" - .266"
E20-019(C)	19/64"	.297" - .281"
E20-020(C)	5/16"	.312" - .297"
E20-021(C)	21/64"	.328" - .312"
E20-022(C)	11/32"	.344" - .328"
E20-023(C)	23/64"	.359" - .344"
E20-024(C)	3/8"	.375" - .359"
E20-025(C)	25/64"	.391" - .375"
E20-026(C)	13/32"	.406" - .391"
E20-027(C)	27/64"	.422" - .406"
E20-028(C)	7/16"	.437" - .422"
E20-029(C)	29/64"	.453" - .437"
E20-030(C)	15/32"	.469" - .453"
E20-031(C)	31/64"	.484" - .469"
E20-032(C)	1/2"	.500" - .484"

Our patented Coolant Collets are designed for use with cylindrical shank tools (no flats). Cutting tool should be inserted the full length of the collet. If these conditions are not met, coolant leakage may result. Seals up to maximum coolant pressure of 1000PSI.

Size range: 2.0mm - 13.0mm  
(0.039"-0.511")

METRIC		
Part Number	Size	Collapse Range
E20-078	2.0mm	2.0-1.0mm
E20-118	3.0mm	3.0-2.5mm
E20-137	3.5mm	3.5-2.5mm
E20-157	4.0mm	4.0-3.5mm
-	4.5mm	-
E20-196	5.0mm	5.0-4.0mm
-	5.5mm	-
E20-236	6.0mm	6.0-5.0mm
-	6.5mm	-
E20-275	7.0mm	7.0-6.0mm
-	7.5mm	-
E20-314	8.0mm	8.0-7.0mm
-	8.5mm	-
E20-354	9.0mm	9.0-8.0mm
-	9.5mm	-
E20-393	10.0mm	10.0-9.0mm
-	10.5mm	-
E20-433	11.0mm	11.0-10.0mm
E20-452	11.5mm	11.5-11.0mm
E20-472	12.0mm	12.0-11.0mm
-	12.5mm	-
E20-511	13.0mm	13.0-12.0mm

Size range: 5.0mm-13.0mm  
(0.196"-0.511")

METRIC-COOLANT-THRU		
Part Number	Size	Collapse Range
-	2.0mm	-
-	3.0mm	-
-	3.5mm	-
-	4.0mm	-
-	4.5mm	-
E20-196(C)	5.0mm	5.0mm - 4.5mm
E20-216(C)	5.5mm	5.5mm - 5.0mm
E20-236(C)	6.0mm	6.0mm - 5.5mm
E20-255(C)	6.5mm	6.5mm - 6.0mm
E20-275(C)	7.0mm	7.0mm - 6.5mm
E20-295(C)	7.5mm	7.5mm - 7.0mm
E20-314(C)	8.0mm	8.0mm - 7.5mm
E20-334(C)	8.5mm	8.5mm - 8.0mm
E20-354(C)	9.0mm	9.0mm - 8.5mm
E20-374(C)	9.5mm	9.5mm - 9.0mm
E20-393(C)	10.0mm	10.0mm - 9.5mm
E20-413(C)	10.5mm	10.5mm - 10.0mm
E20-433(C)	11.0mm	11.0mm - 10.5mm
E20-452(C)	11.5mm	11.5mm - 11.0mm
E20-472(C)	12.0mm	12.0mm - 11.5mm
E20-492(C)	12.5mm	12.5mm - 12.0mm
E20-511(C)	13.0mm	13.0mm - 12.5mm

## ER20 Collets Sets

E20-15S	15 Piece Set 1/16" - 1/2" by 32nds
E20-11S	11 Piece Set 2.0mm - 13.0mm by 1mm

## ER20 Coolant Collets Sets

E20-12S(C)	12 Piece Set 5/32" - 1/2" by 32nds
E20-17S(C)	17 Piece Set 5.0mm - 13.0mm by 0.5mm

See dimensional data for ER20 Collets on page 31.

## ER25 Collets



Size range: 1/16" - 5/8"

INCH		
Part Number	Size	Collapse Range
E25-004	1/16"	.063" - .047"
E25-006	3/32"	.094" - .078"
E25-008	1/8"	.125" - .109"
E25-010	5/32"	.156" - .125"
E25-012	3/16"	.187" - .156"
E25-014	7/32"	.218" - .187"
-	15/64"	-
E25-016	1/4"	.250" - .219"
-	17/64"	-
E25-018	9/32"	.281" - .250"
-	19/64"	-
E25-020	5/16"	.312" - .281"
-	21/64"	-
E25-022	11/32"	.344" - .312"
-	23/64"	-
E25-024	3/8"	.375" - .344"
-	25/64"	-
E25-026	13/32"	.406" - .375"
-	27/64"	-
E25-028	7/16"	.437" - .406"
-	29/64"	-
E25-030	15/32"	.469" - .437"
-	31/64"	-
E25-032	1/2"	.500" - .469"
-	33/64"	-
E25-034	17/32"	.531" - .500"
-	35/64"	-
E25-036	9/16"	.563" - .531"
-	37/64"	-
E25-038	19/32"	.594" - .563"
-	39/64"	-
E25-040	5/8"	.625" - .594"

Size range: 2.0mm - 16.0mm  
(0.039"-0.629")

METRIC		
Part Number	Size	Collapse Range
E25-078	2.0mm	2.0-1.0mm
E25-118	3.0mm	3.0-2.0mm
E25-137	3.5mm	3.5-2.5mm
E25-157	4.0mm	4.0-3.0mm
E25-196	5.0mm	5.0-4.0mm
E25-236	6.0mm	6.0-5.0mm
E25-275	7.0mm	7.0-6.0mm
E25-314	8.0mm	8.0-7.0mm
E25-354	9.0mm	9.0-8.0 mm
E25-393	10.0mm	10.0-9.0mm
E25-433	11.0mm	11.0-10.0mm
E25-452	11.5mm	11.5-11.0mm
E25-472	12.0mm	12.0-11.0mm
E25-511	13.0mm	13.0-12.0mm
E25-551	14.0mm	14.0-13.0mm
E25-590	15.0mm	15.0-14.0mm
E25-629	16.0mm	16.0-15.0mm



Size range: 7/32" - 5/8"

INCH-COOLANT-THRU		
Part Number	Size	Collapse Range
-	1/16"	-
-	3/32"	-
-	1/8"	-
-	5/32"	-
-	3/16"	-
E25-014(C)	7/32"	.219" - .203"
E25-015(C)	15/64"	.234" - .219"
E25-016(C)	1/4"	.250" - .234"
E25-017(C)	17/64"	.266" - .250"
E25-018(C)	9/32"	.281" - .266"
E25-019(C)	19/64"	.297" - .281"
E25-020(C)	5/16"	.312" - .297"
E25-021(C)	21/64"	.328" - .312"
E25-022(C)	11/32"	.344" - .328"
E25-023(C)	23/64"	.359" - .344"
E25-024(C)	3/8"	.375" - .359"
E25-025(C)	25/64"	.391" - .375"
E25-026(C)	13/32"	.406" - .391"
E25-027(C)	27/64"	.422" - .406"
E25-028(C)	7/16"	.437" - .422"
E25-029(C)	29/64"	.453" - .437"
E25-030(C)	15/32"	.469" - .453"
E25-031(C)	31/64"	.484" - .469"
E25-032(C)	1/2"	.500" - .484"
E25-033(C)	33/64"	.516" - .500"
E25-034(C)	17/32"	.531" - .516"
E25-035(C)	35/64"	.547" - .531"
E25-036(C)	9/16"	.563" - .547"
E25-037(C)	37/64"	.578" - .563"
E25-038(C)	19/32"	.594" - .578"
E25-039(C)	39/64"	.609" - .594"
E25-040(C)	5/8"	.625" - .609"

Our patented Coolant Collets are designed for use with cylindrical shank tools (no flats). Cutting tool should be inserted the full length of the collet. If these conditions are not met, coolant leakage may result. Seals up to maximum coolant pressure of 1000PSI.

Size range: 6.0mm-16.0mm  
(0.236"-0.629")

METRIC-COOLANT-THRU		
Part Number	Size	Collapse Range
-	2.0mm	-
-	3.0mm	-
-	3.5mm	-
-	4.0mm	-
-	5.0mm	-
E25-236(C)	6.0mm	6.0mm - 5.5mm
E25-255(C)	6.5mm	6.5mm - 6.0mm
E25-275(C)	7.0mm	7.0mm - 6.5mm
E25-295(C)	7.5mm	7.5mm - 7.0mm
E25-314(C)	8.0mm	8.0mm - 7.5mm
E25-334(C)	8.5mm	8.5mm - 8.0mm
E25-354(C)	9.0mm	9.0mm - 8.5mm
E25-374(C)	9.5mm	9.5mm - 9.0mm
E25-393(C)	10.0mm	10.0mm - 9.5mm
E25-413(C)	10.5mm	10.5mm - 10.0mm
E25-433(C)	11.0mm	11.0mm - 10.5mm
E25-452(C)	11.5mm	11.5mm - 11.0mm
E25-472(C)	12.0mm	12.0mm - 11.5mm
E25-492(C)	12.5mm	12.5mm - 12.0mm
E25-511(C)	13.0mm	13.0mm - 12.5mm
E25-531(C)	13.5mm	13.5mm - 13.0mm
E25-551(C)	14.0mm	14.0mm - 13.5mm
E25-570(C)	14.5mm	14.5mm - 14.0mm
E25-590(C)	15.0mm	15.0mm - 14.5mm
E25-610(C)	15.5mm	15.5mm - 15.0mm
E25-629(C)	16.0mm	16.0mm - 15.5mm

### ER25 Collets Sets

E25-19S	19 Piece Set 1/16" - 5/8" by 32nds
E25-14S	14 Piece Set 2.0mm - 16.0mm by 1mm

### ER25 Coolant Collets Sets

E25-13S(C)	13 Piece Set 1/4" - 5/8" by 32nds
E25-21S(C)	21 Piece Set 6.0mm - 16.0mm by 0.5mm

See dimensional data for ER25 Collets on page 31.



# ER32 Collets



Size range: 1/8" - 25/32"



Size range: 1/4" - 25/32"

Our patented Coolant Collets are designed for use with cylindrical shank tools (no flats). Cutting tool should be inserted the full length of the collet. If these conditions are not met, coolant leakage may result. Seals up to maximum coolant pressure of 1000PSI.

Size range: 10.0mm-20.0mm  
(0.276"-0.787")

INCH		
Part Number	Size	Collapse Range
-	-	-
E32-008	1/8"	.125" - .109"
E32-010	5/32"	.156" - .125"
E32-012	3/16"	.187" - .156"
E32-014	7/32"	.219" - .187"
E32-016	1/4"	.250" - .219"
-	17/64"	-
E32-018	9/32"	.281" - .250"
-	19/64"	-
E32-020	5/16"	.312" - .281"
-	21/64"	-
E32-022	11/32"	.344" - .312"
-	23/64"	-
E32-024	3/8"	.375" - .344"
-	25/64"	-
E32-026	13/32"	.406" - .375"
-	27/64"	-
E32-028	7/16"	.437" - .406"
-	29/64"	-
E32-030	15/32"	.469" - .437"
-	31/64"	-
E32-032	1/2"	.500" - .469"
-	33/64"	-
E32-034	17/32"	.531" - .500"
-	35/64"	-
E32-036	9/16"	.594" - .563"
-	37/64"	-
E32-038	19/32"	.594" - .562"
-	39/64"	-
E32-040	5/8"	.625" - .594"
-	41/64"	-
E32-042	21/32"	.688" - .656"
-	43/64"	-
E32-044	11/16"	.719" - .688"
-	45/64"	-
E32-046	23/32"	.719" - .687"
-	47/64"	-
E32-048	3/4"	.750" - .719"
-	49/64"	-
E32-050	25/32"	.781" - .750"

METRIC		
Part Number	Size	Collapse Range
E32-118	3.0mm	3.0-2.0mm
E32-137	3.5mm	3.5-2.5mm
E32-157	4.0mm	4.0-3.0mm
E32-196	5.0mm	5.0-4.0mm
E32-236	6.0mm	6.0-5.0mm
E32-275	7.0mm	7.0-6.0mm
E32-314	8.0mm	8.0-7.0mm
E32-354	9.0mm	9.0-8.0mm
E32-393	10.0mm	10.0-9.0mm
E32-433	11.0mm	11.0-10.0mm
E32-452	11.5mm	11.5-10.5mm
E32-472	12.0mm	12.0-11.0mm
E32-511	13.0mm	13.0-12.0mm
E32-551	14.0mm	14.0-13.0mm
E32-590	15.0mm	15.0-14.0mm
E32-629	16.0mm	16.0-15.0mm
E32-669	17.0mm	17.0-16.0mm
E32-708	18.0mm	18.0-17.0mm
E32-748	19.0mm	19.0-18.0mm
E32-767	19.5mm	19.5-18.5mm
E32-787	20.0mm	20.0-19.0mm

INCH-COOLANT-THRU		
Part Number	Size	Collapse Range
-	-	-
-	1/8"	-
-	5/32"	-
-	3/6"	-
-	7/32"	-
E32-016(C)	1/4"	.250" - .234"
E32-017(C)	17/64"	.266" - .250"
E32-018(C)	9/32"	.281" - .266"
E32-019(C)	19/64"	.297" - .281"
E32-020(C)	5/16"	.312" - .297"
E32-021(C)	21/64"	.328" - .312"
E32-022(C)	11/32"	.344" - .328"
E32-023(C)	23/64"	.359" - .344"
E32-024(C)	3/8"	.375" - .359"
E32-025(C)	25/64"	.391" - .375"
E32-026(C)	13/32"	.406" - .391"
E32-027(C)	27/64"	.422" - .406"
E32-028(C)	7/16"	.437" - .422"
E32-029(C)	29/64"	.453" - .437"
E32-030(C)	15/32"	.469" - .453"
E32-031(C)	31/64"	.484" - .469"
E32-032(C)	1/2"	.500" - .484"
E32-033(C)	33/64"	.516" - .500"
E32-034(C)	17/32"	.531" - .516"
E32-035(C)	35/64"	.547" - .531"
E32-036(C)	9/16"	.563" - .547"
E32-037(C)	37/64"	.578" - .563"
E32-038(C)	19/32"	.594" - .578"
E32-039(C)	39/64"	.609" - .594"
E32-040(C)	5/8"	.625" - .609"
E32-041(C)	41/64"	.641" - .625"
E32-042(C)	21/32"	.656" - .641"
E32-043(C)	43/64"	.672" - .656"
E32-044(C)	11/16"	.688" - .672"
E32-045(C)	45/64"	.703" - .688"
E32-046(C)	23/32"	.719" - .703"
E32-047(C)	47/64"	.734" - .719"
E32-048(C)	3/4"	.750" - .734"
E32-049(C)	49/64"	.766" - .750"
E32-050(C)	25/32"	.781" - .766"

METRIC-COOLANT-THRU		
Part Number	Size	Collapse Range
-	3.0mm	-
-	3.5mm	-
-	4.0mm	-
-	5.0mm	-
-	6.0mm	-
-	7.0mm	-
-	8.0mm	-
-	9.0mm	-
E32-393(C)	10.0mm	10.0mm - 9.5mm
E32-413(C)	10.5mm	10.5mm - 10.0mm
E32-433(C)	11.0mm	11.0mm - 10.5mm
E32-452(C)	11.5mm	11.5mm - 11.0mm
E32-472(C)	12.0mm	12.0mm - 11.5mm
E32-492(C)	12.5mm	12.5mm - 12.4mm
E32-511(C)	13.0mm	13.0mm - 12.9mm
E32-531(C)	13.5mm	13.5mm - 13.0mm
E32-551(C)	14.0mm	14.0mm - 13.5mm
E32-570(C)	14.5mm	14.5mm - 14.4mm
E32-590(C)	15.0mm	15.0mm - 14.9mm
E32-610(C)	15.5mm	15.5mm - 15.4mm
E32-629(C)	16.0mm	16.0mm - 15.5mm
E32-649(C)	16.5mm	16.5mm - 16.0mm
E32-669(C)	17.0mm	17.0mm - 16.5mm
E32-688(C)	17.5mm	17.5mm - 17.0mm
E32-708(C)	18.0mm	18.0mm - 17.5mm
E32-728(C)	18.5mm	18.5mm - 18.0mm
E32-748(C)	19.0mm	19.0mm - 18.5mm
E32-767(C)	19.5mm	19.5mm - 19.0mm
E32-787(C)	20.0mm	20.0mm - 19.5mm

## ER32 Collets Sets

E32-21S	21 Piece Set	1/8" - 3/4" by 32nds
E32-18S	18 Piece Set	2.0mm - 20.0mm by 1.0mm

## ER32 Coolant Collets Sets

E32-17S(C)	17 Piece Set	1/4" - 3/4" by 32nds
E32-21S(C)	21 Piece Set	10.0mm - 20.0mm by 0.5mm

See dimensional data for ER32 Collets on page 31.

## ER40 Collets



Size range: 5/32" - 1"



Size range: 5/16" - 5/8"

Our patented Coolant Collets are designed for use with cylindrical shank tools (no flats). Cutting tool should be inserted the full length of the collet. If these conditions are not met, coolant leakage may result. Seals up to maximum coolant pressure of 1000PSI.

Size range: 10.0mm - 26.0mm  
(0.374" - 1.023")

INCH		
Part Number	Size	Collapse Range
E40-010	5/32"	.156" - .125"
E40-012	3/16"	.187" - .156"
E40-014	7/32"	.219" - .187"
E40-016	1/4"	.250" - .219"
E40-018	9/32"	.281" - .250"
E40-020	5/16"	.312" - .281"
E40-022	11/32"	.344" - .312"
E40-024	3/8"	.375" - .344"
E40-026	13/32"	.406" - .375"
E40-028	7/16"	.437" - .406"
E40-030	15/32"	.469" - .437"
E40-032	1/2"	.500" - .469"
E40-034	17/32"	.531" - .500"
E40-036	9/16"	.563" - .531"
E40-038	19/32"	.594" - .563"
E40-040	5/8"	.625" - .594"
E40-042	21/32"	.656" - .625"
E40-044	11/16"	.688" - .656"
E40-046	23/32"	.719" - .688"
E40-048	3/4"	.750" - .719"
E40-050	25/32"	.781" - .750"
E40-052	13/16"	.813" - .781"
E40-054	27/32"	.844" - .813"
E40-056	7/8"	.875" - .844"
E40-058	29/32"	.906" - .875"
E40-060	15/16"	.938" - .906"
E40-062	31/32"	.969" - .938"
E40-064	1"	1" - .969"

METRIC		
Part Number	Size	Collapse Range
E40-157	4.0mm	4.0-3.0mm
E40-196	5.0mm	5.0-4.0mm
E40-236	6.0mm	6.0-5.0mm
E40-275	7.0mm	7.0-6.0mm
E40-314	8.0mm	8.0-7.0mm
E40-354	9.0mm	9.0-8.0 mm
E40-393	10.0mm	10.0-9.0mm
E40-433	11.0mm	11.0-10.0mm
E40-452	11.5mm	11.5-10.5mm
E40-472	12.0mm	12.0-11.0mm
E40-511	13.0mm	13.0-12.0mm
E40-551	14.0mm	14.0-13.0mm
E40-590	15.0mm	15.0-14.0mm
E40-629	16.0mm	16.0-15.0mm
E40-669	17.0mm	17.0-16.0mm
E40-708	18.0mm	18.0-17.0mm
E40-748	19.0mm	19.0-18.0mm
E40-767	19.5mm	19.5-18.5mm
E40-787	20.0mm	20.0-19.0mm
E40-826	21.0mm	21.0-20.0mm
E40-866	22.0mm	22.0-21.0mm
E40-905	23.0mm	23.0-22.0mm
E40-944	24.0mm	24.0-23.0mm
E40-984	25.0mm	25.0-24.0mm
E40-1023	26.0mm	26.0-25.0mm

INCH-COOLANT-THRU		
Part Number	Size	Collapse Range
-	-	-
-	-	-
-	-	-
-	-	-
-	-	-
E40-020(C)	5/16"	.312" - .297"
-	-	-
E40-024(C)	3/8"	.375" - .359"
-	-	-
E40-028(C)	7/16"	.437" - .422"
-	-	-
E40-032(C)	1/2"	.500" - .484"
-	-	-
E40-036(C)	9/16"	.563" - .547"
-	-	-
E40-040(C)	5/8"	.625" - .609"

METRIC-COOLANT-THRU		
Part Number	Size	Collapse Range
-	4.0mm	-
-	5.0mm	-
-	6.0mm	-
-	7.0mm	-
-	8.0mm	-
-	9.0mm	-
E40-393(C)	10.0mm	10.0mm - 9.5mm
E40-413(C)	10.5mm	10.5mm - 10.0mm
E40-433(C)	11.0mm	11.0mm - 10.5mm
E40-452(C)	11.5mm	11.5mm - 11.0mm
E40-472(C)	12.0mm	12.0mm - 11.5mm
E40-492(C)	12.5mm	12.5mm - 12.0mm
E40-511(C)	13.0mm	13.0mm - 12.5mm
E40-531(C)	13.5mm	13.5mm - 13.0mm
E40-551(C)	14.0mm	14.0mm - 13.5mm
E40-570(C)	14.5mm	14.5mm - 14.0mm
E40-590(C)	15.0mm	15.0mm - 14.5mm
E40-610(C)	15.5mm	15.5mm - 15.0mm
E40-629(C)	16.0mm	16.0mm - 15.5mm
E40-649(C)	16.5mm	16.5mm - 16.0mm
E40-669(C)	17.0mm	17.0mm - 16.5mm
E40-688(C)	17.5mm	17.5mm - 17.0mm
E40-708(C)	18.0mm	18.0mm - 17.5mm
E40-728(C)	18.5mm	18.5mm - 18.0mm
E40-748(C)	19.0mm	19.0mm - 18.5mm
E40-767(C)	19.5mm	19.5mm - 19.0mm
E40-787(C)	20.0mm	20.0mm - 19.5mm
E40-807(C)	20.5mm	20.5mm - 20.0mm
E40-826(C)	21.0mm	21.0mm - 20.5mm
E40-846(C)	21.5mm	21.5mm - 21.0mm
E40-866(C)	22.0mm	22.0mm - 21.5mm
E40-885(C)	22.5mm	22.5mm - 22.0mm
E40-905(C)	23.0mm	23.0mm - 22.5mm
E40-925(C)	23.5mm	23.5mm - 23.0mm
E40-944(C)	24.0mm	24.0mm - 23.5mm
E40-964(C)	24.5mm	24.5mm - 24.0mm
E40-984(C)	25.0mm	25.0mm - 24.5mm
E40-1003(C)	25.5mm	25.5mm - 25.0mm
E40-1023(C)	26.0mm	26.0mm - 25.0mm

### ER40 Collets Sets

E40-25S	25 Piece Set	1/4" - 1" by 32nds
E40-23S	23 Piece Set	4.0mm - 26.0mm by 1.0mm

### ER40 Coolant Collets Sets

E40-33S(C)	33 Piece Set	10.0mm - 26.0mm by 0.5mm
------------	--------------	--------------------------

See dimensional data for ER40 Collets on page 31.