

# ER COLLET CHUCKS



ER COLLET CHUCKS



ER COLLET CHUCKS



## ER COLLET CHUCK FEATURES

### LYNDEX-NIKKEN

#### AT3 or better taper tolerance

- All 40 taper tool angles are manufactured within +/- .0011 degrees angular tolerance
- Largest diameter of taper (where rigidity is established) is held within +/- 80 millionths (.00008")
- Precision ground taper ensures 80% or better taper contact

Drive key depth balanced for high speed rotation.

Body of Collet Chuck equal in diameter to the nut diameter. Thicker diameter and wall thickness results in stronger rigidity.

Reduced gap size to prevent bird nests and other stringy chips from packing in or wrapping about.

#### ER Nut

Smooth nut prevents coolant flare and provides better balance.

#### Bearing Nut

Bearing nut improves gripping force and accuracy by reducing the friction between nut and collet.



#### Nickel Chrome Molybdenum Alloy

Lyndex-Nikken toolholders are heat treated in house to a hardness between 55 to 58 Rc under the highest quality standard, ensuring a homogeneous martensite (needle-shaped) crystalline structure. The additional heat treatment process allows for a better ground surface finish and stress stability of the toolholder.

### OTHER

#### AT4 taper tolerance

- All 40 taper tool angles are manufactured within +/- .0018 degrees angular tolerance
- Largest diameter of taper (where rigidity is established) varies within +/- 138 millionths (.00014")
- Varying aspects of taper angle and diameter can only ensure up to 60% taper contact

Recessed collet chuck body diameter weakens rigidity of holder.

Large Hex nut body design flares coolant away from toolholder.



#### High Carbon Steel

Other toolholders are commonly not heat treated thoroughly in order to reduce production costs, resulting in austenite deposits. Surface finish and material integrity are compromised commonly masked by chrome plating or polishing.

# ER COLLET CHUCKS



## ER COLLET FEATURES

We offer the largest ER Collet product range in the industry



### Quality Standard

Made to DIN 6499 Specification

### Material

High Tensile Chromium Molybdenum Alloy provides greater hardness and less material deformation compared to traditional spring steel collets

### T.I.R Accuracy

ID Bore Diameter Ød (mm)	L (mm)	T.I.R. Accuracy Standard Collet
1 - 1.5	4 x Ød	10µ
2 - 5.5	4 x Ød	
6 - 10	25	
11 - 26	40	

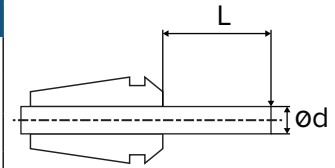

### ER COLLET

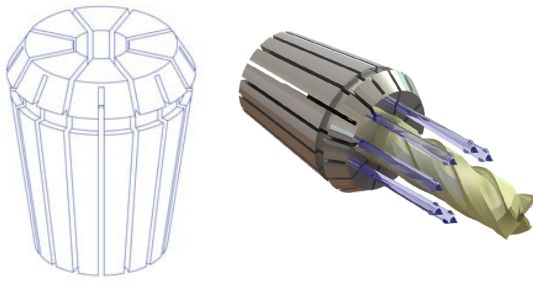

### Inspection

100% collet inspection, checked 3 times for concentricity

### ER STANDARD TYPE COLLET

#### Flexibility and Durability:

Our ER Collets offer wide clamping range, ultra precision, and high pressure coolant capable up to 2900 psi (20MPa).

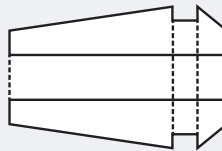

### ER COOLANT COLLET

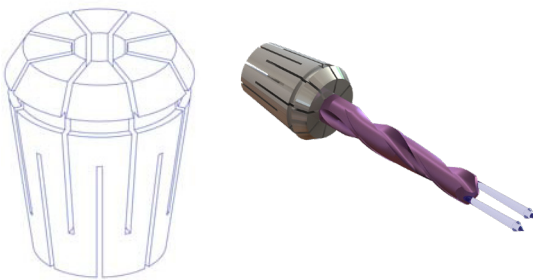

### HIGH PRECISION ER TAP COLLET

#### Extreme rigidity, high pressure performance:

Our Tap Collets are designed for all ANSI, DIN, ISO, and JIS Specification Taps. 2900 psi capable Coolant Tap Collets increase tool life by dissipating heat and preventing chip build-up.

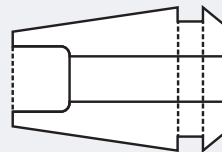

## ER COLLET DIMENSIONAL DATA

Style	D	D1	L	Collet Range	Coolant Collet Size Range
ER8	0.330"	0.216"	0.535"	0.019 - 0.196"	N/A
ER11	0.460"	0.307"	0.709"	0.019 - 0.275"	0.157 - 0.275"
ER16	0.677"	0.445"	1.063"	0.019 - 0.393"	0.157 - 0.393"
ER20	0.835"	0.571"	1.220"	0.039 - 0.511"	0.196 - 0.511"
ER25	1.031"	0.728"	1.378"	0.039 - 0.629"	0.236 - 0.629"
ER32	1.307"	0.960"	1.575"	0.078 - 0.787"	0.393 - 0.787"
ER40	1.622"	1.228"	1.811"	0.118 - 1.023"	0.393 - 1.023"

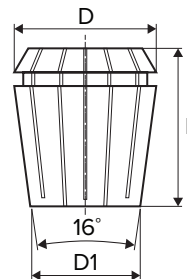

## NUT FEATURES

### LYNDEX-NIKKEN NUT

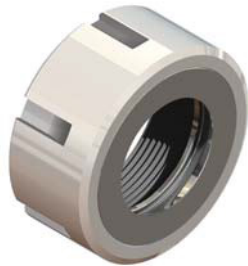

### OTHER NUT

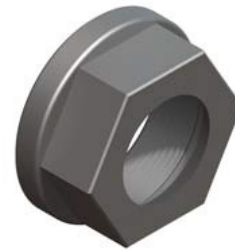

### BEARING NUT



Bearing nuts come as a standard on all of our ER Collet Chucks:

- Reduce twisting of the collet and increase T.I.R. accuracy.
- Improve chucking consistency compared to non bearing style nut!

### STANDARD NUT - NO BEARING



Non bearing style nuts only provide the ability to retain the collet, and do not carry a functional advantage to improve the T.I.R. or chucking consistency.

### MAXIMUM ACCURACY

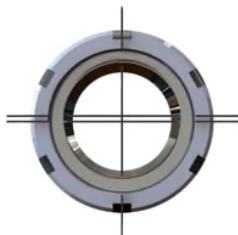

We control all of our manufacturing processes, thereby maintaining the assembly accuracy tolerances between the nut, collet, and holder.

Our ground eccentric bearing race makes set up extremely easy, and ensures the accurate concentric placement of the collet.

### OTHER MANUFACTURERS

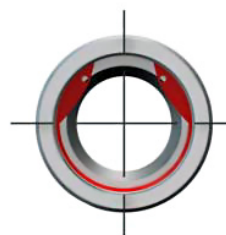

Other manufacturers use a commercial snap ring as a retainer for the collet. This can contribute to minor misalignment between the nut, collet, and holder.

### GROUND ECCENTRIC NUT

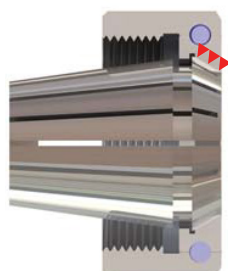

Our ground eccentric bearing race increases clamping power compared to standard nuts! It also prevents galling and twisting between the collet angle contact surface and the nut to minimize runout and greatly assist in alignment of the collet to the holder.

### NO GROUND SURFACE

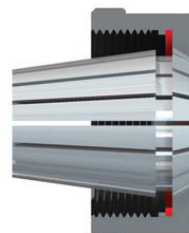

ER Collet without ground contact locations cannot ensure ultra precision due to surface abnormality.

# ER COLLET CHUCKS

## CAT ER COLLET CHUCKS

### FEATURES

- Ball bearing nut with ground collet race
- AT3 or better taper
- Equipped with a right-hand-threaded back-up screw



**T.I.R.**  
≤ 0.0001" in ID bore



**Speed**  
Up to 25,000 rpm



**Coolant-Thru**  
Thru-tool coolant

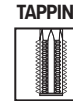

Please note that the maximum RPM listed in our catalog may vary depending on the toolholder shank, weight, balanceability and the G rating.

### CAT40 - BEARING NUT

Part Number	Collet Size	Collet Range	Nut Wrench	L	L1	L2	D	D1	Max. RPM	Fig.
<a href="#">C4007-0008-2.50</a>	ER8	0.019 - 0.197"	WRENCH-ER08-MINI	2.50"	1.11"	-	0.47"	1.75"	25K	2
<a href="#">C4007-0008-4.00M</a>	ER8	0.019 - 0.197"	WRENCH-ER08-MINI	4.00"	2.61"	-	0.47"	1.75"	25K	2
<a href="#">C4007-0011-2.50</a>	ER11	0.019 - 0.275"	011-HEX	2.50"	1.12"	-	0.75"	1.75"	25K	2
<a href="#">C4007-0011-4.00</a>	ER11	0.019 - 0.275"	011-HEX	4.00"	2.62"	-	0.75"	1.75"	25K	2
<a href="#">C4007-0011-6.00</a>	ER11	0.019 - 0.275"	011-HEX	6.00"	4.62"	-	0.75"	1.75"	25K	2
<a href="#">C4007-0016-2.25</a>	ER16	0.019 - 0.406"	016-SPAN	2.25"	1.50"	-	1.26"	-	25K	1
<a href="#">C4007-0016-3.50</a>	ER16	0.019 - 0.406"	016-SPAN	3.50"	2.11"	-	1.26"	1.75"	25K	2
<a href="#">C4007-0016-6.00</a>	ER16	0.019 - 0.406"	016-SPAN	6.00"	4.63"	-	1.26"	1.75"	25K	2
<a href="#">C4007-0016-9.00</a>	ER16	0.019 - 0.406"	016-SPAN	9.00"	1.65"	7.64"	1.26"	1.75"	25K	3
<a href="#">C4007-0020-2.50</a>	ER20	0.039 - 0.511"	020-SPAN	2.50"	1.12"	-	1.38"	1.75"	25K	2
<a href="#">C4007-0020-4.00</a>	ER20	0.039 - 0.511"	020-SPAN	4.00"	2.60"	-	1.38"	1.75"	25K	2
<a href="#">C4007-0020-6.00</a>	ER20	0.039 - 0.511"	020-SPAN	6.00"	4.62"	-	1.38"	1.75"	25K	2
<a href="#">C4007-0020-9.00</a>	ER20	0.039 - 0.511"	020-SPAN	9.00"	1.71"	7.63"	1.38"	1.75"	25K	3
<a href="#">C4007-0025-2.50</a>	ER25	0.039 - 0.629"	025-SPAN	2.50"	1.14"	-	1.65"	1.75"	25K	2
<a href="#">C4007-0025-4.00</a>	ER25	0.039 - 0.629"	025-SPAN	4.00"	2.62"	-	1.65"	1.75"	25K	2
<a href="#">C4007-0025-6.00</a>	ER25	0.039 - 0.629"	025-SPAN	6.00"	4.62"	-	1.65"	1.75"	25K	2
<a href="#">C4007-0032-0.76</a>	ER32	0.078 - 0.787"	WRENCH-ER32I	0.76"	0.14"	-	1.58"	-	25K	1
<a href="#">C4007-0032-3.13</a>	ER32	0.078 - 0.787"	032-SPAN	3.13"	2.38"	-	1.97"	-	25K	1
<a href="#">C4007-0032-5.00</a>	ER32	0.078 - 0.787"	032-SPAN	5.00"	4.29"	-	1.97"	-	25K	1
<a href="#">C4007-0032-9.00</a>	ER32	0.078 - 0.787"	032-SPAN	9.00"	1.74"	7.63"	1.97"	1.75"	25K	3
<a href="#">C4007-0040-3.13</a>	ER40	0.118 - 1.023"	040-SPAN	3.13"	2.37"	-	2.44"	-	25K	1
<a href="#">C4007-0040-5.00</a>	ER40	0.118 - 1.023"	040-SPAN	5.00"	4.26"	-	2.44"	-	25K	1

#### Notes:

- Back-up Screw included with ER Collet Chuck.
- \*For Extended Length holders, "L" dimension has tapered length.  
To confirm clearance, please download model/drawing from our website



Available in **TAPER PLUS<sup>+</sup>**  
Dual-taper and flange contact

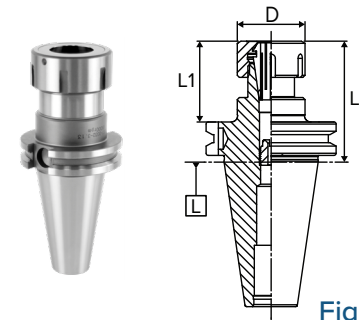

Fig. 1

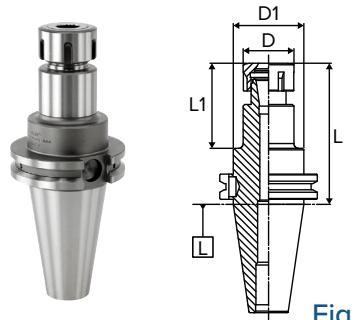

Fig. 2

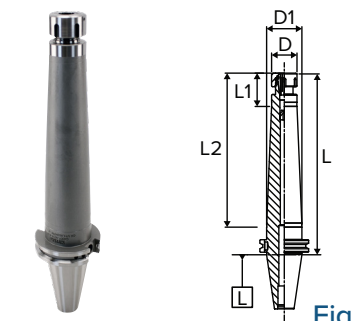

Fig. 3

ER Collet Chucks have coolant-thru capabilities. No disc, special nut or wrench required!

See ER Coolant Collets on pages 65-70



## CAT ER COLLET CHUCKS

### FEATURES

- Ball bearing nut with ground collet race
- AT3 or better taper
- Equipped with a right-hand-threaded back-up screw



**T.I.R.**  
≤ 0.0001" in ID bore



**Speed**  
Up to 25,000 rpm



**Coolant-Thru**  
Thru-tool coolant

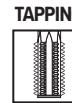

Please note that the maximum RPM listed in our catalog may vary depending on the toolholder shank, weight, balanceability and the G rating.

### CAT40 - SOLID HEX NUT

Part Number	Collet Size	Collet Range	Nut Wrench	L	L1	D	D1	Max. RPM	Fig.
<a href="#">CAT40-ER16-2.76</a>	ER16	0.019 - 0.406"	016-SPAN	2.76"	1.38"	1.10"	1.75"	25K	1
<a href="#">CAT40-ER16-4.00</a>	ER16	0.019 - 0.406"	016-SPAN	4.00"	2.62"	1.10"	1.75"	25K	1
<a href="#">CAT40-ER16-6.00</a>	ER16	0.019 - 0.406"	016-SPAN	6.00"	4.62"	1.10"	1.75"	25K	1
<a href="#">CAT40-ER16-8.00</a>	ER16	0.019 - 0.406"	016-SPAN	8.00"	6.62"	1.10"	1.75"	25K	1

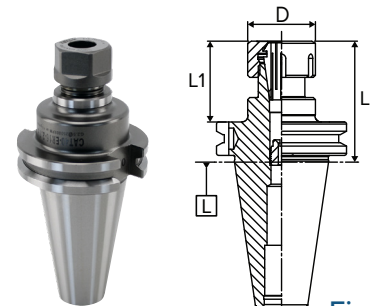

Fig. 1

### CAT40 - SOLID NUT

Part Number	Collet Size	Collet Range	Nut Wrench	L	L1	D	D1	Max. RPM	Fig.
<a href="#">CAT40-ER20-2.76</a>	ER20	0.039 - 0.511"	020-SPAN	2.76"	1.38"	1.34"	1.75"	25K	1
<a href="#">CAT40-ER20-4.00</a>	ER20	0.039 - 0.511"	020-SPAN	4.00"	2.66"	1.34"	1.75"	25K	1
<a href="#">CAT40-ER20-6.00</a>	ER20	0.039 - 0.511"	020-SPAN	6.00"	4.66"	1.34"	1.75"	25K	1
<a href="#">CAT40-ER20-8.00</a>	ER20	0.039 - 0.511"	020-SPAN	8.00"	6.66"	1.34"	1.75"	25K	1
<a href="#">CAT40-ER25-2.76</a>	ER25	0.039 - 0.629"	025-SPAN	2.76"	1.38"	1.66"	1.75"	25K	1
<a href="#">CAT40-ER25-4.00</a>	ER25	0.039 - 0.629"	025-SPAN	4.00"	2.62"	1.66"	1.75"	25K	1
<a href="#">CAT40-ER25-6.00</a>	ER25	0.039 - 0.629"	025-SPAN	6.00"	4.62"	1.66"	1.75"	25K	1
<a href="#">CAT40-ER25-8.00</a>	ER25	0.039 - 0.629"	025-SPAN	8.00"	6.62"	1.66"	1.75"	25K	1
<a href="#">CAT40-ER32-2.76</a>	ER32	0.078 - 0.787"	032-SPAN	2.76"	2.01"	1.97"	-	25K	2
<a href="#">CAT40-ER32-4.00</a>	ER32	0.078 - 0.787"	032-SPAN	4.00"	3.25"	1.97"	-	25K	2
<a href="#">CAT40-ER32-6.00</a>	ER32	0.078 - 0.787"	032-SPAN	6.00"	5.25"	1.97"	-	25K	2
<a href="#">CAT40-ER32-8.00</a>	ER32	0.078 - 0.787"	032-SPAN	8.00"	7.25"	1.97"	-	25K	2
<a href="#">CAT40-ER40-3.15</a>	ER40	0.118 - 1.023"	040-SPAN	3.15"	2.41"	2.48"	-	25K	2
<a href="#">CAT40-ER40-4.00</a>	ER40	0.118 - 1.023"	040-SPAN	4.00"	3.25"	2.48"	-	25K	2
<a href="#">CAT40-ER40-6.00</a>	ER40	0.118 - 1.023"	040-SPAN	6.00"	5.25"	2.48"	-	25K	2

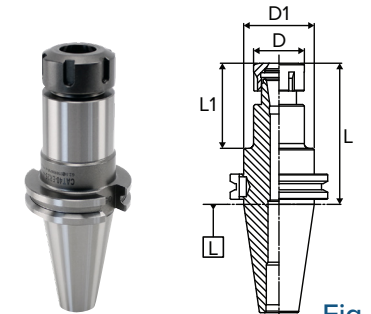

Fig. 2

**Notes:**

- Back-up Screw included with ER Collet Chuck.
- \*For Extended Length holders, "L" dimension has tapered length.  
To confirm clearance, please download model/drawing from our website

Available in **TAPER PLUS+**  
Dual-taper and flange contact

ER Collet Chucks have coolant-thru capabilities. No disc, special nut or wrench required!

See ER Coolant Collets on pages 65-70



# ER COLLET CHUCKS

## CAT ER COLLET CHUCKS

### FEATURES

- Ball bearing nut with ground collet race
- AT3 or better taper
- Equipped with a right-hand-threaded back-up screw



**T.I.R.**  
≤ 0.0001" in ID bore



**Speed**  
Up to 25,000 rpm



**Coolant-Thru**  
Thru-tool coolant

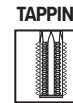

Please note that the maximum RPM listed in our catalog may vary depending on the toolholder shank, weight, balanceability and the G rating.

### CAT50 - BEARING NUT

Part Number	Collet Size	Collet Range	Nut Wrench	L	L1	L2	D	D1	Max. RPM	Fig.
C5007-0016-4.12	ER16	0.019 - 0.406"	016-SPAN	4.12"	2.74"	-	1.26"	2.75"	25K	2
C5007-0016-6.00	ER16	0.019 - 0.406"	016-SPAN	6.00"	4.63"	-	1.26"	2.75"	25K	2
C5007-0016-8.00	ER16	0.019 - 0.406"	016-SPAN	8.00"	1.64"	6.63"	1.26"	2.75"	25K	3
C5007-0016-12.00	ER16	0.019 - 0.406"	016-SPAN	12.00"	1.64"	10.64"	1.26"	2.75"	25K	3
C5007-0020-2.50	ER20	0.039 - 0.511"	020-SPAN	2.50"	1.14"	-	1.38"	2.75"	25K	2
C5007-0020-4.00	ER20	0.039 - 0.511"	020-SPAN	4.00"	2.63"	-	1.38"	2.75"	25K	2
C5007-0020-6.00	ER20	0.039 - 0.511"	020-SPAN	6.00"	4.62"	-	1.38"	2.75"	25K	2
C5007-0020-8.00	ER20	0.039 - 0.511"	020-SPAN	8.00"	1.72"	6.63"	1.38"	2.75"	25K	3
C5007-0020-12.00	ER20	0.039 - 0.511"	020-SPAN	12.00"	1.57"	10.63"	1.38"	2.75"	25K	3
C5007-0025-2.50	ER25	0.039 - 0.629"	025-SPAN	2.50"	1.14"	-	1.65"	2.75"	25K	2
C5007-0025-4.00	ER25	0.039 - 0.629"	025-SPAN	4.00"	2.62"	-	1.65"	2.75"	25K	2
C5007-0025-6.00	ER25	0.039 - 0.629"	025-SPAN	6.00"	4.62"	-	1.65"	2.75"	25K	2
C5007-0025-8.00	ER25	0.039 - 0.629"	025-SPAN	8.00"	1.74"	6.62"	1.65"	2.75"	25K	3
C5007-0032-4.00	ER32	0.078 - 0.787"	032-SPAN	4.00"	2.63"	-	1.97"	2.75"	25K	2
C5007-0032-6.00	ER32	0.078 - 0.787"	032-SPAN	6.00"	4.63"	-	1.97"	2.75"	25K	2
C5007-0032-8.00	ER32	0.078 - 0.787"	032-SPAN	8.00"	1.85"	6.62"	1.97"	2.75"	25K	3
C5007-0032-12.00	ER32	0.078 - 0.787"	032-SPAN	12.00"	1.71"	10.63"	1.97"	2.75"	25K	3
C5007-0040-4.00	ER40	0.118 - 1.023"	040-SPAN	4.00"	2.63"	-	2.44"	2.75"	25K	2
C5007-0040-6.00	ER40	0.118 - 1.023"	040-SPAN	6.00"	4.63"	-	2.44"	2.75"	25K	2
C5007-0040-8.00	ER40	0.118 - 1.023"	040-SPAN	8.00"	1.98"	6.63"	2.44"	2.75"	25K	3
C5007-0040-12.00	ER40	0.118 - 1.023"	040-SPAN	4.00"	1.98"	10.63"	2.44"	2.75"	25K	3

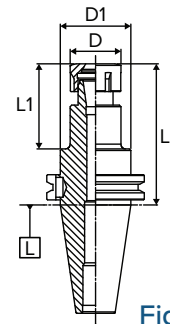

Fig. 2

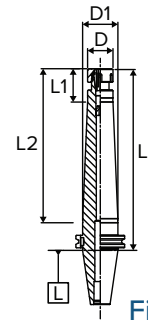

Fig. 3

#### Notes:

- Back-up Screw included with ER Collet Chuck.
- \*For Extended Length holders, "L" dimension has tapered length.  
To confirm clearance, please download model/drawing from our website



Available in **TAPER PLUS<sup>+</sup>**  
Dual-taper and flange contact

ER Collet Chucks have coolant-thru capabilities. No disc, special nut or wrench required!

See ER Coolant Collets on pages 65-70



ER Collets  
Pages 65-70



ER Torque  
Wrenches  
Page 75



ER Back Up  
Screws  
Page 75



ER Nuts  
Page 74

## CAT ER COLLET CHUCKS

### FEATURES

- Ball bearing nut with ground collet race
- AT3 or better taper
- Equipped with a right-hand-threaded back-up screw



**T.I.R.**  
≤ 0.0001" in ID bore



**Speed**  
Up to 25,000 rpm



**Coolant-Thru**  
Thru-tool coolant

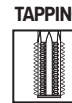

Please note that the maximum RPM listed in our catalog may vary depending on the toolholder shank, weight, balanceability and the G rating.

### CAT50 - SOLID HEX NUT

Part Number	Collet Size	Collet Range	Nut Wrench	L	L1	D	D1	Max. RPM	Fig.
CAT50-ER16-4.00	ER16	0.019 - 0.406"	016-SPAN	4.00"	2.62"	1.10"	2.75"	25K	5
CAT50-ER16-6.00	ER16	0.019 - 0.406"	016-SPAN	6.00"	4.62"	1.10"	2.75"	25K	5
CAT50-ER16-8.00	ER16	0.019 - 0.406"	016-SPAN	8.00"	6.62"	1.10"	2.75"	25K	5

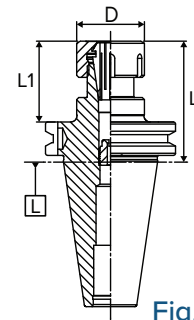

Fig. 4

### CAT50 - SOLID NUT

Part Number	Collet Size	Collet Range	Nut Wrench	L	L1	D	D1	Max. RPM	Fig.
CAT50-ER20-4.00	ER20	0.039 - 0.511"	020-SPAN	4.00"	2.62"	1.34"	2.75"	25K	5
CAT50-ER20-6.00	ER20	0.039 - 0.511"	020-SPAN	6.00"	4.62"	1.34"	2.75"	25K	5
CAT50-ER20-8.00	ER20	0.039 - 0.511"	020-SPAN	8.00"	6.62"	1.34"	2.75"	25K	5
CAT50-ER25-4.00	ER25	0.039 - 0.629"	025-SPAN	4.00"	2.62"	1.66"	2.75"	25K	5
CAT50-ER25-6.00	ER25	0.039 - 0.629"	025-SPAN	6.00"	4.62"	1.66"	2.75"	25K	5
CAT50-ER25-8.00	ER25	0.039 - 0.629"	025-SPAN	8.00"	6.62"	1.66"	2.75"	25K	5
CAT50-ER32-4.00	ER32	0.078 - 0.787"	032-SPAN	4.00"	2.62"	1.97"	2.75"	25K	5
CAT50-ER32-6.00	ER32	0.078 - 0.787"	032-SPAN	6.00"	4.62"	1.97"	2.75"	25K	5
CAT50-ER32-8.00	ER32	0.078 - 0.787"	032-SPAN	8.00"	6.62"	1.97"	2.75"	25K	5
CAT50-ER40-4.00	ER40	0.118 - 1.023"	040-SPAN	4.00"	2.62"	2.48"	2.75"	25K	5
CAT50-ER40-6.00	ER40	0.118 - 1.023"	040-SPAN	6.00"	4.62"	2.48"	2.75"	25K	5
CAT50-ER40-8.00	ER40	0.118 - 1.023"	040-SPAN	8.00"	6.62"	2.48"	2.75"	25K	5
CAT50-ER50-4.00	ER50	0.236 - 1.338"	9HC32	4.00"	3.25"	3.07"	-	25K	4
CAT50-ER50-6.00	ER50	0.236 - 1.338"	9HC32	6.00"	5.25"	3.07"	-	25K	4
CAT50-ER50-8.00	ER50	0.236 - 1.338"	9HC32	8.00"	7.25"	3.07"	-	25K	4

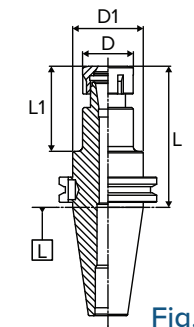

Fig. 5

**Notes:**

- Back-up Screw included with ER Collet Chuck.
- \*For Extended Length holders, "L" dimension has tapered length. To confirm clearance, please download model/drawing from our website



Available in **TAPER PLUS+**  
Dual-taper and flange contact

ER Collet Chucks have coolant-thru capabilities. No disc, special nut or wrench required!  
See ER Coolant Collets on pages 65-70



ER Collets  
Pages 65-70



ER Torque  
Wrenches  
Page 75



ER Back Up  
Screws  
Page 75



ER Nuts  
Page 74

# ER COLLET CHUCKS

## BT ER COLLET CHUCKS

### FEATURES

- Ball bearing nut with ground collet race
- AT3 or better taper
- Equipped with a right-hand-threaded back-up screw



**T.I.R.**  
≤ 0.0001" in ID bore



**Speed**  
Up to 30,000 rpm



**Coolant-Thru**  
Thru-tool coolant

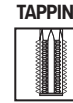

Please note that the maximum RPM listed in our catalog may vary depending on the toolholder shank, weight, balanceability and the G rating.

### BT30 - BEARING NUT

Part Number	Collet Size	Collet Range	Nut Wrench	L	L1	D	Max. RPM	Fig.
B3007-0008-2.00	ER8	0.019 - 0.197"	08-NASPAN	2.00"	1.13"	0.47"	18K	6
B3007-0008-4.00M	ER8	0.019 - 0.197"	WRENCH-ER08-MINI	4.00"	3.13"	0.47"	30K	6
B3007-0011-2.00	ER11	0.019 - 0.275"	011-HEX	2.00"	1.13"	0.75"	30K	6
B3007-0011-4.00	ER11	0.019 - 0.275"	011-HEX	4.00"	3.13"	0.75"	30K	6
B3007-0016-2.36	ER16	0.019 - 0.406"	016-SPAN	2.36"	1.49"	1.26"	30K	6
B3007-0016-4.00	ER16	0.019 - 0.406"	016-SPAN	4.00"	3.13"	1.26"	30K	6
B3007-0016-5.00	ER16	0.019 - 0.406"	016-SPAN	5.00"	4.13"	1.26"	30K	6
B3007-0020-2.50	ER20	0.039 - 0.511"	020-SPAN	2.50"	1.63"	1.38"	30K	6
B3007-0020-4.00	ER20	0.039 - 0.511"	020-SPAN	4.00"	3.13"	1.38"	30K	6
B3007-0025-2.00	ER25	0.039 - 0.629"	025-SPAN	2.00"	1.13"	1.65"	30K	6
B3007-0025-4.00	ER25	0.039 - 0.629"	025-SPAN	4.00"	3.14"	1.65"	30K	6
B3007-0032-3.00	ER32	0.078 - 0.787"	032-SPAN	3.00"	2.13"	1.97"	30K	6
B3007-0032-5.00	ER32	0.078 - 0.787"	032-SPAN	5.00"	4.13"	1.97"	30K	6

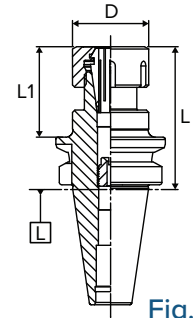

Fig. 6

### BT30 - SOLID HEX NUT

Part Number	Collet Size	Collet Range	Nut Wrench	L (mm)	L	L1	D	Max. RPM	Fig.
BT30-ER16-70	ER16	0.019 - 0.406"	016-SPAN	70	2.76"	1.89"	1.10"	30K	6
BT30-ER16-100	ER16	0.019 - 0.406"	016-SPAN	100	3.94"	3.07"	1.10"	30K	6

### BT30 - SOLID NUT

Part Number	Collet Size	Collet Range	Nut Wrench	L (mm)	L	L1	D	Max. RPM	Fig.
BT30-ER20-63.5	ER20	0.039 - 0.511"	020-SPAN	63.5	2.50"	1.63"	1.34"	30K	6
BT30-ER20-100	ER20	0.039 - 0.511"	020-SPAN	100	3.94"	3.07"	1.34"	30K	6
BT30-ER25-60	ER25	0.039 - 0.629"	025-SPAN	60	2.36"	1.46"	1.65"	30K	6
BT30-ER25-90	ER25	0.039 - 0.629"	025-SPAN	90	3.54"	2.64"	1.65"	30K	6
BT30-ER32-70	ER32	0.078 - 0.787"	032-SPAN	70	2.76"	1.89"	1.97"	30K	6
BT30-ER32-100	ER32	0.078 - 0.787"	032-SPAN	100	3.94"	3.07"	1.97"	30K	6

#### Notes:

- Back-up Screw included with ER Collet Chuck.
- \*For Extended Length holders, "L" dimension has tapered length.  
To confirm clearance, please download model/drawing from our website



Available in **TAPER PLUS<sup>+</sup>**  
Dual-taper and flange contact

ER Collet Chucks have coolant-thru capabilities. No disc, special nut or wrench required!

See ER Coolant Collets on pages 65-70



ER Collets  
Pages 65-70



ER Torque  
Wrenches  
Page 75



ER Back Up  
Screws  
Page 75



ER Nuts  
Page 74

## BT ER COLLET CHUCKS

### FEATURES

- Ball bearing nut with ground collet race
- AT3 or better taper
- Equipped with a right-hand-threaded back-up screw



**T.I.R.**  
≤ 0.0001" in ID bore



**Speed**  
Up to 25,000 rpm



**Coolant-Thru**  
Thru-tool coolant

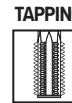

Please note that the maximum RPM listed in our catalog may vary depending on the toolholder shank, weight, balanceability and the G rating.

### BT40 - BEARING NUT

Part Number	Collet Size	Collet Range	Nut Wrench	L	L1	D	Max. RPM	Fig.
B4007-0008-4.00M	ER8	0.019 - 0.275"	WRENCH-ER08-MINI	4.00"	2.94"	0.47"	25K	6
B4007-0011-2.50	ER11	0.019 - 0.275"	011-HEX	2.50"	1.44"	0.75"	25K	6
B4007-0011-4.00	ER11	0.019 - 0.275"	011-HEX	4.00"	2.94"	0.75"	25K	6
B4007-0011-6.00	ER11	0.019 - 0.275"	011-HEX	6.00"	4.95"	0.75"	25K	6
B4007-0016-3.50	ER16	0.019 - 0.406"	016-SPAN	3.50"	2.43"	1.26"	25K	6
B4007-0016-5.00	ER16	0.019 - 0.406"	016-SPAN	5.00"	3.94"	1.26"	25K	6
B4007-0020-2.50	ER20	0.039 - 0.511"	020-SPAN	2.50"	1.43"	1.38"	25K	6
B4007-0020-4.00	ER20	0.039 - 0.511"	020-SPAN	4.00"	2.94"	1.38"	25K	6
B4007-0020-6.00	ER20	0.039 - 0.511"	020-SPAN	6.00"	4.94"	1.38"	25K	6
B4007-0025-2.25	ER25	0.039 - 0.629"	025-SPAN	2.25"	1.19"	1.65"	25K	6
B4007-0025-4.00	ER25	0.039 - 0.629"	025-SPAN	4.00"	2.93"	1.65"	25K	6
B4007-0025-6.00	ER25	0.039 - 0.629"	025-SPAN	6.00"	4.94"	1.65"	25K	6
B4007-0032-3.13	ER32	0.078 - 0.787"	032-SPAN	3.13"	2.06"	1.97"	25K	6
B4007-0032-5.00	ER32	0.078 - 0.787"	032-SPAN	5.00"	3.94"	1.97"	25K	6
B4007-0040-3.13	ER40	0.078 - 0.787"	032-SPAN	3.13"	2.06"	2.44"	25K	6

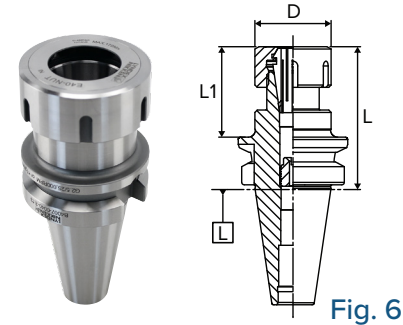

### BT40 - SOLID HEX NUT

Part Number	Collet Size	Collet Range	Nut Wrench	L (mm)	L	L1	D	Max. RPM	Fig.
BT40-ER16-70	ER16	0.019 - 0.406"	016-SPAN	70.000	2.76"	1.69"	1.10"	25K	6
BT40-ER16-100	ER16	0.019 - 0.406"	016-SPAN	100.000	3.94"	2.87"	1.10"	25K	6

### BT40 - SOLID NUT

Part Number	Collet Size	Collet Range	Nut Wrench	L (mm)	L	L1	D	Max. RPM	Fig.
BT40-ER20-70	ER20	0.039 - 0.511"	020-SPAN	70.000	2.76"	1.69"	1.34"	25K	6
BT40-ER20-100	ER20	0.039 - 0.511"	020-SPAN	100.000	3.94"	2.87"	1.34"	25K	6
BT40-ER25-70	ER25	0.039 - 0.629"	025-SPAN	70.000	2.76"	1.69"	1.66"	25K	6
BT40-ER25-100	ER25	0.039 - 0.629"	025-SPAN	100.000	3.94"	2.87"	1.66"	25K	6
BT40-ER32-70	ER32	0.078 - 0.787"	032-SPAN	70.000	2.76"	1.69"	1.97"	25K	6
BT40-ER32-100	ER32	0.078 - 0.787"	032-SPAN	100.000	3.94"	2.87"	1.97"	25K	6

**Notes:**

- Back-up Screw included with ER Collet Chuck.
- \*For Extended Length holders, "L" dimension has tapered length. To confirm clearance, please download model/drawing from our website



Available in **TAPER PLUS+**  
Dual-taper and flange contact

ER Collet Chucks have coolant-thru capabilities. No disc, special nut or wrench required!

See ER Coolant Collets on pages 65-70



ER Collets  
Pages 65-70



ER Torque  
Wrenches  
Page 75



ER Back Up  
Screws  
Page 75



ER Nuts  
Page 74

# ER COLLET CHUCKS



## BT ER COLLET CHUCKS

### FEATURES

- Ball bearing nut with ground collet race
- AT3 or better taper
- Equipped with a right-hand-threaded back-up screw



**T.I.R.**  
≤ 0.0001" in ID bore



**Speed**  
Up to 25,000 rpm



**Coolant-Thru**  
Thru-tool coolant

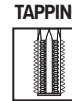

Please note that the maximum RPM listed in our catalog may vary depending on the toolholder shank, weight, balanceability and the G rating.

### BT50 - BEARING NUT

Part Number	Collet Size	Collet Range	Nut Wrench	L	L1	D	Max. RPM	Fig.
<b>B5007-0016-4.12</b>	ER16	0.019 - 0.406"	016-SPAN	4.12"	2.63"	1.26"	25K	6
<b>B5007-0016-6.00</b>	ER16	0.019 - 0.406"	016-SPAN	6.00"	4.51"	1.26"	25K	6
<b>B5007-0020-2.75</b>	ER20	0.039 - 0.511"	020-SPAN	2.75"	1.26"	1.38"	25K	6
<b>B5007-0020-4.00</b>	ER20	0.039 - 0.511"	020-SPAN	4.00"	2.50"	1.38"	25K	6
<b>B5007-0025-2.63</b>	ER25	0.039 - 0.511"	020-SPAN	2.63"	1.13"	1.65"	25K	6
<b>B5007-0025-4.00</b>	ER25	0.039 - 0.511"	020-SPAN	4.00"	2.50"	1.65"	25K	6
<b>B5007-0032-4.00</b>	ER32	0.078 - 0.787"	032-SPAN	4.00"	2.50"	1.97"	25K	6
<b>B5007-0032-6.00</b>	ER32	0.078 - 0.787"	032-SPAN	6.00"	4.50"	1.97"	25K	6
<b>B5007-0040-4.00</b>	ER40	0.078 - 0.787"	032-SPAN	4.00"	2.50"	2.44"	25K	6
<b>B5007-0040-6.00</b>	ER40	0.078 - 0.787"	032-SPAN	6.00"	4.50"	2.44"	25K	6

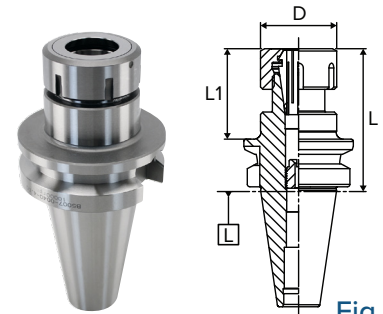

Fig. 6

**Notes:**

- Back-up Screw included with ER Collet Chuck.
- \*For Extended Length holders, "L" dimension has tapered length.  
To confirm clearance, please download model/drawing from our website



Available in **TAPER PLUS<sup>+</sup>**  
Dual-taper and flange contact

ER Collet Chucks have coolant-thru capabilities. No disc, special nut or wrench required!  
See ER Coolant Collets on pages 65-70



ER Collets  
Pages 65-70



ER Torque  
Wrenches  
Page 75



ER Back Up  
Screws  
Page 75



ER Nuts  
Page 74

## TAPER PLUS ER COLLET CHUCKS

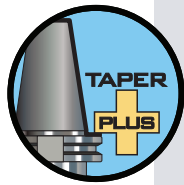

### Taper Plus (Dual Contact) Advantages

- Outstanding runout accuracy for longer tool life
- Vibration dampening for increased productivity
- High rigidity for smooth and stable cutting
- Interchangeable between standard and dual face contact spindles
- 53% more surface area contact than just the taper alone

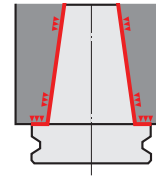

ER COLLET CHUCKS

### TAPER PLUS - CAT40

Part Number	Collet Size	Collet Range	L	L1	L2	D	D1	Max. RPM	Fig.
NC4007-0016-2.25G	ER16	0.019 - 0.406"	2.25"	1.53"	-	1.26"	1.75"	25K	2
NC4007-0016-3.50G	ER16	0.019 - 0.406"	3.50"	2.12"	-	1.26"	1.75"	25K	2
NC4007-0016-6.00G	ER16	0.019 - 0.406"	6.00"	4.62"	-	1.26"	1.75"	25K	2
NC4007-0016-9.00G	ER16	0.019 - 0.406"	9.00"	1.64"	7.63"	1.26"	1.75"	25K	3
NC4007-0020-2.50G	ER20	0.039 - 0.511"	2.50"	1.13"	-	1.38"	1.75"	25K	2
NC4007-0020-4.00G	ER20	0.039 - 0.511"	4.00"	2.62"	-	1.38"	1.75"	25K	2
NC4007-0020-6.00G	ER20	0.039 - 0.511"	6.00"	4.62"	-	1.38"	1.75"	25K	2
NC4007-0020-9.00G	ER20	0.039 - 0.511"	9.00"	1.72"	7.63"	1.38"	1.75"	25K	3
NC4007-0025-2.50G	ER25	0.039 - 0.629"	2.50"	1.14"	-	1.65"	1.75"	25K	2
NC4007-0025-4.00G	ER25	0.039 - 0.629"	4.00"	2.63"	-	1.65"	1.75"	25K	2
NC4007-0025-6.00G	ER25	0.039 - 0.629"	6.00"	4.62"	-	1.65"	1.75"	25K	2
NC4007-0032-3.13G	ER32	0.078 - 0.787"	3.13"	1.75"	-	1.97"	1.75"	25K	2
NC4007-0032-5.00G	ER32	0.078 - 0.787"	5.00"	3.62"	-	1.97"	1.75"	25K	2
NC4007-0032-9.00G	ER32	0.078 - 0.787"	9.00"	1.74"	7.63"	1.97"	1.75"	25K	3
NC4007-0040-3.13G	ER40	0.188 - 1.023"	3.13"	1.79"	-	2.44"	1.75"	25K	2

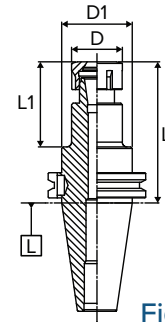

Fig. 2

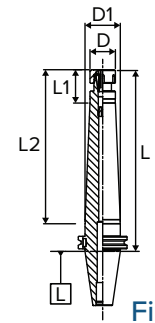

Fig. 3

Note: See page 69 for Torque Wrench and attachment options.

ER Collet Chucks have coolant-thru capabilities. No disc, special nut or wrench required!  
See ER Coolant Collets on pages 65-70



# ER COLLET CHUCKS

## TAPER PLUS ER COLLET CHUCKS

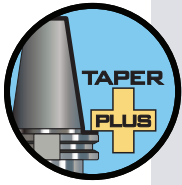

### Taper Plus (Dual Contact) Advantages

- Outstanding runout accuracy for longer tool life
- Vibration dampening for increased productivity
- High rigidity for smooth and stable cutting
- Interchangeable between standard and dual face contact spindles
- 53% more surface area contact than just the taper alone

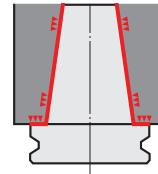

### TAPER PLUS - CAT50

Part Number	Collet Size	Collet Range	L	L1	L2	D	D1	Max. RPM	Fig.
NC5007-0016-4.12G	ER16	0.019 - 0.406"	4.12"	2.75"	-	1.26"	2.75"	25K	2
NC5007-0016-6.00G	ER16	0.019 - 0.406"	6.00"	4.63"	-	1.26"	2.75"	25K	2
NC5007-0016-8.00G	ER16	0.019 - 0.406"	8.00"	1.64"	6.62"	1.26"	2.75"	25K	3
NC5007-0020-4.00G	ER20	0.039 - 0.511"	4.00"	2.62"	-	1.38"	2.75"	25K	2
NC5007-0020-6.00G	ER20	0.039 - 0.511"	6.00"	4.62"	-	1.38"	2.75"	25K	2
NC5007-0020-8.00G	ER20	0.039 - 0.511"	8.00"	1.72"	6.62"	1.38"	2.75"	25K	3
NC5007-0020-12.00G	ER20	0.039 - 0.511"	12.00"	1.57"	10.63"	1.38"	2.75"	25K	3
NC5007-0025-4.00G	ER25	0.039 - 0.629"	4.00"	2.62"	-	1.65"	2.75"	25K	2
NC5007-0025-8.00G	ER25	0.039 - 0.629"	8.00"	1.74"	6.62"	1.65"	2.75"	25K	3
NC5007-0032-4.00G	ER32	0.078 - 0.787"	4.00"	2.62"	-	1.97"	2.75"	25K	2
NC5007-0032-6.00G	ER32	0.078 - 0.787"	6.00"	4.63"	-	1.97"	2.75"	25K	2
NC5007-0032-8.00G	ER32	0.078 - 0.787"	8.00"	1.85"	6.63"	1.97"	2.75"	25K	3
NC5007-0032-12.00G	ER32	0.078 - 0.787"	12.00"	1.85"	10.63"	1.97"	2.75"	25K	3
NC5007-0040-4.00G	ER40	0.118 - 1.023"	4.00"	2.62"	-	2.44"	2.75"	25K	2
NC5007-0040-6.00G	ER40	0.118 - 1.023"	6.00"	4.62"	-	2.44"	2.75"	25K	2
NC5007-0040-8.00G	ER40	0.118 - 1.023"	8.00"	1.97"	6.63"	2.44"	2.75"	25K	3
NC5007-0040-12.00G	ER40	0.118 - 1.023"	12.00"	1.97"	10.63"	2.44"	2.75"	25K	3

Note: See page 69 for Torque Wrench and attachment options.

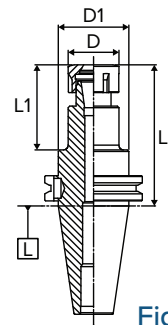

Fig. 2

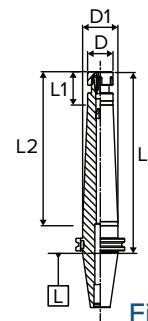

Fig. 3

ER COLLET CHUCKS

ER Collet Chucks have coolant-thru capabilities. No disc, special nut or wrench required!  
See ER Coolant Collets on pages 65-70



## TAPER PLUS BT ER COLLET CHUCKS

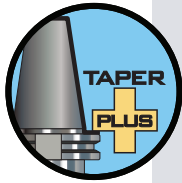

### Taper Plus (Dual Contact) Advantages

- Outstanding runout accuracy for longer tool life
- Vibration dampening for increased productivity
- High rigidity for smooth and stable cutting
- Interchangeable between standard and dual face contact spindles
- 53% more surface area contact than just the taper alone

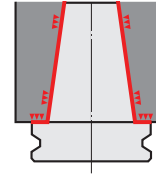

### TAPER PLUS - BT30

Part Number	Collet Size	Collet Range	Nut Wrench	L	L1	D	Max. RPM	Fig.
NB3007-0008-2.00M	ER8	0.019 - 0.197"	WRENCH-ER08-MINI	2.00"	1.14"	0.47"	30K	6
NB3007-0011-2.00	ER11	0.019 - 0.275"	011-HEX	2.00"	1.14"	0.75"	30K	6
NB3007-0016-2.36G	ER16	0.019 - 0.406"	-	2.36"	1.50"	1.26"	30K	6
NB3007-0016-4.00G	ER16	0.019 - 0.406"	-	4.00"	3.13"	1.26"	30K	6
NB3007-0016-5.00G	ER16	0.019 - 0.406"	-	5.00"	4.14"	1.26"	30K	6
NB3007-0016-6.00G	ER16	0.019 - 0.406"	-	6.00"	5.13"	1.26"	30K	6
NB3007-0020-2.50G	ER20	0.039 - 0.511"	-	2.50"	1.63"	1.38"	30K	6
NB3007-0020-4.00G	ER20	0.039 - 0.511"	-	4.00"	3.13"	1.38"	30K	6
NB3007-0025-2.00G	ER25	0.039 - 0.629"	-	2.00"	1.13"	1.65"	30K	6
NB3007-0025-4.00G	ER25	0.039 - 0.629"	-	4.00"	3.14"	1.65"	30K	6
NB3007-0032-3.00G	ER32	0.078 - 0.787"	-	3.00"	2.13"	1.97"	30K	6
NB3007-0032-5.00G	ER32	0.078 - 0.787"	-	5.00"	4.14"	1.97"	30K	6

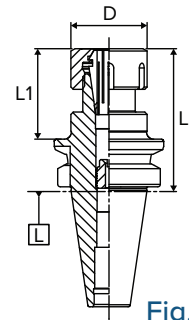

Fig. 6

Note: See page 69 for Torque Wrench and attachment options. Only applies to part numbers ending in "G".

ER Collet Chucks have coolant-thru capabilities. No disc, special nut or wrench required!  
See ER Coolant Collets on pages 65-70



# ER COLLET CHUCKS

## TAPER PLUS BT ER COLLET CHUCKS

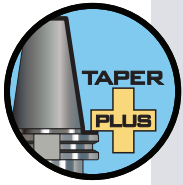

### Taper Plus (Dual Contact) Advantages

- Outstanding runout accuracy for longer tool life
- Vibration dampening for increased productivity
- High rigidity for smooth and stable cutting
- Interchangeable between standard and dual face contact spindles
- 53% more surface area contact than just the taper alone

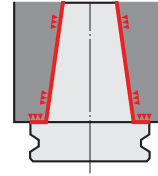

### TAPER PLUS - BT40

Part Number	Collet Size	Collet Range	L	L1	D	Max. RPM	Fig.
<b>NB4007-0020-2.50G</b>	ER20	0.039 - 0.511"	2.50"	1.44"	1.38"	25K	6
<b>NB4007-0020-4.00G</b>	ER20	0.039 - 0.511"	4.00"	2.94"	1.38"	25K	6
<b>NB4007-0020-6.00G</b>	ER20	0.039 - 0.511"	6.00"	4.94"	1.38"	25K	6
<b>NB4007-0025-2.25G</b>	ER25	0.039 - 0.629"	2.25"	1.19"	1.65"	25K	6
<b>NB4007-0025-4.00G</b>	ER25	0.039 - 0.629"	4.00"	2.94"	1.65"	25K	6
<b>NB4007-0025-6.00G</b>	ER25	0.039 - 0.629"	6.00"	4.94"	1.65"	25K	6
<b>NB4007-0032-3.13G</b>	ER32	0.078 - 0.787"	3.13"	2.06"	1.97"	25K	6
<b>NB4007-0032-5.00G</b>	ER32	0.078 - 0.787"	5.00"	3.94"	1.97"	25K	6
<b>NB4007-0032-6.30G</b>	ER32	0.078 - 0.787"	6.30"	5.28"	1.97"	25K	6

Note: See page 69 for Torque Wrench and attachment options.

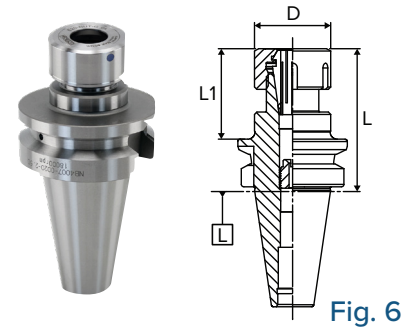

Fig. 6

ER Collet Chucks have coolant-thru capabilities. No disc, special nut or wrench required!  
See ER Coolant Collets on pages 65-70



## HSK ER COLLET CHUCKS

### FEATURES

- Ball bearing nut with ground collet race
- AT3 or better taper
- Equipped with a right-hand-threaded back-up screw



**T.I.R.**  
≤ 0.0001" in ID bore



**Speed**  
Up to 25,000 rpm



**Coolant-Thru**  
Thru-tool coolant

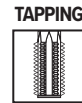

Please note that the maximum RPM listed in our catalog may vary depending on the toolholder shank, weight, balanceability and the G rating.

### HSK40A/63A

Part Number	Collet Size	Collet Range	Nut Wrench	L (mm)	L	L1	L2	D	D1	Max. RPM	Fig.
HSK40A-ER11-75	ER11	0.019 - 0.275"	011-HEX	75	2.95"	2.17"	-	0.75"	-	25K	7
HSK40A-ER16-75	ER16	0.019 - 0.406"	016-SPAN	75	2.95"	2.16"	-	1.26"	-	25K	7
HSK40A-ER20-75	ER20	0.039 - 0.511"	020-SPAN	75	2.95"	2.17"	-	1.38"	-	25K	7
HSK40A-ER25-80	ER25	0.039 - 0.629"	025-SPAN	80	3.15"	2.36"	-	1.65"	-	25K	7
HSK40A-ER32-80	ER32	0.078 - 0.787"	032-SPAN	80	3.15"	2.36"	-	1.97"	-	25K	7
HSK63A-ER16-3.00	ER16	0.019 - 0.406"	016-SPAN	-	3.00"	1.98"	-	1.26"	-	25K	7
HSK63A-ER16-5.00	ER16	0.019 - 0.406"	016-SPAN	-	5.00"	3.98"	-	1.26"	-	25K	7
HSK63A-ER20-3.00	ER20	0.039 - 0.511"	020-SPAN	-	3.00"	1.99"	-	1.38"	-	25K	7
HSK63A-ER20-5.00	ER20	0.039 - 0.511"	020-SPAN	-	5.00"	3.98"	-	1.38"	-	25K	7
HSK63A-ER25-3.00	ER25	0.039 - 0.629"	025-SPAN	-	3.00"	1.98"	-	1.65"	-	25K	7
HSK63A-ER25-5.00	ER25	0.039 - 0.629"	025-SPAN	-	5.00"	3.98"	-	1.65"	-	25K	7
HSK63A-ER32-4.00	ER32	0.078 - 0.787"	032-SPAN	-	4.00"	2.99"	-	1.97"	-	25K	7
HSK63A-ER32-6.00	ER32	0.078 - 0.787"	032-SPAN	-	6.00"	4.98"	-	1.97"	-	25K	7
HSK63A-ER40-4.00	ER40	0.118 - 1.023"	040-SPAN	-	4.00"	2.97"	-	2.44"	-	25K	7
HSK63A-ER40-6.00	ER40	0.118 - 1.023"	040-SPAN	-	6.00"	4.98"	-	2.44"	-	25K	7

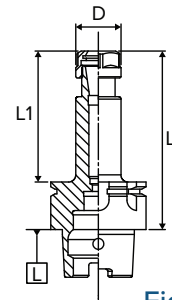

Fig. 7

### HSK63A - SOLID HEX NUT

Part Number	Collet Size	Collet Range	Nut Wrench	L (mm)	L	L1	D	Max. RPM	Fig.
HSK63A-ER16S-80	ER16	0.019 - 0.406"	016-SPAN	80	3.15"	2.13"	1.10"	25K	7
HSK63A-ER16S-100	ER16	0.019 - 0.406"	016-SPAN	100	3.94"	2.91"	1.10"	25K	7
HSK63A-ER16S-160	ER16	0.019 - 0.406"	016-SPAN	160	6.30"	5.28"	1.10"	25K	7

### HSK63A - SOLID NUT

Part Number	Collet Size	Collet Range	Nut Wrench	L (mm)	L	L1	D	Max. RPM	Fig.
HSK63A-ER20S-80	ER20	0.039 - 0.511"	020-SPAN	80	3.15"	2.13"	1.34"	25K	7
HSK63A-ER20S-100	ER20	0.039 - 0.511"	020-SPAN	100	3.94"	2.91"	1.34"	25K	7
HSK63A-ER20S-160	ER20	0.039 - 0.511"	020-SPAN	160	6.30"	5.28"	1.34"	25K	7
HSK63A-ER25S-80	ER25	0.078 - 0.787"	025-SPAN	80	3.15"	2.13"	1.66"	25K	7
HSK63A-ER25S-150	ER25	0.078 - 0.787"	025-SPAN	150	5.91"	4.88"	1.66"	25K	7
HSK63A-ER32S-80	ER32	0.078 - 0.787"	032-SPAN	80	3.15"	2.13"	1.97"	25K	7
HSK63A-ER32S-100	ER32	0.078 - 0.787"	032-SPAN	100	3.94"	2.91"	1.97"	25K	7
HSK63A-ER32S-160	ER32	0.078 - 0.787"	032-SPAN	160	6.30"	5.28"	1.97"	25K	7
HSK63A-ER40S-80	ER40	0.118 - 1.023"	040-SPAN	80	3.15"	2.13"	2.48"	25K	7
HSK63A-ER40S-120	ER40	0.118 - 1.023"	040-SPAN	120	4.72"	3.70"	2.48"	25K	7

ER Collet Chucks have coolant-thru capabilities. No disc, special nut or wrench required!  
See ER Coolant Collets on pages 65-70



# ER COLLET CHUCKS

## HSK ER COLLET CHUCKS

### FEATURES

- Ball bearing nut with ground collet race
- AT3 or better taper
- Equipped with a right-hand-threaded back-up screw



**T.I.R.**  
≤ 0.0001" in ID bore



**Speed**  
Up to 25,000 rpm



**Coolant-Thru**  
Thru-tool coolant

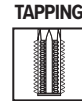

Please note that the maximum RPM listed in our catalog may vary depending on the toolholder shank, weight, balanceability and the G rating.

### HSK100A

Part Number	Collet Size	Collet Range	Nut Wrench	L	L1	D	Max. RPM	Fig.
HSK100A-ER16-4.00	ER16	0.019 - 0.406"	016-SPAN	4.00"	2.87"	1.26"	25K	7
HSK100A-ER16-6.00	ER16	0.019 - 0.406"	016-SPAN	6.00"	4.85"	1.26"	25K	7
HSK100A-ER20-4.00	ER20	0.039 - 0.511"	020-SPAN	4.00"	2.85"	1.38"	25K	7
HSK100A-ER20-6.00	ER20	0.039 - 0.511"	020-SPAN	6.00"	4.86"	1.38"	25K	7
HSK100A-ER25-4.00	ER25	0.039 - 0.629"	025-SPAN	4.00"	2.85"	1.65"	25K	7
HSK100A-ER25-6.00	ER25	0.039 - 0.629"	025-SPAN	6.00"	4.86"	1.65"	25K	7
HSK100A-ER32-4.00	ER32	0.078 - 0.787"	032-SPAN	4.00"	2.85"	1.97"	25K	7
HSK100A-ER32-6.00	ER32	0.078 - 0.787"	032-SPAN	6.00"	4.85"	1.97"	25K	7
HSK100A-ER40-4.00	ER40	0.118 - 1.023"	040-SPAN	4.00"	2.86"	2.44"	25K	7
HSK100A-ER40-6.00	ER40	0.118 - 1.023"	040-SPAN	6.00"	4.86"	2.44"	25K	7

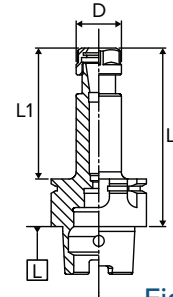

Fig. 7

Note: Coolant tube and coolant wrench not included. See page 75 for details.

### HSK100A - SOLID HEX NUT

Part Number	Collet Size	Collet Range	Nut Wrench	L (mm)	L	L1	D	Max. RPM	Fig.
HSK100A-ER16S-100	ER16	0.019 - 0.406"	016-SPAN	100	3.94"	2.79"	1.10"	25K	7
HSK100A-ER16S-160	ER16	0.019 - 0.406"	016-SPAN	160	6.30"	5.16"	1.10"	25K	7

### HSK100A - SOLID NUT

Part Number	Collet Size	Collet Range	Nut Wrench	L (mm)	L	L1	D	Max. RPM	Fig.
HSK100A-ER32S-100	ER32	0.078 - 0.787"	032-SPAN	100	3.94"	2.78"	1.97"	25K	7
HSK100A-ER32S-160	ER32	0.078 - 0.787"	032-SPAN	160	6.30"	5.16"	1.97"	25K	7
HSK100A-ER40S-120	ER40	0.118 - 1.023"	040-SPAN	120	4.72"	3.59"	2.48"	25K	7

ER Collet Chucks have coolant-thru capabilities. No disc, special nut or wrench required!

See ER Coolant Collets on pages 65-70



ER Collets  
Pages 65-70



ER Torque  
Wrenches  
Page 75



ER Back Up  
Screws  
Page 75



ER Nuts  
Page 74

## NMTB AND R8 ER COLLET CHUCKS

### FEATURES

- Ball bearing nut with ground collet race
- AT3 or better taper



**T.I.R.**  
≤ 0.0001" in ID bore



**Coolant-Thru**  
Thru-tool coolant

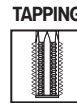

Please note that the maximum RPM listed in our catalog may vary depending on the toolholder shank, weight, balanceability and the G rating.

### NMTB30/40/50

Part Number	Collet Size	Collet Range	Nut Wrench	L	L1	D	Fig.
<b>N3007-0011-2.00</b>	ER11	0.019 - 0.275"	011-HEX	2.00"	1.60"	0.75"	8
<b>N3007-0016-1.77</b>	ER16	0.019 - 0.406"	016-SPAN	1.77"	1.35"	1.26"	8
<b>N4007-0016-1.77</b>	ER16	0.019 - 0.406"	016-SPAN	1.77"	1.41"	1.26"	8
<b>N4007-0025-2.00</b>	ER25	0.039 - 0.629"	025-SPAN	2.00"	1.62"	1.65"	8
<b>N5007-0016-2.00</b>	ER16	0.019 - 0.406"	016-SPAN	2.00"	1.41"	1.26"	8
<b>N5007-0025-2.00</b>	ER25	0.039 - 0.629"	025-SPAN	2.00"	1.41"	1.65"	8

Note: NMTB shanks are suitable for use with Erickson Quick Change spindles.

### R8

Part Number	Collet Size	Collet Range	Nut Wrench	L	L1	D	Fig.
<b>R8007-0016-1.00S</b>	ER16	0.019 - 0.406"	WRENCH-ER16-HEX	1.00"	0.87"	1.10"	9
<b>R8007-0020-2.00S</b>	ER20	0.039 - 0.511"	WRENCH-ER20-HEX	2.00"	2.07"	1.34"	9
<b>R8007-0025-2.50S</b>	ER25	0.039 - 0.629"	025-SPAN	2.50"	2.37"	1.65"	9

Note: ER Collet Chucks come with back-up screw.

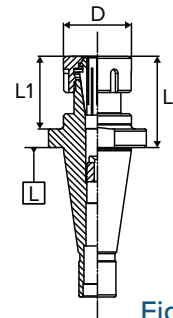

Fig. 8

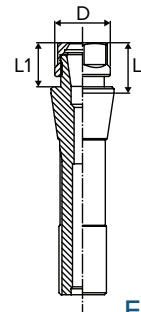

Fig. 9

ER Collet Chucks have coolant-thru capabilities. No disc, special nut or wrench required!  
See ER Coolant Collets on pages 65-70



# ER COLLET CHUCKS

## ER COLLET CHUCK EXTENSIONS

Part Number	Collet Size	Collet Range	Nut Wrench	D	D1	L	L1	Fig.
ER8-EXT-500M	ER8	0.019 - 0.197"	WRENCH-ER08-MINI	0.49"	0.50"	5.95"	0.95"	10
ER8-EXT-625M	ER8	0.019 - 0.197"	WRENCH-ER08-MINI	0.49"	0.63"	5.95"	0.95"	10
E11-EXT-500	ER11	0.019 - 0.275"	011-HEX	0.75"	0.50"	6.07"	1.07"	10
E11-EXT-625	ER11	0.019 - 0.275"	011-HEX	0.75"	0.63"	6.07"	1.07"	10
E11-EXT-750	ER11	0.019 - 0.275"	011-HEX	0.75"	0.75"	5.61"	0.61"	10
E16-EXT-100	ER16	0.019 - 0.406"	016-SPAN	1.26"	1.00"	5.89"	0.97"	10
E16-EXT-625	ER16	0.019 - 0.406"	016-SPAN	1.26"	0.63"	6.48"	1.48"	10
E16-EXT-750	ER16	0.019 - 0.406"	016-SPAN	1.26"	0.75"	6.48"	1.48"	10
E20-EXT-100	ER20	0.039 - 0.511"	020-SPAN	1.38"	1.00"	6.40"	1.40"	10
E20-EXT-125	ER20	0.039 - 0.511"	020-SPAN	1.38"	1.25"	6.39"	1.39"	10
E20-EXT-750	ER20	0.039 - 0.511"	020-SPAN	1.38"	0.75"	6.67"	1.67"	10
E25-EXT-100	ER25	0.039 - 0.629"	025-SPAN	1.65"	1.00"	6.85"	1.85"	10
E25-EXT-125	ER25	0.039 - 0.629"	025-SPAN	1.65"	1.25"	6.00"	1.00"	10
E25-EXT-750	ER25	0.039 - 0.629"	025-SPAN	1.65"	0.75"	6.86"	1.86"	10
E32-EXT-100	ER32	0.078 - 0.787"	032-SPAN	1.97"	1.00"	7.09"	2.09"	10
E32-EXT-125	ER32	0.078 - 0.787"	032-SPAN	1.97"	1.25"	7.09"	2.09"	10

Note: ER Collet Chucks come with back-up screw.

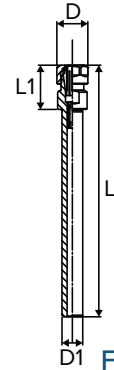

Fig. 10

ER Collet Chucks have coolant-thru capabilities. No disc, special nut or wrench required!  
See ER coolant Collets on pages 52-59



## Lyndex-Nikken Offers Single and Dual Plane Balancing for Large Diameter or Long Tooling Assemblies

### Benefits of ER Collet Chuck Balancing:

- Balanced assemblies can reduce spindle vibration—prolonging the life of your cutting tools and spindle.
- Increase the quality and consistency of machined surface finishes.
- Achieves greater machined surface flatness.
- Balancing service is only required once during initial set up.



ER Collets  
Pages 65-70



ER Torque  
Wrenches  
Page 75



ER Back Up  
Screws  
Page 75



ER Nuts  
Page 74

## POLYGONAL TAPER ER COLLET CHUCKS

### FEATURES

- Extremely stable and rigid connection between tool and the machine
- High torque and bending forces transmission due to simultaneous tapered polygon and face contact with machine spindle
- Self centering ability due to unique design
- Internal coolant supply, directly to the tool tip
- Best solution for all processes - both in turning and milling
- Modular design for flexible tooling
- Standardized interface as per ISO 26623



**T.I.R.**  
≤ 0.0001" in ID bore



**Speed**  
Up to 25,000 rpm



**Coolant-Thru**  
Thru-tool coolant

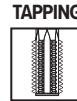

Please note that the maximum RPM listed in our catalog may vary depending on the toolholder shank, weight, balanceability and the G rating.

### C3/C4/C5/C6/C8

Part Number	Collet Size	Collet Range	Nut Wrench	L (mm)	L	L1	D	Max. RPM	Fig.
<b>C3-ER16-45</b>	ER16	0.019 - 0.406"	016-SPAN	45	1.77"	1.18"	1.26"	25K	11
<b>C3-ER20-45</b>	ER20	0.039 - 0.511"	020-SPAN	45	1.77"	1.18"	1.38"	25K	11
<b>C4-ER16-70</b>	ER16	0.019 - 0.406"	016-SPAN	70	2.76"	1.97"	1.26"	25K	11
<b>C4-ER20-52</b>	ER20	0.039 - 0.511"	020-SPAN	52	2.05"	1.26"	1.38"	25K	11
<b>C4-ER25-52</b>	ER25	0.039 - 0.629"	025-SPAN	52	2.05"	1.14"	1.65"	25K	11
<b>C4-ER32-54</b>	ER32	0.078 - 0.787"	032-SPAN	54	2.13"	1.34"	1.97"	25K	11
<b>C5-ER16-100</b>	ER16	0.019 - 0.406"	016-SPAN	100	3.94"	3.15"	1.26"	25K	11
<b>C5-ER20-55</b>	ER20	0.039 - 0.511"	020-SPAN	55	2.17"	1.38"	1.38"	25K	11
<b>C5-ER20-100</b>	ER20	0.039 - 0.511"	020-SPAN	100	3.94"	3.15"	1.38"	25K	11
<b>C5-ER20-130</b>	ER20	0.039 - 0.511"	020-SPAN	130	5.12"	4.33"	1.38"	25K	11
<b>C5-ER25-55</b>	ER25	0.039 - 0.629"	025-SPAN	55	2.17"	1.38"	1.65"	25K	11
<b>C5-ER25-100</b>	ER25	0.039 - 0.629"	025-SPAN	100	3.94"	3.15"	1.65"	25K	11
<b>C5-ER32-57</b>	ER32	0.078 - 0.787"	032-SPAN	57	2.24"	1.46"	1.97"	25K	11
<b>C5-ER32-100</b>	ER32	0.078 - 0.787"	032-SPAN	100	3.94"	3.15"	1.97"	25K	11
<b>C5-ER40-60</b>	ER40	0.118 - 1.023"	040-SPAN	60	2.36"	1.58"	2.44"	25K	11
<b>C6-ER16-100</b>	ER16	0.019 - 0.406"	016-SPAN	100	3.94"	3.07"	1.26"	25K	11
<b>C6-ER20-60</b>	ER20	0.039 - 0.511"	020-SPAN	60	2.36"	1.50"	1.38"	25K	11
<b>C6-ER20-100</b>	ER20	0.039 - 0.511"	020-SPAN	100	3.94"	3.07"	1.38"	25K	11
<b>C6-ER25-60</b>	ER25	0.039 - 0.629"	025-SPAN	60	2.36"	1.50"	1.65"	25K	11
<b>C6-ER25-100</b>	ER25	0.039 - 0.629"	025-SPAN	100	3.94"	3.07"	1.67"	25K	11
<b>C6-ER32-60</b>	ER32	0.078 - 0.787"	032-SPAN	60	2.36"	1.50"	1.97"	25K	11
<b>C6-ER32-100</b>	ER32	0.078 - 0.787"	032-SPAN	100	3.94"	3.07"	1.97"	25K	11
<b>C6-ER32-130</b>	ER32	0.078 - 0.787"	032-SPAN	130	5.12"	4.25"	1.97"	25K	11
<b>C6-ER40-65</b>	ER40	0.118 - 1.023"	040-SPAN	65	2.56"	1.69"	2.44"	25K	11
<b>C8-ER20-65</b>	ER20	0.039 - 0.511"	020-SPAN	65	2.56"	1.38"	1.38"	25K	11
<b>C8-ER25-70</b>	ER25	0.039 - 0.629"	025-SPAN	70	2.76"	1.58"	1.65"	25K	11
<b>C8-ER32-70</b>	ER32	0.078 - 0.787"	032-SPAN	70	2.76"	1.58"	1.97"	25K	11
<b>C8-ER32-160</b>	ER32	0.078 - 0.787"	032-SPAN	160	6.30"	5.12"	1.97"	25K	11
<b>C8-ER40-70</b>	ER40	0.118 - 1.023"	040-SPAN	70	2.76"	1.58"	2.44"	25K	11

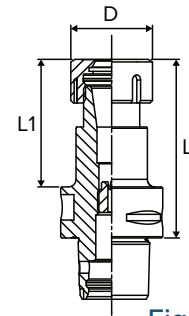

Fig. 11

ER Collet Chucks have coolant-thru capabilities. No disc, special nut or wrench required!  
See ER Coolant Collets on pages 65-70



# ER COLLET CHUCKS



ER COLLET CHUCKS

## ER8 AND ER11 COLLETS

### ER COLLET DIMENSIONAL DATA

Style	D	D1	L	Collet Range	Coolant Collet Size Range
ER8	0.330"	0.216"	0.535"	0.019 - 0.196"	N/A
ER11	0.460"	0.307"	0.709"	0.019 - 0.275"	0.157 - 0.275"
ER16	0.677"	0.445"	1.063"	0.019 - 0.393"	0.157 - 0.393"
ER20	0.835"	0.571"	1.220"	0.039 - 0.511"	0.196 - 0.511"
ER25	1.031"	0.728"	1.378"	0.039 - 0.629"	0.236 - 0.629"
ER32	1.307"	0.960"	1.575"	0.078 - 0.787"	0.393 - 0.787"
ER40	1.622"	1.228"	1.811"	0.118 - 1.023"	0.393 - 1.023"

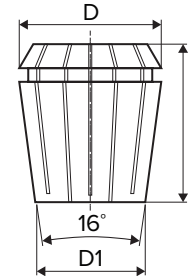

### ER8 COLLETS

Size range: 1.00 - 5.00mm (0.039" - 0.197")

#### METRIC

Part Number	Size	Collapse Range
ER8-039	1.0mm	0.5~1mm
ER8-059	1.5mm	1~1.5mm
ER8-078	2.0mm	1.5~2mm
ER8-098	2.5mm	2~2.5mm
ER8-118	3.0mm	2.5 - 3mm
ER8-137	3.5mm	3~3.5mm
ER8-157	4.0mm	3.5~4mm
ER8-177	4.5mm	4 - 4.5mm
ER8-196	5.0mm	4.5 - 5mm
ER8-SET-09-MM	9 Piece Set 0.5 - 5.0mm by 0.5mm	



#### Precision Standard

Precision slots allow for even distribution of clamping pressure and minimal run out.



#### Coolant-Thru

Our patented Coolant Collets are designed for use with cylindrical shank tools (no flats). Cutting tool should be inserted the full length of the collet. If these conditions are not met, coolant leakage may result. Seals up to maximum coolant pressure of 2900 psi. Steel-sealed and mechanically sealed by design.

### ER11 COLLETS

Size Range: 1/32 - 17/64"  
(0.031 - 0.266")

Size Range: 1.0 - 7.0mm  
(0.039 - 0.276")

Size Range: 3/16 - 17/64"  
(0.188 - 0.266")

Size Range: 4.0 - 7.0mm  
(0.157 - 0.276")

#### INCH

Part Number	Size	Collapse Range
E11-002	1/32"	0.024 - 0.031"
E11-003	3/64"	0.027 - 0.047"
E11-004	1/16"	0.043 - 0.063"
E11-005	5/64"	0.058 - 0.078"
E11-006	3/32"	0.074 - 0.094"
E11-007	7/64"	0.09 - 0.109"
E11-008	1/8"	0.105 - 0.125"
E11-009	9/64"	0.121 - 0.141"
E11-010	5/32"	0.137 - 0.156"
E11-011	11/64"	0.156 - 0.172"
E11-012	3/16"	0.168 - 0.188"
E11-013	13/64"	0.183 - 0.203"
E11-014	7/32"	0.199 - 0.219"
E11-015	15/64"	0.215 - 0.234"
E11-016	1/4"	0.23 - 0.25"
E11-017	17/64"	0.246 - 0.266"

#### METRIC

Part Number	Size	Collapse Range
E11-039	1.0mm	0.5 - 1mm
E11-059	1.5mm	1 - 1.5mm
E11-078	2.0mm	1.5 - 2mm
E11-098	2.5mm	2 - 2.5mm
E11-118	3.0mm	2.5 - 3mm
E11-137	3.5mm	3 - 3.5mm
E11-157	4.0mm	3.5 - 4mm
E11-177	4.5mm	4 - 4.5mm
E11-196	5.0mm	4.5 - 5mm
E11-216	5.5mm	5 - 5.5mm
E11-236	6.0mm	5.5 - 6mm
E11-255	6.5mm	6 - 6.5mm
E11-275	7.0mm	6.5 - 7mm

#### INCH COOLANT-THRU

Part Number	Size	Collapse Range
E11-012(C)	3/16"	0.183 - 0.188"
E11-013(C)	13/64"	0.199 - 0.203"
E11-014(C)	7/32"	0.215 - 0.219"
E11-015(C)	15/64"	0.23 - 0.234"
E11-016(C)	1/4"	0.246 - 0.25"
E11-017(C)	17/64"	0.262 - 0.266"

#### METRIC COOLANT-THRU

Part Number	Size	Collapse Range
E11-157(C)	4.0mm	3.9 - 4mm
E11-177(C)	4.5mm	4.4 - 4.5mm
E11-196(C)	5.0mm	4.9 - 5mm
E11-216(C)	5.5mm	5.4 - 5.5mm
E11-236(C)	6.0mm	5.9 - 6mm
E11-255(C)	6.5mm	6.4 - 6.5mm
E11-275(C)	7.0mm	6.9 - 7mm

### ER11 COLLET SETS

E11-SET-14	14 Piece Set: 1/16" - 17/64" by 1/64ths
E11-SET-12-MM	12 Piece Set: 1.0 mm- 7.0mm by 0.5mm

### ER11 COOLANT COLLET SETS

E11-SET-06(C)	6 Piece Set: 3/16" - 1/4" by 1/64ths
E11-SET-07(C)-MM	7 Piece Set: 3.9mm - 7.0mm by 0.5mm

## ER16 COLLETS



### Precision Standard

Precision slots allow for even distribution of clamping pressure and minimal run out.

Size Range: 1/32 - 13/32"  
(0.031 - 0.406")

Size Range: 1.0 - 10.0mm  
(0.039 - 0.394")

### INCH

Part Number	Size	Collapse Range
E16-002	1/32"	0.024 - 0.031"
E16-004	1/16"	0.043 - 0.063"
E16-006	3/32"	0.074 - 0.094"
E16-008	1/8"	0.105 - 0.125"
E16-010	5/32"	0.141 - 0.156"
E16-012	3/16"	0.148 - 0.188"
E16-014	7/32"	0.179 - 0.219"
E16-016	1/4"	0.211 - 0.25"
E16-018	9/32"	0.242 - 0.281"
E16-020	5/16"	0.273 - 0.313"
E16-022	11/32"	0.304 - 0.344"
E16-024	3/8"	0.336 - 0.375"
E16-026	13/32"	0.367 - 0.406"

### METRIC

Part Number	Size	Collapse Range
E16-039	1.0mm	0.5 - 1mm
E16-059	1.5mm	1 - 1.5mm
E16-078	2.0mm	1.5 - 2mm
E16-098	2.5mm	2 - 2.5mm
E16-118	3.0mm	2.5 - 3mm
E16-137	3.5mm	3 - 3.5mm
E16-157	4.0mm	3.5 - 4mm
E16-177	4.5mm	4 - 4.5mm
E16-196	5.0mm	4 - 5mm
E16-216	5.5mm	4.5 - 5.5mm
E16-236	6.0mm	5 - 6mm
E16-255	6.5mm	5.5 - 6.5mm
E16-275	7.0mm	6 - 7mm
E16-295	7.5mm	6.5 - 7.5mm
E16-314	8.0mm	7 - 8mm
E16-334	8.5mm	7.5 - 8.5mm
E16-354	9.0mm	8 - 9mm
E16-374	9.5mm	8.5 - 9.5mm
E16-393	10.0mm	9 - 10mm

### ER16 COLLET SETS

E16-SET-12	12 Piece Set: 1/16" - 13/32" by 1/32nds
E16-SET-09-MM	9 Piece Set: 1.5mm - 10.0mm by 1mm

Note: See dimensional data for ER16 Collets on page 59.



### Coolant-Thru

Our patented Coolant Collets are designed for use with cylindrical shank tools (no flats). Cutting tool should be inserted the full length of the collet. If these conditions are not met, coolant leakage may result. Seals up to maximum coolant pressure of 2900 psi. Steel-sealed and mechanically sealed by design.

Size range: 3/32 - 13/32"  
(0.094 - 0.406")

Size Range: 3.0 - 10.0mm  
(0.039 - 0.394")

### INCH COOLANT-THRU

Part Number	Size	Collapse Range
E16-006(C)	3/32"	0.09 - 0.094"
E16-007(C)	7/64"	0.105 - 0.109"
E16-008(C)	1/8"	0.121 - 0.125"
E16-009(C)	9/64"	0.137 - 0.141"
E16-010(C)	5/32"	0.152 - 0.156"
E16-011(C)	11/64"	0.168 - 0.172"
E16-012(C)	3/16"	0.183 - 0.188"
E16-013(C)	13/64"	0.199 - 0.203"
E16-014(C)	7/32"	0.215 - 0.219"
E16-015(C)	15/64"	0.215 - 0.234"
E16-016(C)	1/4"	0.23 - 0.25"
E16-017(C)	17/64"	0.246 - 0.266"
E16-018(C)	9/32"	0.262 - 0.281"
E16-019(C)	19/64"	0.277 - 0.297"
E16-020(C)	5/16"	0.293 - 0.313"
E16-021(C)	21/64"	0.308 - 0.328"
E16-022(C)	11/32"	0.324 - 0.344"
E16-023(C)	23/64"	0.34 - 0.359"
E16-024(C)	3/8"	0.355 - 0.375"
E16-025(C)	25/64"	0.371 - 0.391"
E16-026(C)	13/32"	0.387 - 0.406"

### METRIC COOLANT-THRU

Part Number	Size	Collapse Range
E16-118(C)	3.0mm	2.9 - 3mm
E16-157(C)	4.0mm	3.9 - 4mm
E16-177(C)	4.5mm	4.4 - 4.5mm
E16-196(C)	5.0mm	4.9 - 5mm
E16-216(C)	5.5mm	5.4 - 5.5mm
E16-236(C)	6.0mm	5.5 - 6mm
E16-255(C)	6.5mm	6 - 6.5mm
E16-275(C)	7.0mm	6.5 - 7mm
E16-295(C)	7.5mm	7 - 7.5mm
E16-314(C)	8.0mm	7.5 - 8mm
E16-334(C)	8.5mm	8 - 8.5mm
E16-354(C)	9.0mm	8.5 - 9mm
E16-374(C)	9.5mm	9 - 9.5mm
E16-393(C)	10.0mm	9.5 - 10mm

### ER16 COOLANT COLLET SETS

E16-SET-11(C)	11 Piece Set: 3/32" - 13/32" by 1/32nds
E16-SET-13(C)-MM	13 Piece Set: 3.9mm - 10.0mm by 0.5mm
E16-SET-15(C)	15 Piece Set: 3/16" - 11/32" by 1/64ths

# ER COLLET CHUCKS



## ER20 COLLETS



### Precision Standard

Precision slots allow for even distribution of clamping pressure and minimal run out.



### Coolant-Thru

Our patented Coolant Collets are designed for use with cylindrical shank tools (no flats). Cutting tool should be inserted the full length of the collet. If these conditions are not met, coolant leakage may result. Seals up to maximum coolant pressure of 2900 psi. Steel-sealed and mechanically sealed by design.

Size Range: 1/16 - 1/2"  
(0.062 - 0.500")

Size Range: 2.0 - 13.0mm  
(0.079 - 0.512")

Size Range: 5/32 - 1/2"  
(0.156 - 0.500")

Size Range: 5.0 - 13.0mm  
(0.197 - 0.512")

### INCH

Part Number	Size	Collapse Range
E20-004	1/16"	0.043 - 0.063"
E20-006	3/32"	0.074 - 0.094"
E20-008	1/8"	0.105 - 0.125"
E20-010	5/32"	0.136 - 0.156"
E20-012	3/16"	0.148 - 0.188"
E20-014	7/32"	0.179 - 0.219"
E20-016	1/4"	0.211 - 0.25"
E20-018	9/32"	0.242 - 0.281"
E20-020	5/16"	0.273 - 0.313"
E20-022	11/32"	0.304 - 0.344"
E20-024	3/8"	0.336 - 0.375"
E20-026	13/32"	0.367 - 0.406"
E20-028	7/16"	0.398 - 0.438"
E20-030	15/32"	0.429 - 0.469"
E20-032	1/2"	0.461 - 0.5"

### METRIC

Part Number	Size	Collapse Range
E20-078	2.0mm	1.5 - 2mm
E20-098	2.5mm	2 - 2.5mm
E20-118	3.0mm	2.5 - 3mm
E20-137	3.5mm	3 - 3.5mm
E20-157	4.0mm	3.5 - 4mm
E20-177	4.5mm	4 - 4.5mm
E20-196	5.0mm	4 - 5mm
E20-236	6.0mm	5 - 6mm
E20-275	7.0mm	6 - 7mm
E20-314	8.0mm	7 - 8mm
E20-354	9.0mm	8 - 9mm
E20-393	10.0mm	9 - 10mm
E20-433	11.0mm	10 - 11mm
E20-452	11.5mm	10.5 - 11.5mm
E20-472	12.0mm	11 - 12mm
E20-511	13.0mm	12 - 13mm

### INCH COOLANT-THRU

Part Number	Size	Collapse Range
E20-010(C)	5/32"	0.152 - 0.156"
E20-011(C)	11/64"	0.168 - 0.172"
E20-012(C)	3/16"	0.183 - 0.188"
E20-013(C)	13/64"	0.199 - 0.203"
E20-014(C)	7/32"	0.199 - 0.219"
E20-015(C)	15/64"	0.215 - 0.234"
E20-016(C)	1/4"	0.23 - 0.25"
E20-017(C)	17/64"	0.246 - 0.266"
E20-018(C)	9/32"	0.262 - 0.281"
E20-019(C)	19/64"	0.277 - 0.297"
E20-020(C)	5/16"	0.293 - 0.313"
E20-021(C)	21/64"	0.308 - 0.328"
E20-022(C)	11/32"	0.324 - 0.344"
E20-023(C)	23/64"	0.34 - 0.359"
E20-024(C)	3/8"	0.355 - 0.375"
E20-025(C)	25/64"	0.371 - 0.391"
E20-026(C)	13/32"	0.387 - 0.406"
E20-027(C)	27/64"	0.402 - 0.422"
E20-028(C)	7/16"	0.418 - 0.438"
E20-029(C)	29/64"	0.433 - 0.453"
E20-030(C)	15/32"	0.449 - 0.469"
E20-031(C)	31/64"	0.465 - 0.484"
E20-032(C)	1/2"	0.48 - 0.5"

### METRIC COOLANT-THRU

Part Number	Size	Collapse Range
E20-196(C)	5.0mm	4.9 - 5mm
E20-216(C)	5.5mm	5.4 - 5.5mm
E20-236(C)	6.0mm	5.5 - 6mm
E20-255(C)	6.5mm	6 - 6.5mm
E20-275(C)	7.0mm	6.5 - 7mm
E20-295(C)	7.5mm	7 - 7.5mm
E20-314(C)	8.0mm	7.5 - 8mm
E20-334(C)	8.5mm	8 - 8.5mm
E20-354(C)	9.0mm	8.5 - 9mm
E20-374(C)	9.5mm	9 - 9.5mm
E20-393(C)	10.0mm	9.5 - 10mm
E20-413(C)	10.5mm	10 - 10.5mm
E20-433(C)	11.0mm	10.5 - 11mm
E20-452(C)	11.5mm	11 - 11.5mm
E20-472(C)	12.0mm	11.5 - 12mm
E20-492(C)	12.5mm	12 - 12.5mm
E20-511(C)	13.0mm	12.5 - 13mm

### ER20 COLLET SETS

E20-SET-15	15 Piece Set: 1/16" - 1/2" by 1/32nds
E20-SET-11-MM	11 Piece Set: 3.0mm - 13.0mm by 1mm

### ER20 COOLANT COLLET SETS

E20-SET-12(C)	12 Piece Set: 5/32" - 1/2" by 1/32nds
E20-SET-17(C)-MM	17 Piece Set: 4.9mm - 13.0mm by 0.5mm

Note: See dimensional data for ER20 Collets on page 59.

## ER25 COLLETS



### Precision Standard

Precision slots allow for even distribution of clamping pressure and minimal run out.

Size Range: 1/16 - 5/8"  
(0.062 - 0.625")

Size Range: 2.0 - 16.0mm  
(0.079 - 0.630")

### INCH

Part Number	Size	Collapse Range
E25-004	1/16"	0.043 - 0.063"
E25-006	3/32"	0.074 - 0.094"
E25-008	1/8"	0.105 - 0.125"
E25-010	5/32"	0.136 - 0.156"
E25-012	3/16"	0.148 - 0.188"
E25-014	7/32"	0.179 - 0.219"
E25-016	1/4"	0.211 - 0.25"
E25-018	9/32"	0.242 - 0.281"
E25-020	5/16"	0.273 - 0.313"
E25-022	11/32"	0.304 - 0.344"
E25-024	3/8"	0.336 - 0.375"
E25-026	13/32"	0.367 - 0.406"
E25-028	7/16"	0.398 - 0.438"
E25-030	15/32"	0.429 - 0.469"
E25-032	1/2"	0.461 - 0.5"
E25-034	17/32"	0.492 - 0.531"
E25-036	9/16"	0.523 - 0.563"
E25-038	19/32"	0.554 - 0.594"
E25-040	5/8"	0.586 - 0.625"

### METRIC

Part Number	Size	Collapse Range
E25-078	2.0mm	1.5 - 2mm
E25-118	3.0mm	2.5 - 3mm
E25-137	3.5mm	3 - 3.5mm
E25-157	4.0mm	3.5 - 4mm
E25-196	5.0mm	4 - 5mm
E25-236	6.0mm	5 - 6mm
E25-275	7.0mm	6 - 7mm
E25-314	8.0mm	7 - 8mm
E25-354	9.0mm	8 - 9mm
E25-393	10.0mm	9 - 10mm
E25-433	11.0mm	10 - 11mm
E25-452	11.5mm	10.5 - 11.5mm
E25-472	12.0mm	11 - 12mm
E25-511	13.0mm	12 - 13mm
E25-551	14.0mm	13 - 14mm
E25-570	14.5mm	13.5 - 14.5mm
E25-590	15.0mm	14 - 15mm
E25-629	16.0mm	15 - 16mm

### ER25 COLLET SETS

E25-SET-19	19 Piece Set: 1/16" - 5/8" by 1/32nds
E25-SET-14-MM	14 Piece Set: 1.5mm - 16.0mm by 1mm

Note: See dimensional data for ER25 Collets on page 59.



### Coolant-Thru

Our patented Coolant Collets are designed for use with cylindrical shank tools (no flats). Cutting tool should be inserted the full length of the collet. If these conditions are not met, coolant leakage may result. Seals up to maximum coolant pressure of 2900 psi. Steel-sealed and mechanically sealed by design.

Size Range: 7/32 - 5/8"  
(0.219 - 0.625")

Size Range: 6.0 - 16.0mm  
(0.236 - 0.630")

### INCH COOLANT-THRU

Part Number	Size	Collapse Range
E25-014(C)	7/32"	0.215 - 0.219"
E25-015(C)	15/64"	0.23 - 0.234"
E25-016(C)	1/4"	0.23 - 0.25"
E25-017(C)	17/64"	0.246 - 0.266"
E25-018(C)	9/32"	0.262 - 0.281"
E25-019(C)	19/64"	0.277 - 0.297"
E25-020(C)	5/16"	0.293 - 0.313"
E25-021(C)	21/64"	0.308 - 0.328"
E25-022(C)	11/32"	0.324 - 0.344"
E25-023(C)	23/64"	0.34 - 0.359"
E25-024(C)	3/8"	0.355 - 0.375"
E25-025(C)	25/64"	0.371 - 0.391"
E25-026(C)	13/32"	0.387 - 0.406"
E25-027(C)	27/64"	0.402 - 0.422"
E25-028(C)	7/16"	0.418 - 0.438"
E25-029(C)	29/64"	0.433 - 0.453"
E25-030(C)	15/32"	0.449 - 0.469"
E25-031(C)	31/64"	0.465 - 0.484"
E25-032(C)	1/2"	0.48 - 0.5"
E25-033(C)	33/64"	0.496 - 0.516"
E25-034(C)	17/32"	0.512 - 0.531"
E25-035(C)	35/64"	0.527 - 0.547"
E25-036(C)	9/16"	0.543 - 0.563"
E25-037(C)	37/64"	0.558 - 0.578"
E25-038(C)	19/32"	0.574 - 0.594"
E25-039(C)	39/64"	0.59 - 0.609"
E25-040(C)	5/8"	0.605 - 0.625"

### METRIC COOLANT-THRU

Part Number	Size	Collapse Range
E25-236(C)	6.0mm	5.5 - 6mm
E25-255(C)	6.5mm	6 - 6.5mm
E25-275(C)	7.0mm	6.5 - 7mm
E25-295(C)	7.5mm	7 - 7.5mm
E25-314(C)	8.0mm	7.5 - 8mm
E25-334(C)	8.5mm	8 - 8.5mm
E25-354(C)	9.0mm	8.5 - 9mm
E25-374(C)	9.5mm	9 - 9.5mm
E25-393(C)	10.0mm	9.5 - 10mm
E25-413(C)	10.5mm	10 - 10.5mm
E25-433(C)	11.0mm	10.5 - 11mm
E25-452(C)	11.5mm	11 - 11.5mm
E25-472(C)	12.0mm	11.5 - 12mm
E25-492(C)	12.5mm	12 - 12.5mm
E25-511(C)	13.0mm	12.5 - 13mm
E25-531(C)	13.5mm	13 - 13.5mm
E25-551(C)	14.0mm	13.5 - 14mm
E25-570(C)	14.5mm	14 - 14.5mm
E25-590(C)	15.0mm	14.5 - 15mm
E25-610(C)	15.5mm	15 - 15.5mm
E25-629(C)	16.0mm	15.5 - 16mm

### ER25 COOLANT COLLET SETS

E25-SET-13(C)	13 Piece Set: 1/4" - 5/8" by 1/32nds
E25-SET-21(C)-MM	21 Piece Set: 5.5mm - 16.0mm by 0.5mm

# ER COLLET CHUCKS



ER COLLET CHUCKS

## ER32 COLLETS



### Precision Standard

Precision slots allow for even distribution of clamping pressure and minimal run out.

Size Range: 1/8" - 25/32"  
(0.125 - 0.781")

Size Range: 3.0 - 20.0mm  
(0.118 - 0.787")

### INCH

Part Number	Size	Collapse Range
E32-008	1/8"	0.105 - 0.125"
E32-010	5/32"	0.136 - 0.156"
E32-012	3/16"	0.148 - 0.188"
E32-014	7/32"	0.179 - 0.219"
E32-016	1/4"	0.211 - 0.25"
E32-018	9/32"	0.242 - 0.281"
E32-020	5/16"	0.273 - 0.313"
E32-022	11/32"	0.304 - 0.344"
E32-024	3/8"	0.336 - 0.375"
E32-026	13/32"	0.367 - 0.406"
E32-028	7/16"	0.398 - 0.438"
E32-030	15/32"	0.429 - 0.469"
E32-032	1/2"	0.461 - 0.5"
E32-034	17/32"	0.492 - 0.531"
E32-036	9/16"	0.523 - 0.563"
E32-038	19/32"	0.554 - 0.594"
E32-040	5/8"	0.586 - 0.625"
E32-042	21/32"	0.617 - 0.656"
E32-044	11/16"	0.648 - 0.688"
E32-046	23/32"	0.679 - 0.719"
E32-048	3/4"	0.711 - 0.75"
E32-050	25/32"	0.742 - 0.781"

### METRIC

Part Number	Size	Collapse Range
E32-118	3.0mm	2.5 - 3mm
E32-137	3.5mm	3 - 3.5mm
E32-157	4.0mm	3.5 - 4mm
E32-196	5.0mm	4 - 5mm
E32-236	6.0mm	5 - 6mm
E32-275	7.0mm	6 - 7mm
E32-314	8.0mm	7 - 8mm
E32-354	9.0mm	8 - 9mm
E32-393	10.0mm	9 - 10mm
E32-433	11.0mm	10 - 11mm
E32-452	11.5mm	10.5 - 11.5mm
E32-472	12.0mm	11 - 12mm
E32-511	13.0mm	12 - 13mm
E32-551	14.0mm	13 - 14mm
E32-590	15.0mm	14 - 15mm
E32-629	16.0mm	15 - 16mm
E32-669	17.0mm	16 - 17mm
E32-688	17.5mm	16.5 - 17.5mm
E32-708	18.0mm	17 - 18mm
E32-748	19.0mm	18 - 19mm
E32-767	19.5mm	18.5 - 19.5mm
E32-787	20.0mm	19 - 20mm

### ER32 COLLET SETS

E32-SET-21	21 Piece Set: 1/8" - 3/4" by 1/32nds
E32-SET-18-MM	18 Piece Set: 1.5mm - 20.0mm by 1.0mm

Note: See dimensional data for ER32 Collets on page 59.



### Coolant-Thru

Our patented Coolant Collets are designed for use with cylindrical shank tools (no flats). Cutting tool should be inserted the full length of the collet. If these conditions are not met, coolant leakage may result. Seals up to maximum coolant pressure of 2900 psi. Steel-sealed and mechanically sealed by design.

Size Range: 1/4 - 25/32"  
(0.250 - 0.781")

Size Range: 7.5 - 20.0mm  
(0.394 - 0.295")

### INCH COOLANT-THRU

Part Number	Size	Collapse Range
E32-016(C)	1/4"	0.246 - 0.25"
E32-017(C)	17/64"	0.262 - 0.266"
E32-018(C)	9/32"	0.277 - 0.281"
E32-019(C)	19/64"	0.293 - 0.297"
E32-020(C)	5/16"	0.308 - 0.313"
E32-021(C)	21/64"	0.308 - 0.328"
E32-022(C)	11/32"	0.324 - 0.344"
E32-023(C)	23/64"	0.34 - 0.359"
E32-024(C)	3/8"	0.355 - 0.375"
E32-025(C)	25/64"	0.371 - 0.391"
E32-026(C)	13/32"	0.387 - 0.406"
E32-027(C)	27/64"	0.402 - 0.422"
E32-028(C)	7/16"	0.418 - 0.438"
E32-029(C)	29/64"	0.433 - 0.453"
E32-030(C)	15/32"	0.449 - 0.469"
E32-031(C)	31/64"	0.465 - 0.484"
E32-032(C)	1/2"	0.48 - 0.5"
E32-033(C)	33/64"	0.496 - 0.516"
E32-034(C)	17/32"	0.512 - 0.531"
E32-035(C)	35/64"	0.527 - 0.547"
E32-036(C)	9/16"	0.543 - 0.563"
E32-037(C)	37/64"	0.558 - 0.578"
E32-038(C)	19/32"	0.574 - 0.594"
E32-039(C)	39/64"	0.59 - 0.609"
E32-040(C)	5/8"	0.605 - 0.625"
E32-041(C)	41/64"	0.621 - 0.641"
E32-042(C)	21/32"	0.637 - 0.656"
E32-043(C)	43/64"	0.652 - 0.672"
E32-044(C)	11/16"	0.668 - 0.688"
E32-045(C)	45/64"	0.683 - 0.703"
E32-046(C)	23/32"	0.699 - 0.719"
E32-047(C)	47/64"	0.715 - 0.734"
E32-048(C)	3/4"	0.73 - 0.75"
E32-049(C)	49/64"	0.746 - 0.766"
E32-050(C)	25/32"	0.762 - 0.781"

### METRIC COOLANT-THRU

Part Number	Size	Collapse Range
E32-294(C)	7.5mm	7.4 - 7.5mm
E32-314(C)	8.0mm	7.9 - 8mm
E32-354(C)	9.0mm	8.5 - 9mm
E32-364(C)	9.25mm	8.75 - 9.25mm
E32-374(C)	9.5mm	9 - 9.5mm
E32-393(C)	10.0mm	9.5 - 10mm
E32-413(C)	10.5mm	10 - 10.5mm
E32-433(C)	11.0mm	10.5 - 11mm
E32-452(C)	11.5mm	11 - 11.5mm
E32-472(C)	12.0mm	11.5 - 12mm
E32-492(C)	12.5mm	12 - 12.5mm
E32-511(C)	13.0mm	12.5 - 13mm
E32-531(C)	13.5mm	13 - 13.5mm
E32-551(C)	14.0mm	13.5 - 14mm
E32-561(C)	14.25mm	13.75 - 14.25mm
E32-570(C)	14.5mm	14 - 14.5mm
E32-590(C)	15.0mm	14.5 - 15mm
E32-610(C)	15.5mm	15 - 15.5mm
E32-629(C)	16.0mm	15.5 - 16mm
E32-649(C)	16.5mm	16 - 16.5mm
E32-669(C)	17.0mm	16.5 - 17mm
E32-688(C)	17.5mm	17 - 17.5mm
E32-708(C)	18.0mm	17.5 - 18mm
E32-728(C)	18.5mm	18 - 18.5mm
E32-748(C)	19.0mm	18.5 - 19mm
E32-767(C)	19.5mm	19 - 19.5mm
E32-787(C)	20.0mm	19.5 - 20mm

### ER32 COOLANT COLLET SETS

E32-SET-17(C)	17 Piece Set: 1/4" - 3/4" by 1/32nds
E32-SET-21(C)-MM	21 Piece Set: 9.5mm - 20.0mm by 0.5mm

## ER40 COLLETS



### Precision Standard

Precision slots allow for even distribution of clamping pressure and minimal run out.

Size Range: 5/32 - 1"  
(0.156 - 1.000")

Size Range: 4.0 - 26.0mm  
(0.157 - 1.024")

### INCH

Part Number	Size	Collapse Range
E40-010	5/32"	0.136 - 0.156"
E40-012	3/16"	0.148 - 0.188"
E40-014	7/32"	0.179 - 0.219"
E40-016	1/4"	0.211 - 0.25"
E40-018	9/32"	0.242 - 0.281"
E40-020	5/16"	0.273 - 0.313"
E40-022	11/32"	0.304 - 0.344"
E40-024	3/8"	0.336 - 0.375"
E40-026	13/32"	0.367 - 0.406"
E40-028	7/16"	0.398 - 0.438"
E40-030	15/32"	0.429 - 0.469"
E40-032	1/2"	0.461 - 0.5"
E40-034	17/32"	0.492 - 0.531"
E40-036	9/16"	0.523 - 0.563"
E40-038	19/32"	0.554 - 0.594"
E40-040	5/8"	0.586 - 0.625"
E40-042	21/32"	0.617 - 0.656"
E40-044	11/16"	0.648 - 0.688"
E40-046	23/32"	0.679 - 0.719"
E40-048	3/4"	0.711 - 0.75"
E40-050	25/32"	0.742 - 0.781"
E40-052	13/16"	0.773 - 0.813"
E40-054	27/32"	0.804 - 0.844"
E40-056	7/8"	0.836 - 0.875"
E40-058	29/32"	0.867 - 0.906"
E40-060	15/16"	0.898 - 0.938"
E40-062	31/32"	0.929 - 0.969"
E40-064	1"	0.961 - 1"

### METRIC

Part Number	Size	Collapse Range
E40-157	4.0mm	3.5 - 4mm
E40-196	5.0mm	4 - 5mm
E40-216	5.5mm	4.5 - 5.5mm
E40-236	6.0mm	5 - 6mm
E40-255	6.5mm	5.5 - 6.5mm
E40-275	7.0mm	6 - 7mm
E40-295	7.5mm	6.5 - 7.5mm
E40-314	8.0mm	7 - 8mm
E40-334	8.5mm	7.5 - 8.5mm
E40-354	9.0mm	8 - 9mm
E40-374	9.5mm	8.5 - 9.5mm
E40-393	10.0mm	9 - 10mm
E40-413	10.5mm	9.5 - 10.5mm
E40-433	11.0mm	10 - 11mm
E40-452	11.5mm	10.5 - 11.5mm
E40-472	12.0mm	11 - 12mm
E40-492	12.5mm	11.5 - 12.5mm
E40-511	13.0mm	12 - 13mm
E40-531	13.5mm	12.5 - 13.5mm
E40-551	14.0mm	13 - 14mm
E40-570	14.5mm	13.5 - 14.5mm
E40-590	15.0mm	14 - 15mm
E40-610	15.5mm	14.5 - 15.5mm
E40-629	16.0mm	15 - 16mm
E40-649	16.5mm	15.5 - 16.5mm
E40-669	17.0mm	16 - 17mm
E40-688	17.5mm	16.5 - 17.5mm
E40-708	18.0mm	17 - 18mm
E40-728	18.5mm	17.5 - 18.5mm
E40-748	19.0mm	18 - 19mm
E40-767	19.5mm	18.5 - 19.5mm
E40-787	20.0mm	19 - 20mm
E40-807	20.5mm	19.5 - 20.5mm
E40-826	21.0mm	20 - 21mm
E40-866	22.0mm	21 - 22mm
E40-905	23.0mm	22 - 23mm
E40-944	24.0mm	23 - 24mm
E40-984	25.0mm	24 - 25mm
E40-1003	25.5mm	24.5 - 25.5mm
E40-1023	26.0mm	25 - 26mm

### ER40 COLLET SETS

E40-SET-25	25 Piece Set: 1/4" - 1" by 1/32nds
E40-SET-23-MM	23 Piece Set: 3.5mm - 26.0mm by 1.0mm

Note: See dimensional data for ER40 Collets on page 59.



### Coolant-Thru

Our patented Coolant Collets are designed for use with cylindrical shank tools (no flats). Cutting tool should be inserted the full length of the collet. If these conditions are not met, coolant leakage may result. Seals up to maximum coolant pressure of 2900 psi. Steel-sealed and mechanically sealed by design.

Size Range: 5/16 - 5/8"  
(0.312 - 0.625")

Size Range: 10.0 - 26.0mm  
(0.394 - 1.024")

### INCH COOLANT-THRU

Part Number	Size	Collapse Range
E40-020(C)	5/16"	0.293 - 0.313"
E40-024(C)	3/8"	0.355 - 0.375"
E40-028(C)	7/16"	0.418 - 0.438"
E40-032(C)	1/2"	0.48 - 0.5"
E40-036(C)	9/16"	0.543 - 0.563"
E40-040(C)	5/8"	0.605 - 0.625"

### METRIC COOLANT-THRU

Part Number	Size	Collapse Range
E40-393(C)	10.0mm	9.5 - 10mm
E40-413(C)	10.5mm	10 - 10.5mm
E40-433(C)	11.0mm	10.5 - 11mm
E40-452(C)	11.5mm	11 - 11.5mm
E40-472(C)	12.0mm	11.5 - 12mm
E40-492(C)	12.5mm	12 - 12.5mm
E40-511(C)	13.0mm	12.5 - 13mm
E40-531(C)	13.5mm	13 - 13.5mm
E40-551(C)	14.0mm	13.5 - 14mm
E40-570(C)	14.5mm	14 - 14.5mm
E40-590(C)	15.0mm	14.5 - 15mm
E40-610(C)	15.5mm	15 - 15.5mm
E40-629(C)	16.0mm	15.5 - 16mm
E40-649(C)	16.5mm	16 - 16.5mm
E40-669(C)	17.0mm	16.5 - 17mm
E40-688(C)	17.5mm	17 - 17.5mm
E40-708(C)	18.0mm	17.5 - 18mm
E40-728(C)	18.5mm	18 - 18.5mm
E40-748(C)	19.0mm	18.5 - 19mm
E40-767(C)	19.5mm	19 - 19.5mm
E40-787(C)	20.0mm	19.5 - 20mm
E40-807(C)	20.5mm	20 - 20.5mm
E40-826(C)	21.0mm	20.5 - 21mm
E40-846(C)	21.5mm	21 - 21.5mm
E40-866(C)	22.0mm	21.5 - 22mm
E40-885(C)	22.5mm	22 - 22.5mm
E40-905(C)	23.0mm	22.5 - 23mm
E40-925(C)	23.5mm	23 - 23.5mm
E40-944(C)	24.0mm	23.5 - 24mm
E40-964(C)	24.5mm	24 - 24.5mm
E40-984(C)	25.0mm	24.5 - 25mm
E40-1003(C)	25.5mm	25 - 25.5mm
E40-1023(C)	26.0mm	25.5 - 26mm

### ER40 COOLANT COLLET SETS

E40-SET-6(C)	6 Piece Set: 5/16" - 5/8" by 1/32nds
E40-SET-33(C)-MM	33 Piece Set: 10.0mm - 26.0mm by 0.5mm

# ER COLLET CHUCKS



## ER TAP COLLETS

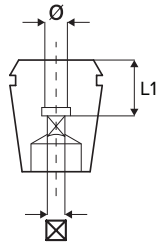

ER Tap Collets feature a unique design that incorporates an internal square drive with our popular ER Series Collets. The square drive matches the tap square, providing a tight fit for all rigid tapping applications.

*Note: Diameter and Square size are in accordance with U.S. Standard Taps.*

Part Number	ER Series	Tap Inch Style	Tap Metric Size	L1 (mm)	ø	⊠
ET16-138	ER16	-	M3, M5	18	0.138"	0.106"
ET16-157	ER16	-	M3.5	19	0.157"	0.118"
ET16-168	ER16	#8, 5/32"	M4	15	0.168"	0.131"
ET16-177	ER16	-	M4, M6	18	0.177"	0.134"
ET16-194	ER16	#10, 3/16"	M4.5, M5	15	0.194"	0.152"
ET16-197	ER16	-	M5	18	0.197"	0.157"
ET16-220	ER16	#12, 7/32"	-	15	0.220"	0.165"
ET16-236	ER16	-	M5, M6, M8	18	0.236"	0.193"
ET16-255	ER16	#14, 1/4"	M6, M6.5	22	0.255"	0.191"
ET16-275	ER16	-	M10	18	0.276"	0.217"
ET16-315	ER16	-	M8, M10	22	0.315"	0.244"
ET20-138	ER20	-	M3, M5	20	0.138"	0.106"
ET20-157	ER20	-	M3.5	18	0.157"	0.118"
ET20-168	ER20	#8, 5/32"	M4	15	0.168"	0.131"
ET20-177	ER20	-	M4, M6	18	0.177"	0.134"
ET20-194	ER20	#10, 3/16"	M4.5, M5	15	0.194"	0.152"
ET20-197	ER20	-	M5	18	0.197"	0.157"
ET20-220	ER20	#12, 7/32"	-	15	0.220"	0.165"
ET20-236	ER20	-	M6	20	0.236"	0.193"
ET20-255	ER20	#14, 1/4"	M6, M6.5	20	0.255"	0.191"
ET20-275	ER20	-	M10	18	0.276"	0.217"
ET20-315	ER20	-	M8, M10	22	0.315"	0.244"
ET20-318	ER20	5/16"	M7, M6.5, M8	20	0.318"	0.238"
ET20-323	ER20	7/16"	-	20	0.323"	0.242"
ET20-354	ER20	-	M12	22	0.354"	0.276"
ET20-367	ER20	1/2"	M12, M12.5	25	0.367"	0.275"
ET20-381	ER20	3/8"	M10	20	0.381"	0.286"
ET20-394	ER20	-	M10	22	0.394"	0.315"
ET25-138	ER25	-	M3, M5	18	0.138"	0.106"
ET25-157	ER25	-	M3.5	18	0.157"	0.118"
ET25-168	ER25	#8, 5/32"	M4	15	0.168"	0.131"
ET25-177	ER25	-	M4, M6	18	0.177"	0.134"
ET25-194	ER25	#10, 3/16"	M4.5, M5	15	0.194"	0.152"
ET25-197	ER25	-	M5	18	0.197"	0.157"
ET25-220	ER25	#12, 7/32"	-	15	0.220"	0.165"
ET25-236	ER25	-	M5, M6, M8	22	0.236"	0.193"
ET25-255	ER25	#14, 1/4"	M6, M6.5	20	0.255"	0.191"
ET25-275	ER25	-	M10	22	0.276"	0.217"
ET25-315	ER25	-	M8, M10	22	0.315"	0.244"
ET25-318	ER25	5/16"	M7, M6.5, M8	20	0.318"	0.238"
ET25-323	ER25	7/16"	-	20	0.323"	0.242"
ET25-354	ER25	-	M12	22	0.354"	0.276"
ET25-367	ER25	1/2"	M12, M12.5	25	0.367"	0.275"
ET25-381	ER25	3/8"	M10	20	0.381"	0.286"
ET25-394	ER25	-	M10	25	0.394"	0.315"
ET25-429	ER25	9/16"	M14	25	0.429"	0.322"
ET25-433	ER25	-	M14	25	0.433"	0.354"
ET25-437	ER25	1/8" NPT(L)	-	18	0.437"	0.328"
ET25-472	ER25	-	M16	25	0.472"	0.354"
ET25-480	ER25	5/8"	M16	25	0.480"	0.360"

## ER TAP COLLETS (CONTINUED)

Part Number	ER Series	Tap Inch Style	Tap Metric Size	L1 (mm)	ø	⊠
ET32-157	ER32	-	M3.5	18	0.157"	0.118"
ET32-168	ER32	#8, 5/32"	M4	15	0.168"	0.131"
ET32-177	ER32	-	M4, M6	18	0.177"	0.134"
ET32-194	ER32	#10, 3/16"	M4.5, M5	15	0.194"	0.152"
ET32-197	ER32	-	M5	18	0.197"	0.157"
ET32-220	ER32	#12, 7/32"	-	15	0.220"	0.165"
ET32-236	ER32	-	M5, M6, M8	18	0.236"	0.193"
ET32-255	ER32	#14, 1/4"	M6, M6.5	20	0.255"	0.191"
ET32-275	ER32	-	M10	23	0.276"	0.217"
ET32-315	ER32	-	M8, M10	22	0.315"	0.244"
ET32-318	ER32	5/16"	M7, M6.5, M8	20	0.318"	0.238"
ET32-323	ER32	7/16"	-	20	0.323"	0.242"
ET32-354	ER32	-	M12	23	0.354"	0.276"
ET32-367	ER32	1/2"	M12, M12.5	25	0.367"	0.275"
ET32-381	ER32	3/8"	M10	20	0.381"	0.286"
ET32-394	ER32	-	M10	25	0.394"	0.315"
ET32-429	ER32	9/16"	M14	25	0.429"	0.322"
ET32-433	ER32	-	M14	25	0.433"	0.354"
ET32-437	ER32	1/8" NPT(L)	-	18	0.437"	0.328"
ET32-472	ER32	-	M16	25	0.472"	0.354"
ET32-480	ER32	5/8"	M16	25	0.480"	0.360"
ET32-542	ER32	11/16"	M18	30	0.542"	0.406"
ET32-551	ER32	-	M18	25	0.551"	0.433"
ET32-562	ER32	1/4" NPT	-	18	0.562"	0.421"
ET32-590	ER32	3/4"	-	30	0.590"	0.442"
ET32-630	ER32	-	M20	25	0.630"	0.472"
ET32-652	ER32	13/16"	M20	30	0.652"	0.489"
ET32-709	ER32	-	M22, M24	25	0.709"	0.571"
ET32-M12	ER32	-	M12	22	0.335"	0.256"
ET40-236	ER40	-	M5, M6, M8	18	0.236"	0.193"
ET40-255	ER40	#14, 1/4"	M6, M6.5	25	0.255"	0.191"
ET40-275	ER40	-	M10	18	0.276"	0.217"
ET40-315	ER40	-	M8, M10	22	0.315"	0.244"
ET40-318	ER40	5/16"	M7, M6.5, M8	25	0.318"	0.238"
ET40-323	ER40	7/16"	-	25	0.323"	0.242"
ET40-354	ER40	-	M12	22.5	0.354"	0.276"
ET40-367	ER40	1/2"	M12, M12.5	25	0.367"	0.275"
ET40-381	ER40	3/8"	M10	25	0.381"	0.286"
ET40-394	ER40	-	M10	25	0.394"	0.315"
ET40-429	ER40	9/16"	M14	25	0.429"	0.322"
ET40-433	ER40	-	M14	25	0.433"	0.354"
ET40-437	ER40	1/8" NPT(L)	-	18	0.437"	0.328"
ET40-472	ER40	-	M16	25	0.472"	0.354"
ET40-480	ER40	5/8"	M16	25	0.480"	0.360"
ET40-542	ER40	11/16"	M18	30	0.542"	0.406"
ET40-551	ER40	-	M18	25	0.551"	0.433"
ET40-562	ER40	1/4" NPT	-	18	0.562"	0.421"
ET40-590	ER40	3/4"	-	30	0.590"	0.442"
ET40-630	ER40	-	M20	25	0.630"	0.472"
ET40-652	ER40	13/16"	M20	30	0.652"	0.489"
ET40-687	ER40	1/2" NPT	-	18	0.687"	0.515"
ET40-697	ER40	7/8"	-	30	0.697"	0.523"
ET40-700	ER40	3/8" NPT	-	18	0.700"	0.531"
ET40-709	ER40	-	M22, M24	25	0.709"	0.571"
ET40-760	ER40	15/16"	M24	35	0.760"	0.570"
ET40-787	ER40	-	M27, M30	28	0.787"	0.630"
ET40-800	ER40	1"	M25	35	0.800"	0.600"

### ER TAP COLLET SETS

ET16-SET-04	4 Piece Set
ET20-SET-08	8 Piece Set
ET25-SET-10	20 Piece Set
ET32-SET-15	15 Piece Set
ET40-SET-17	17 Piece Set

# ER COLLET CHUCKS

## ER TAP COOLANT COLLETS

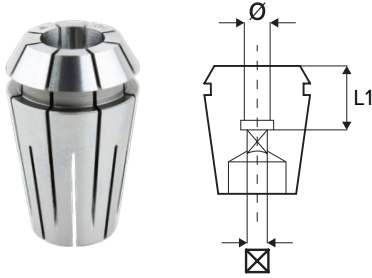

Lyndex-Nikken has now combined the versatility of our ER Tapping Collets with the popularity of our Coolant Collets to create our patented ER Coolant Tap Collets. Steel-sealed and mechanically sealed by design.

*Note: Diameter and Square size are in accordance with U.S. Standard Taps.*

Part Number	ER Series	Tap Inch Style	Tap Metric Size	L1 (mm)	Ø	⊠
ET16-255(C)	ER16	#14, 1/4"	M6, M6.5	22	0.255"	0.191"
ET16-318(C)	ER16	5/16"	M7, M6.5, M8	22	0.318"	0.238"
ET20-255(C)	ER20	#14, 1/4"	M6, M6.5	25	0.255"	0.191"
ET20-318(C)	ER20	5/16"	M7, M6.5, M8	25	0.318"	0.238"
ET20-323(C)	ER20	7/16"	-	25	0.323"	0.242"
ET20-367(C)	ER20	1/2"	M12, M12.5	25	0.367"	0.275"
ET20-381(C)	ER20	3/8"	M10	25	0.381"	0.286"
ET25-255(C)	ER25	#14, 1/4"	M6, M6.5	25	0.255"	0.191"
ET25-318(C)	ER25	5/16"	M7, M6.5, M8	25	0.318"	0.238"
ET25-323(C)	ER25	7/16"	-	25	0.323"	0.242"
ET25-367(C)	ER25	1/2"	M12, M12.5	25	0.367"	0.275"
ET25-381(C)	ER25	3/8"	M10	27	0.381"	0.286"
ET25-429(C)	ER25	9/16"	M14	25	0.429"	0.322"
ET25-480(C)	ER25	5/8"	M16	30	0.480"	0.360"
ET25-M8(C)	ER25	-	M8, M10	22	0.315"	0.244"
ET32-255(C)	ER32	#14, 1/4"	M6, M6.5	30	0.255"	0.191"
ET32-318(C)	ER32	5/16"	M7, M6.5, M8	25	0.318"	0.238"
ET32-323(C)	ER32	7/16"	-	25	0.323"	0.242"
ET32-354(C)	ER32	-	M12	23	0.354"	0.276"
ET32-367(C)	ER32	1/2"	M12, M12.5	25	0.367"	0.275"
ET32-381(C)	ER32	3/8"	M10	27	0.381"	0.286"
ET32-429(C)	ER32	9/16"	M14	25	0.429"	0.322"
ET32-433(C)	ER32	-	M14	25	0.433"	0.354"
ET32-480(C)	ER32	5/8"	M16	30	0.480"	0.360"
ET32-542(C)	ER32	11/16"	M18	30	0.542"	0.406"
ET32-590(C)	ER32	3/4"	-	35	0.590"	0.442"
ET32-652(C)	ER32	13/16"	M20	35	0.652"	0.489"
ET40-323(C)	ER40	7/16"	-	35	0.323"	0.242"
ET40-354(C)	ER40	-	M12	22.5	0.354"	0.276"
ET40-367(C)	ER40	1/2"	M12, M12.5	25	0.367"	0.275"
ET40-381(C)	ER40	3/8"	M10	27	0.381"	0.286"
ET40-429(C)	ER40	9/16"	M14	25	0.429"	0.322"
ET40-433(C)	ER40	-	M14	25	0.433"	0.354"
ET40-480(C)	ER40	5/8"	M16	30	0.480"	0.360"
ET40-542(C)	ER40	11/16"	M18	30	0.542"	0.406"
ET40-590(C)	ER40	3/4"	-	35	0.590"	0.442"
ET40-652(C)	ER40	13/16"	M20	35	0.652"	0.489"
ET40-697(C)	ER40	7/8"	M22	35	0.697"	0.523"
ET40-760(C)	ER40	15/16"	M24	38	0.760"	0.570"
ET40-800(C)	ER40	1"	M25	38	0.800"	0.600"

*Note: Seals up to a maximum coolant pressure of 2900 psi.*

## ER COLLET CHUCK ACCESSORIES

### ER COLLET RACK

Part Number	Description
<b>RACK-ER11/SK6</b>	ER11 Collet Rack, 35 collet capacity
<b>RACK-ER16/SK10</b>	ER16 Collet Rack, 24 collet capacity
<b>RACK-ER20/TAP</b>	ER20 Collet Rack, 24 collet capacity
<b>RACK-180DA/SK16/ER25</b>	ER25 Collet Rack, 30 collet capacity
<b>RACK-ER32/2TAP</b>	ER32 Collet Rack, 24 collet capacity



### REPLACEMENT NUT FOR ER COLLET CHUCK

Part Number	Description
<b>08-NANUT</b>	ER8 Nut
<b>E08-NUT-MINI</b>	ER8 Mini Nut
<b>E11-NUT</b>	ER11 Hex Nut
<b>E11-NUT-MINI</b>	ER11 Nut Mini
<b>E16-NUT</b>	ER16 Nut
<b>E16-NUT-G</b>	ER16 Nut Smooth
<b>E16-NUT-S</b>	ER16 Nut Hex
<b>E20-NUT</b>	ER20 Nut
<b>E20-NUT-G</b>	ER20 Nut Smooth
<b>E20-NUT-S</b>	ER20 Nut Solid
<b>E25-NUT</b>	ER25 Nut
<b>E25-NUT-G</b>	ER25 Nut Smooth
<b>E25-NUT-S</b>	ER25 Nut Solid
<b>E32-NUT</b>	ER32 Nut
<b>E32-NUT-G</b>	ER32 Nut Smooth
<b>E32-NUT-S</b>	ER32 Nut Solid
<b>E40-NUT</b>	ER40 Nut
<b>E40-NUT-G</b>	ER40 Nut Smooth
<b>E40-NUT-S</b>	ER40 Nut Solid
<b>E50-NUT-S</b>	ER50 Nut Solid
<b>NUT-ER32I</b>	ER32 Nut Hi-Q External Thread



### SPANNER WRENCH FOR ER COLLET CHUCK NUT

Part Number	Description
<b>08-NASPAN</b>	Wrench for ER8 Chuck Nut
<b>011-HEX</b>	Wrench for ER11 Chuck Nut
<b>016-SPAN</b>	Wrench for ER16 Chuck Nut
<b>020-SPAN</b>	Wrench for ER20 Chuck Nut
<b>025-SPAN</b>	Wrench for ER25 Chuck Nut
<b>032-SPAN</b>	Wrench for ER32 Chuck Nut
<b>040-SPAN</b>	Wrench for ER40 Chuck Nut
<b>FK-10</b>	Wrench for ER50 Chuck Nut



# ER COLLET CHUCKS



## ER COLLET CHUCK ACCESSORIES

### TORQUE WRENCHES

Part Number	Description
<b>TQW-025</b>	Torque Wrench 5-75 Ft. Lbs.
<b>TQW-150</b>	Torque Wrench 30-150 Ft. Lbs.



### TORQUE WRENCH (1 PIECE CONSTRUCTION)

Part Number	Description
<b>TQWS-E08M</b>	Used on E08-NUT-MINI
<b>TQWS-E11M</b>	Used on E11-NUT-MINI
<b>TQWS-E16M</b>	Used on E16-NUT-MINI
<b>TQWS-E20M</b>	Used on E20-NUT-MINI
<b>TQWS-E25M</b>	Used on E25-NUT-MINI

### TORQUE WRENCH ATTACHMENTS

Part Number	Description	Torque Wrench	Wrench Handle (Non-Torque)
<b>TQW-ER8NA</b>	ER8 Attachment for 08-NANUT	TQW-025	TQW-HANDLE14X18
<b>TQW-ER11HEX</b>	ER11 Attachment for E11-NUT	TQW-025	TQW-HANDLE14X18
<b>TQW-ER16/SK13(30)</b>	ER16 Attachment for E16-NUT	TQW-025 or TQW-150	TQW-HANDLE14X18
<b>TQW-ER16HEX</b>	ER16 Attachment for E16-NUT-S	TQW-025 or TQW-150	TQW-HANDLE14X18
<b>TQW-E16-G</b>	ER16 Attachment for E16-NUT-G	TQW-025 or TQW-150	TQW-HANDLE14X18
<b>TQW-ER20/TG50(35)</b>	ER20 Attachment for E20-NUT	TQW-025 or TQW-150	TQW-HANDLE14X18
<b>TQW-E20-G</b>	ER20 Attachment for E20-NUT-G	TQW-025 or TQW-150	TQW-HANDLE14X18
<b>TQW-ER25(40)</b>	ER25 Attachment for E25-NUT	TQW-150	TQW-HANDLE14X18
<b>TQW-E25-G</b>	ER25 Attachment for E25-NUT-G	TQW-150	TQW-HANDLE14X18
<b>TQW-ER32/SK20/TG75(50)</b>	ER32 Attachment for E32-NUT	TQW-150	TQW-HANDLE14X18
<b>TQW-E32-G</b>	ER32 Attachment for E32-NUT-G	TQW-150	TQW-HANDLE14X18
<b>TQW-ER40/C1(60)</b>	ER40 Attachment for E40-NUT	TQW-150	TQW-HANDLE14X18
<b>TQW-E40-G</b>	ER40 Attachment for E40-NUT-G	TQW-150	TQW-HANDLE14X18

### REPLACEMENT BACK UP SCREWS FOR ER COLLET CHUCK

Part Number	Description
<b>ER08-SCREW(C)</b>	ER8 Coolant-thru Backup Screws
<b>ER11-SCREW(C)</b>	ER11 Coolant-thru Backup Screws
<b>ER16-SCREW(C)</b>	ER16 Coolant-thru Backup Screws
<b>ER20-SCREW(C)</b>	ER20 Coolant-thru Backup Screws
<b>ER25-SCREW(C)</b>	ER25 Coolant-thru Backup Screws
<b>ER32-SCREW(C)</b>	ER32 Coolant-thru Backup Screws
<b>ER40-SCREW(C)</b>	ER40 Coolant-thru Backup Screws

Note: \*ER11-3 used for E16-EXT-625 Collet Chuck Extension.



### COOLANT TUBE WRENCHES FOR HSK/POLYGON HOLDERS

Part Number	Description
<b>HSK40-WRENCH</b>	Wrench for HSK40 Coolant Tube
<b>HSK63-WRENCH</b>	Wrench for HSK63 Coolant Tube
<b>HSK100-WRENCH</b>	Wrench for HSK100 Coolant Tube
<b>C3-WRENCH</b>	Wrench for C3 Coolant Tube
<b>C4-WRENCH</b>	Wrench for C4 Coolant Tube
<b>C5-WRENCH</b>	Wrench for C5 Coolant Tube
<b>C6-WRENCH</b>	Wrench for C6 Coolant Tube
<b>C8-WRENCH</b>	Wrench for C8 Coolant Tube



Note: Coolant Tube Wrenches are needed to remove or install coolant tubes in HSK toolholders.

### COOLANT TUBES FOR HSK/POLYGON HOLDERS

Part Number	Description
<b>HSK40-TUBE</b>	HSK40 Coolant Tube
<b>HSK63-TUBE</b>	HSK63 Coolant Tube
<b>HSK100-TUBE</b>	HSK100 Coolant Tube
<b>C3-TUBE</b>	C3 Coolant Tube
<b>C4-TUBE</b>	C4 Coolant Tube
<b>C5-TUBE</b>	C5 Coolant Tube
<b>C6-TUBE-1</b>	C6 Coolant Tube
<b>C8-TUBE</b>	C8 Coolant Tube



# ADVANCED TOOLHOLDERS



**THE TOOLS TO MAXIMIZE YOUR MANUFACTURING POTENTIAL**

## SK COLLET CHUCKS

### **LEAN, TOUGH AND EFFICIENT**

- Narrow body design accesses tight spots.
- Applicable for all milling, drilling, reaming and rigid tapping applications.
- Two times more accurate than ER Collet Chucks, within 10 times better repeatability.
- Over 1 million SK Collet Chucks and 15 million SK collets sold worldwide.



## VC COLLET CHUCKS

### **ULTRA PERFORMANCE**

- Extremely precise with 0.00012" or less concentricity guarantee with any collet.
- Ideal for high-speed machining, thread milling, ultra precision reaming.
- Two times more accurate than ER Collet Chucks, within 10 times better repeatability.



## SHRINK FIT HOLDERS

### **HIGH ACCURACY WITH OPTIMAL CLEARANCE**

- Shrink fit holders provide minimal run out.
- Pre-balanced for up to 40,000 RPM.
- Excellent surface finish, extreme gripping and ideal for high-speed applications.
- Increase cutting tool life, material removal rate and workpiece accuracy.

