

MMC COLLET CHUCKS



MMC COLLET CHUCKS

MMC COLLET CHUCKS



MMC COLLET CHUCK FEATURES

Accuracy in Small Diameter Cutting

The Mini-Mini Chuck (MMC) features a slim and compact body for precision machining with small diameter tools (up to 0.5"). It is an ideal toolholder for high-speed machining applications where clearance is needed.

High-Speed, High-Precision:

Max. 30,000 RPM (balanced at G2.5)

- Precision ground and pre-balanced, ensuring accuracy, reliability, and repeatability during high-speed operations.
- Most flexible Collet Chuck for machining Die Mold, Aerospace, and Medical parts by providing both clearance and accuracy.

High Runout Accuracy

- Within 0.00012" at 4 times the diameter of the cutting tool!

Coolant-thru Capabilities

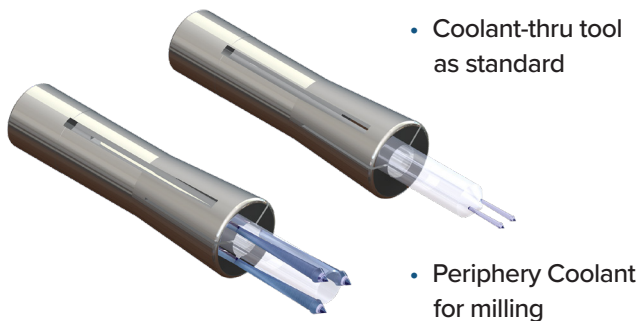

Slim, Compact Nose and Front Clamping

No collet nut required! An internal draw-in collet clamping mechanism results in strong, high-precision gripping and allows for a slim nose that can access hard to reach areas.

Compact with Strong Gripping at Nose

Collet Series Nose Diameters:

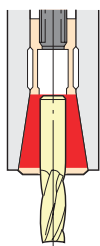

- MMC 4: \varnothing 15mm (0.591")
- MMC 8: \varnothing 20mm (0.787")
- MMC 12: \varnothing 30mm (1.181")

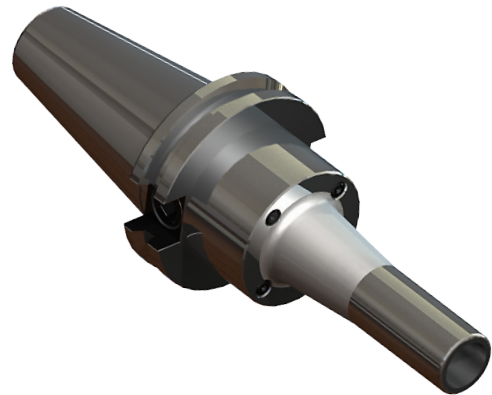
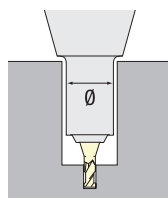

Easy-to-use draw-in collet clamping mechanism

Clamp/unclamp with just a wrench!



Wrench included with all "AA" type Mini-Mini Collet Chucks

MMC COLLET CHUCKS



CAT MMC COLLET CHUCKS

- No nut required.
- Slim, compact nose front clamping allows for greater rigidity and precision gripping.
- High concentricity and repeatability.
- Easy-to-use draw-in collet clamping pulled by standard side wrench.
- Pre-balanced for high-speed applications.



T.I.R.
<.00012" at 4xD



Speed
Up to 30,000 rpm



Coolant-Thru
Thru-tool coolant



Please note that the maximum RPM listed in our catalog may vary depending on the toolholder shank, weight, balanceability and the G rating.

CAT40

Part Number	Collet Series	Collet Range	Wrench	L	L1	D	Max. RPM
CAT40-MMC4-90U-AA-IDU	MMC4	0.039 - 0.157" (1 - 4mm)	WRENCH-ALLEN6	3.54"	1.18"	0.59"	30K
CAT40-MMC8C-85U-AT-IDU	MMC8	0.079 - 0.394" (2 - 10mm)	WRENCH-ALLEN6	3.35"	1.42"	0.79"	30K
CAT40-MMC8C-90U-AA-IDU	MMC8	0.079 - 0.394" (2 - 10mm)	WRENCH-ALLEN6	3.54"	1.30"	0.79"	30K
CAT40-MMC8C-120U-AA-IDU	MMC8	0.079 - 0.394" (2 - 10mm)	WRENCH-ALLEN6	4.72"	1.57"	0.79"	30K
CAT40-MMC8C-125U-AT-IDU	MMC8	0.079 - 0.394" (2 - 10mm)	WRENCH-THEX5-3.75	4.92"	1.42"	0.79"	30K
CAT40-MMC8C-135U-AA-IDU	MMC8	0.079 - 0.394" (2 - 10mm)	WRENCH-ALLEN6	5.31"	1.57"	0.79"	30K
CAT40-MMC12C-90U-AA-IDU	MMC12	0.157 - 0.5" (4 - 13mm)	WRENCH-ALLEN6	3.54"	1.38"	1.18"	30K
CAT40-MMC12C-120U-AA-IDU	MMC12	0.157 - 0.5" (4 - 13mm)	WRENCH-ALLEN6	4.72"	2.36"	1.18"	30K

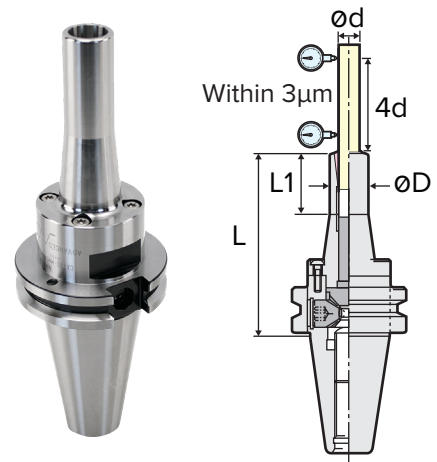

Notes:

- *Wrench included with holder except for AT-type holders.
- *AT denotes collet is drawn directly from the rear of the holder by a bolt.



Wrench-THEX5
(for AT-Type Chucks)



Wrench-ALLEN6
(for AA-Type Chucks)

CAT50

Part Number	Collet Series	Collet Range	Wrench	L	L1	D	Max. RPM
CAT50-MMC8C-105U-AA-IDU	MMC8	0.079 - 0.394" (2 - 10mm)	WRENCH-ALLEN6	4.14"	1.30"	0.79"	20K
CAT50-MMC8C-135U-AA-IDU	MMC8	0.079 - 0.394" (2 - 10mm)	WRENCH-ALLEN6	5.31"	1.57"	0.79"	20K
CAT50-MMC8C-165U-AA-IDU	MMC8	0.079 - 0.394" (2 - 10mm)	WRENCH-ALLEN6	6.50"	1.57"	0.79"	20K
CAT50-MMC12C-135U-AA-IDU	MMC12	0.157 - 0.5" (4 - 13mm)	WRENCH-ALLEN6	5.31"	2.36"	1.18"	20K
CAT50-MMC12C-165U-AA-IDU	MMC12	0.157 - 0.5" (4 - 13mm)	WRENCH-ALLEN6	6.50"	2.76"	1.18"	20K



MPK & VMK
Collets
Pages 96-97



Retention
Knobs
Page 267



Tool
Clampers
Page 274

BT MMC COLLET CHUCKS

- No nut required.
- Slim, compact nose front clamping allows for greater rigidity and precision gripping.
- High concentricity and repeatability.
- Easy-to-use draw-in collet clamping pulled by standard side wrench.
- Pre-balanced for high-speed applications.



T.I.R.
<.00012" at 4xD



Speed
Up to 30,000 rpm



Coolant-Thru
Thru-tool coolant



Please note that the maximum RPM listed in our catalog may vary depending on the toolholder shank, weight, balanceability and the G rating.

BT30

Part Number	Collet Series	Collet Range	Wrench	L	L1	D	Max. RPM
BT30-MMC4-105-AA	MMC4	0.039 - 0.157" (1 - 4mm)	WRENCH-ALLEN6	4.13"	1.18"	0.59"	30K
BT30-MMC8C-65-AT*	MMC8	0.079 - 0.394" (2 - 10mm)	EA573KL-15	2.56"	1.18"	0.79"	30K
BT30-MMC8C-105-AA	MMC8	0.079 - 0.394" (2 - 10mm)	WRENCH-ALLEN6	4.13"	1.30"	0.79"	30K
BT30-MMC12C-105-AA	MMC12	0.157 - 0.5" (4 - 13mm)	WRENCH-ALLEN6	4.13"	1.38"	1.18"	30K

Notes:

- *Wrench included with holder except for AT-type holders.
- *AT denotes collet is drawn directly from the rear of the holder by a draw bolt.



Wrench-THEx5
(for AT-Type Chucks)



Wrench-ALLEN6
(for AA-Type Chucks)

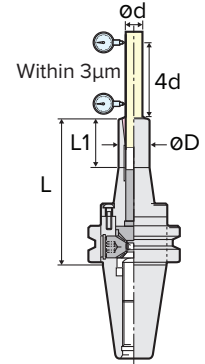

BT40

Part Number	Collet Series	Collet Range	Wrench	L	L1	D	Max. RPM
BT40-MMC4-90-AA	MMC4	0.039 - 0.157" (1 - 4mm)	WRENCH-ALLEN6	3.54"	1.26"	0.59"	30K
BT40-MMC8C-90-AA	MMC8	0.079 - 0.394" (2 - 10mm)	WRENCH-ALLEN6	3.54"	1.30"	0.79"	30K
BT40-MMC8C-120-AA	MMC8	0.079 - 0.394" (2 - 10mm)	WRENCH-ALLEN6	4.72"	1.57"	0.79"	30K
BT40-MMC8C-150-AA	MMC8	0.079 - 0.394" (2 - 10mm)	WRENCH-ALLEN6	5.90"	1.57"	0.79"	30K
BT40-MMC12C-90-AA	MMC12	0.157 - 0.5" (4 - 13mm)	WRENCH-ALLEN6	3.54"	1.38"	1.18"	30K
BT40-MMC12C-120-AA	MMC12	0.157 - 0.5" (4 - 13mm)	WRENCH-ALLEN6	4.72"	2.36"	1.18"	30K
BT40-MMC12C-150-AA	MMC12	0.157 - 0.5" (4 - 13mm)	WRENCH-ALLEN6	5.90"	2.76"	1.18"	30K

Note: Wrench included with holder.



Wrench-ALLEN6
(for AA-Type Chucks)

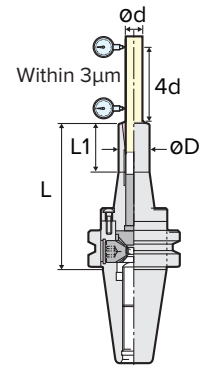

BT50

Part Number	Collet Series	Collet Range	Wrench	L	L1	D	Max. RPM
BT50-MMC4-105-AA	MMC4	0.039 - 0.157" (1 - 4mm)	WRENCH-ALLEN6	4.13"	1.18"	0.59"	20K
BT50-MMC8C-105-AA	MMC8	0.079 - 0.394" (2 - 10mm)	WRENCH-ALLEN6	4.13"	1.30"	0.79"	20K
BT50-MMC8C-135-AA	MMC8	0.079 - 0.394" (2 - 10mm)	WRENCH-ALLEN6	5.31"	1.57"	0.79"	20K
BT50-MMC12C-105-AA	MMC12	0.157 - 0.5" (4 - 13mm)	WRENCH-ALLEN6	4.13"	1.38"	1.18"	20K
BT50-MMC12C-135-AA	MMC12	0.157 - 0.5" (4 - 13mm)	WRENCH-ALLEN6	5.31"	2.36"	1.18"	20K

Note: Wrench included with holder.



Wrench-ALLEN6
(for AA-Type Chucks)

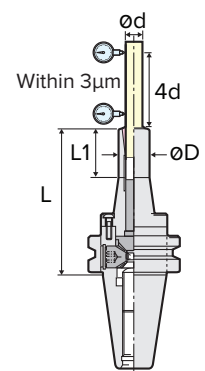

MPK & VMK
Collets
Pages 96-97



Retention
Knobs
Page 267



Tool
Clampers
Page 274

MMC COLLET CHUCKS



TAPER PLUS CAT & BT MMC COLLET CHUCKS

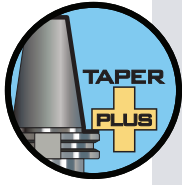

Taper Plus (Dual Contact) Advantages

- Outstanding runout accuracy for longer tool life
- Vibration dampening for increased productivity
- High rigidity for smooth and stable cutting
- Interchangeable between standard and dual face contact spindles
- 53% more surface area contact than just the taper alone

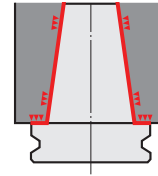

Taper Plus - BT30

Part Number	Collet Series	Collet Range	Wrench	L	L1	D	Max. RPM
NBT30-MMC4-105-AA	MMC4	0.039 - 0.157" (1 - 4mm)	WRENCH-ALLEN6	4.13"	1.18"	0.59"	30K
NBT30-MMC8C-65-AT*	MMC8	0.079 - 0.394" (2 - 10mm)	EA573KL-15	2.56"	1.18"	0.79"	30K
NBT30-MMC8C-105-AA	MMC8	0.079 - 0.394" (2 - 10mm)	WRENCH-ALLEN6	4.13"	1.30"	0.79"	30K
NBT30-MMC12C-105-AA	MMC12	0.157 - 0.5" (4 - 13mm)	WRENCH-ALLEN6	4.13"	1.38"	1.18"	30K

Notes:

- *Wrench included with holder except for AT-type holders.
- *AT denotes collet is drawn directly from the rear of the holder by a draw bolt.

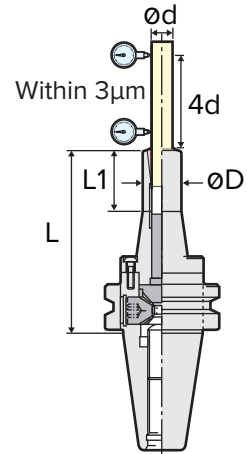

Taper Plus - BT40

Part Number	Collet Series	Collet Range	Wrench	L	L1	D	Max. RPM
NBT40-MMC8C-90-AA	MMC8	0.079 - 0.394" (2 - 10mm)	WRENCH-ALLEN6	3.54"	1.30"	0.79"	30K
NBT40-MMC8C-120-AA	MMC8	0.079 - 0.394" (2 - 10mm)	WRENCH-ALLEN6	4.72"	1.57"	0.79"	30K
NBT40-MMC12C-90-AA	MMC12	0.157 - 0.5" (4 - 13mm)	WRENCH-ALLEN6	3.54"	1.38"	1.18"	30K

Note: Wrench included with holder.

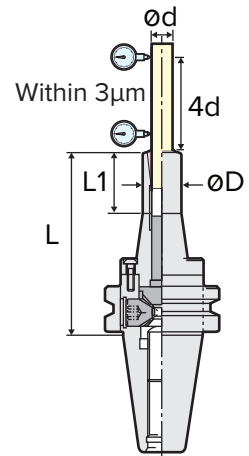

Taper Plus - CAT40

Part Number	Collet Series	Collet Range	Wrench	L	L1	D	Max. RPM
NCAT40-MMC4-90U-AA-IDU	MMC4	0.039 - 0.157" (1 - 4mm)	WRENCH-ALLEN6	3.54"	1.18"	0.59"	30K
NCAT40-MMC8C-90U-AA-IDU	MMC8	0.079 - 0.394" (2 - 10mm)	WRENCH-ALLEN6	3.54"	1.30"	0.79"	30K
NCAT40-MMC8C-120U-AA-IDU	MMC8	0.079 - 0.394" (2 - 10mm)	WRENCH-ALLEN6	4.72"	1.57"	0.79"	30K
NCAT40-MMC8C-150U-AA-IDU	MMC8	0.079 - 0.394" (2 - 10mm)	WRENCH-ALLEN6	5.90"	1.57"	0.79"	30K
NCAT40-MMC12C-90U-AA-IDU	MMC12	0.157 - 0.5" (4 - 13mm)	WRENCH-ALLEN6	3.54"	1.38"	1.18"	30K

Note: Wrench included with holder.

HSK MMC COLLET CHUCKS

- No nut required.
- Slim, compact nose front clamping allows for greater rigidity and precision gripping.
- High concentricity and repeatability.
- Easy-to-use draw-in collet clamping pulled by standard side wrench.
- Pre-balanced for high-speed applications.



T.I.R.
<.00012" at 4xD



Speed
Up to 30,000 rpm



Coolant-Thru
Thru-tool coolant



Please note that the maximum RPM listed in our catalog may vary depending on the toolholder shank, weight, balanceability and the G rating.

HSK63A/100A

Part Number	Collet Series	Collet Range	Wrench	L	L1	D	Max. RPM
HSK63A-MMC8C-107-AT-IDU	MMC8	0.079 - 0.394" (2 - 10mm)	EA573KL-15	4.21"	1.42"	0.79"	30K
HSK63A-MMC8C-115-AA-IDU	MMC8	0.079 - 0.394" (2 - 10mm)	WRENCH-ALLEN6	4.53"	1.30"	0.79"	30K
HSK63A-MMC12C-110-AT	MMC12	0.157 - 0.5" (4 - 13mm)	WRENCH-ALLEN6	4.33"	1.38"	1.18"	30K
HSK63A-MMC12C-117-AA	MMC12	0.157 - 0.5" (4 - 13mm)	WRENCH-ALLEN6	4.61"	1.28"	1.18"	30K
HSK63A-MMC12C-177-AA	MMC12	0.157 - 0.5" (4 - 13mm)	WRENCH-ALLEN6	6.97"	2.76"	1.18"	30K
HSK100A-MMC8C-117-AT	MMC8	0.079 - 0.394" (2 - 10mm)	EA573KL-15	4.61"	1.42"	0.79"	30K
HSK100A-MMC8C-130-AA	MMC8	0.079 - 0.394" (2 - 10mm)	WRENCH-ALLEN6	5.12"	1.30"	0.79"	30K
HSK100A-MMC8C-145-AT	MMC8	0.079 - 0.394" (2 - 10mm)	EA573KL-15	5.71"	2.52"	0.79"	30K
HSK100A-MMC12C-130-AA	MMC12	0.157 - 0.5" (4 - 13mm)	WRENCH-ALLEN6	5.12"	1.38"	1.18"	20K

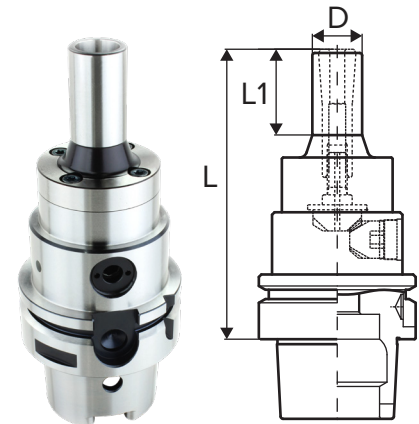

Notes:

- *Wrench included with holder except for AT-type holders.
- *AT denotes collet is drawn directly from the rear of the holder by a draw bolt.
- Coolant Tube and Wrench are sold separately (HSK63-TUBE/HSK63-WRENCH).



Wrench-THX5
(for AT-Type Chucks)



Wrench-ALLEN6
(for AA-Type Chucks)

Coolant Tube Wrench For HSK Holders

Part Number	Description
HSK63-WRENCH	Wrench for HSK63 Coolant Tube
HSK100-WRENCH	Wrench for HSK100 Coolant Tube



Note: Coolant tube wrenches are needed to remove or install coolant tubes in HSK toolholders.

Coolant Tube For HSK Holders

Part Number	Description
HSK63-TUBE	Coolant Tube for HSK63 Holders
HSK100-TUBE	Coolant Tube for HSK100 Holders



MMC COLLET CHUCKS



POLYGONAL & STRAIGHT SHANK MMC COLLET CHUCKS

- No nut required.
- Slim, compact nose front clamping allows for greater rigidity and precision gripping.
- High concentricity and repeatability.
- Easy-to-use draw-in collet clamping pulled by standard side wrench.
- Pre-balanced for high-speed applications.



T.I.R.
 <.00012" at 4xD



Speed
 Up to 30,000 rpm



Coolant-Thru
 Thru-tool coolant

MILLING



REAMING



DRILLING



Please note that the maximum RPM listed in our catalog may vary depending on the toolholder shank, weight, balanceability and the G rating.

C6

Part Number	Collet Series	Collet Range	Wrench	L	L1	D	Max. RPM
C6-MMC8C-120-AT	MMC8	0.079 - 0.394" (2 - 10mm)	EA573KL-15	4.72"	1.93"	0.79"	30K

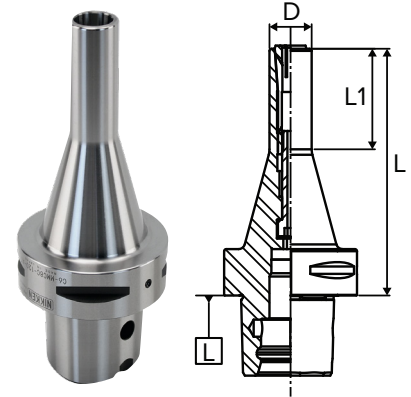

STRAIGHT SHANK

Part Number	Collet Series	Collet Range	Wrench	L	L1	L2	D
K1.1/4-MMC8C-122	MMC8	0.079 - 0.394" (2 - 10mm)	WRENCH-ALLEN6	4.80"	1.58"	2.64"	0.79"
K1.1/4-MMC8C-160	MMC8	0.079 - 0.394" (2 - 10mm)	WRENCH-ALLEN6	6.30"	1.58"	2.64"	0.79"
K3/4-MMC8C-100	MMC8	0.079 - 0.394" (2 - 10mm)	WRENCH-ALLEN6	3.94"	1.58"	2.62"	0.79"

Note: Wrench included with holder.



Wrench-ALLEN6
 (for AA-Type Chucks)

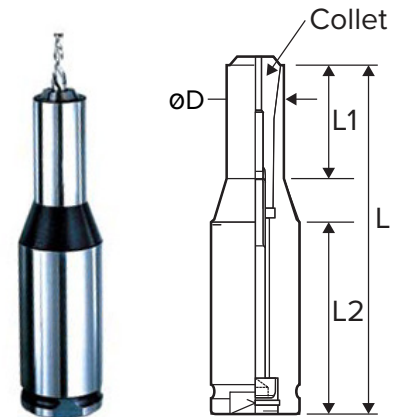

MMC COLLETS

MMC/MPK4 Collets

Part Number	Collet Series	Size
MPK4-1/16*	MPK4	1/16"
MPK4-3/32*	MPK4	3/32"
MPK4-1/8*	MPK4	1/8"
MPK4-1*	MPK4	1.0mm
MPK4-1.5*	MPK4	1.5mm
MPK4-2*	MPK4	2.0mm
MPK4-2.5*	MPK4	2.5mm
MPK4-3*	MPK4	3.0mm
MPK4-3.5*	MPK4	3.5mm
MPK4-4*	MPK4	4.0mm

Notes:

- MMC collets have minimal collapsibility. Highest accuracy and rigidity can be achieved when using cutting tools as close to nominal value as possible.
- *Available in sealed and jet slotted.

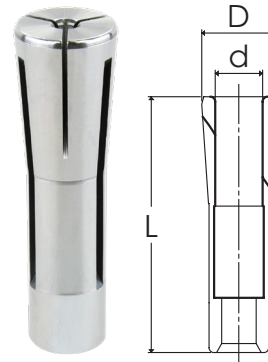

MPK4

D:0.394" (10mm)
d:1/16 - 3/32" (1 - 4mm)
L:1.260" (32mm)

PMK8

D:0.591" (15mm)
d:1/8 - 3/8" (2 - 8mm)
L:2.028" (51.5mm)

PMK12

D:0.827" (21mm)
d:3/16 - 1/2" (4 - 12mm)
L:2.205" (56mm)

MMC COLLET CHUCKS

MMC/PMK Collets

Part Number	Collet Series	Size	Part Number	Collet Series	Size
PMK4-1	PMK4	1.0mm	PMK8-2.4	PMK8	2.4mm
PMK4-1.2	PMK4	1.2mm	PMK8-2.6	PMK8	2.6mm
PMK4-1.4	PMK4	1.4mm	PMK8-3.175	PMK8	3.175mm
PMK4-1.6	PMK4	1.6mm	PMK8-3.2	PMK8	3.2mm
PMK4-1.8	PMK4	1.8mm	PMK8-3.6	PMK8	3.6mm
PMK4-2	PMK4	2.0mm	PMK8-4	PMK8	4.0mm
PMK4-2.2	PMK4	2.2mm	PMK8-4.6	PMK8	4.6mm
PMK4-2.4	PMK4	2.4mm	PMK8-5	PMK8	5.0mm
PMK4-2.6	PMK4	2.6mm	PMK8-5.6	PMK8	5.6mm
PMK4-2.8	PMK4	2.8mm	PMK8-6	PMK8	6.0mm
PMK4-3	PMK4	3.0mm	PMK8-6.4	PMK8	6.4mm
PMK4-3.2	PMK4	3.2mm	PMK8-6.6	PMK8	6.6mm
			PMK8-7	PMK8	7.0mm
			PMK8-7.6	PMK8	7.6mm
			PMK8-7.8	PMK8	7.8mm
			PMK8-8	PMK8	8.0mm
			PMK12-4	PMK12	4.0mm
			PMK12-6	PMK12	6.0mm
			PMK12-10	PMK12	10.0mm
			PMK12-12	PMK12	12.0mm

Features

- Coolant Collets are mechanically sealed.
- No additional accessories are required to make these collets coolant-thru the tool capable.
- 1000 psi high-pressure coolant capable.



VMK: Coolant Sealed Collet
VMK-JB: Jet Slotted Collet
MPK/PMK: Standard Collet



VMK COLLETS

Coolant Sealed Collets

Part Number	Collet Series	Size	Part Number	Collet Series	Size
VMK8-1/8	VMK8	1/8"	VMK12-3/16	VMK12	3/16"
VMK8-3/16	VMK8	3/16"	VMK12-1/4	VMK12	1/4"
VMK8-1/4	VMK8	1/4"	VMK12-5/16	VMK12	5/16"
VMK8-5/16	VMK8	5/16"	VMK12-3/8	VMK12	3/8"
VMK8-3/8	VMK8	3/8"	VMK12-7/16	VMK12	7/16"
VMK8-2	VMK8	2.0mm	VMK12-1/2	VMK12	1/2"
VMK8-3	VMK8	3.0mm	VMK12-4	VMK12	4.0mm
VMK8-4	VMK8	4.0mm	VMK12-5	VMK12	5.0mm
VMK8-5	VMK8	5.0mm	VMK12-6	VMK12	6.0mm
VMK8-6	VMK8	6.0mm	VMK12-8	VMK12	8.0mm
VMK8-7	VMK8	7.0mm	VMK12-10	VMK12	10mm
VMK8-8	VMK8	8.0mm	VMK12-12	VMK12	12mm
VMK8-10	VMK8	10.0mm			

Jet Slotted Collets

Part Number	Collet Series	Size	Part Number	Collet Series	Size
VMK8-1/8JB	VMK8	1/8"	VMK12-3/16J	VMK12	3/16"
VMK8-3/16J	VMK8	3/16"	VMK12-1/4J	VMK12	1/4"
VMK8-1/4J	VMK8	1/4"	VMK12-5/16J	VMK12	5/16"
VMK8-5/16J	VMK8	5/16"	VMK12-3/8J	VMK12	3/8"
VMK8-3/8J	VMK8	3/8"	VMK12-7/16J	VMK12	7/16"
VMK8-2J	VMK8	2.0mm	VMK12-1/2J	VMK12	1/2"
VMK8-2JB	VMK8	2.0mm	VMK12-4J	VMK12	4.0mm
VMK8-3JB	VMK8	3.0mm	VMK12-5J	VMK12	5.0mm
VMK8-4J	VMK8	4.0mm	VMK12-6J	VMK12	6.0mm
VMK8-5J	VMK8	5.0mm	VMK12-8J	VMK12	8.0mm
VMK8-6J	VMK8	6.0mm	VMK12-10J	VMK12	10.0mm
VMK8-8J	VMK8	8.0mm	VMK12-12J	VMK12	12.0mm
VMK8-10J	VMK8	10.0mm			

Features

- Collet slots allow coolant to be supplied directly to the periphery of the cutting tool.
- During pocket milling operations, coolant along the periphery of the cutting tool will also help flush out chips.



Enable Your Machine Shop to Thrive

Introducing EZ-Automation Solutions

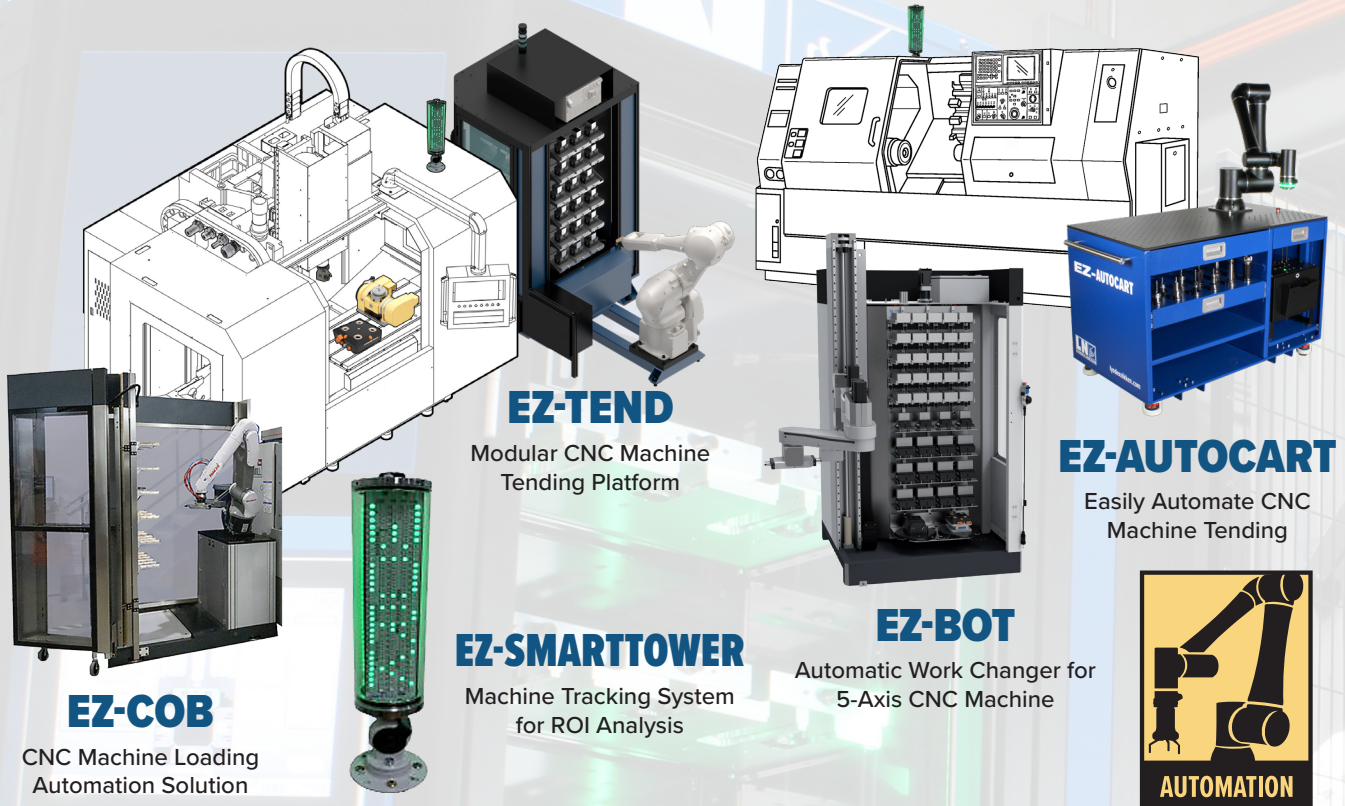

Whether your challenges are fierce competition for skilled workers amid rising labor and benefit costs, demand for high mix, low volume quality parts, delivering quality parts on time, or modernizing for Industry 4.0/5.0 - these hurdles can be daunting.

Automation offers a solution that can bring efficiency and cost-effectiveness to your operations. The key is seamless integration, cost control, and simplifying job complexities.

Lyndex-Nikken introduces a new line of EZ-Automation solutions; user-friendly automation products that minimize the need for advanced robotics or automation skills, making it easier than ever to enhance your productivity.

Enable your machine shop to thrive with automation that streamlines operations, improves processes, and enables a bottom line that reflects your success. Lyndex-Nikken is your partner in growth.

SCAN TO LEARN MORE



847-367-4800 | sales@lyndexnikken.com
lyndexnikken.com

Connect With Us!

