

# TAP HOLDERS



TAP HOLDERS

## TAP HOLDERS



## TAP HOLDER FEATURES

Our Tapping systems include tension-compression and rigid holders in all tapers and shanks. Coolant-thru available for both tension-compression and rigid style holders.

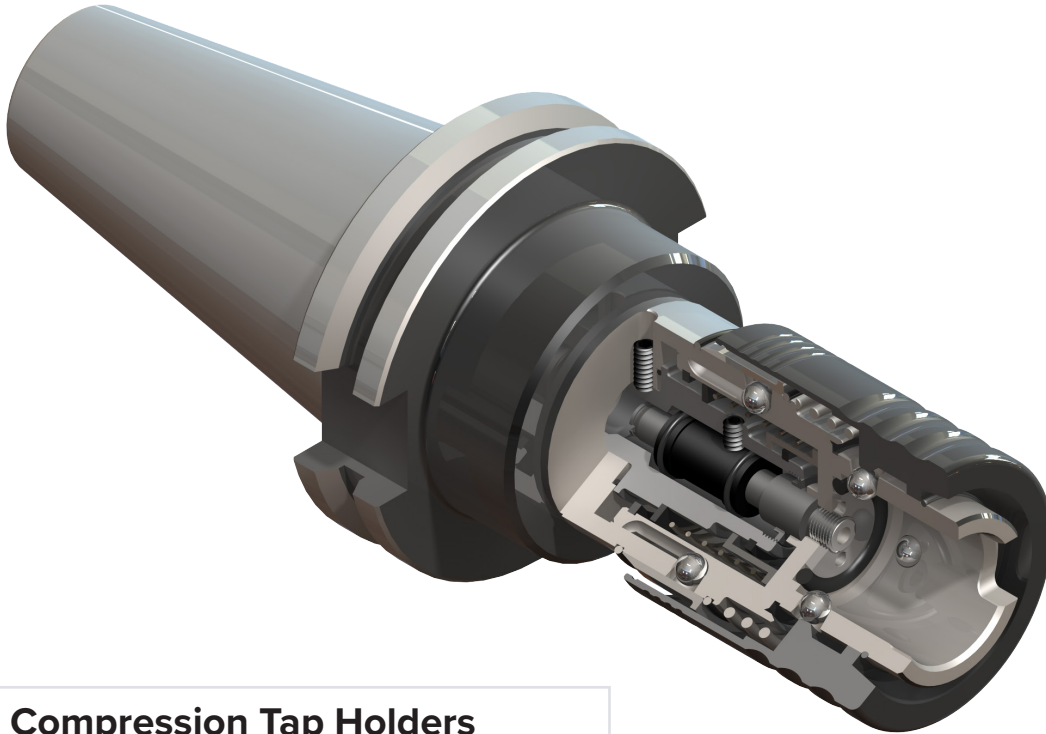

### Tension Compression Tap Holders

- Interchangeable with all Bilz tap system sizes.
- Will compensate for the machine spindle over rotating, tap elongation or minor mismatching between rotation and feed.
- Spring tension (outward pressure) will help lead and engage the tap for consistent and on size tapped holes.
- Tension Compression holders assure accuracy and control to make sure the hole is tapped exactly on the pitch of the tap. This is extremely beneficial when tapping critical hole threads with 2B and 3B dimensional call outs.
- Quick and easy interchangeability of tap collets, repeatable within .008" positioning accuracy.
- Retention balls and drive keys provide higher positioning accuracy and stronger gripping force reducing the possibility of tap slippage.

### Coolant-Thru Type

- Sealed internal mechanism allows high pressure center thru coolant to flow without contaminating the internal components.
- Chambered design also prevents back-flow of coolant into the spindle at higher pressures.
- Maximum pressure is 725 psi.

### Rigid Tap Holders

- Excellent for fast tapping on synchronous cycles.
- Interchangeable with all Bilz tap system sizes.
- Quick and easy interchangeability of tap collets.
- Retention balls and drive keys provide higher positioning accuracy and stronger gripping force, reducing the possibility of tap slippage.

### Coolant-Thru Type

- Sealed internal mechanism allows high pressure center thru coolant to flow without contaminating the internal components.
- Chambered design also prevents back-flow of coolant back into the spindle at higher pressures.
- Maximum pressure is 725 psi.

# TAP HOLDERS

## CAT TAP HOLDERS

### FEATURES

- Made to fit all Bilz standard style tap collets
- Quick and easy interchangeability of tap collets
- Retention balls and drive keys provide higher positioning accuracy and stronger gripping force, reducing the possibility of tap slippage



Utilizes quick change tap collets



T.I.R. Minimal



Tension / Compression



Set-Up Quick and easy



Coolant-Thru Thru-tap coolant

### CAT40/50 TENSION/COMPRESSION TAP HOLDERS

Part Number	Taper	Tap Range		System	L	D	T	C
		Hand	Pipe					
<b>C4005-0562-2.91</b>	CT40	#0-9/16"	1/8"	#1	2.91"	1.43"	0.29"	0.29"
<b>C4005-0875-3.86</b>	CT40	5/16-7/8"	1/4-1/2"	#2	3.86"	2.09"	0.49"	0.49"
<b>C4005-1375-7.97</b>	CT40	13/16-1-3/8"	1/2-1"	#3	7.97"	3.07"	0.79"	0.79"
<b>C5005-0562-2.91</b>	CT50	#0-9/16"	1/8"	#1	2.91"	1.42"	0.29"	0.29"
<b>C5005-0875-3.86</b>	CT50	5/16-7/8"	1/4-1/2"	#2	3.86"	2.09"	0.49"	0.49"
<b>C5005-1375-6.77</b>	CT50	13/16-1-3/8"	1/2-1"	#3	6.77"	3.07"	0.79"	0.79"

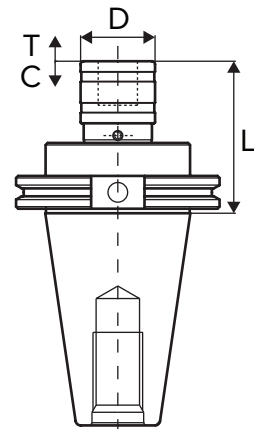

### CAT40/50 TENSION/COMPRESSION TAP HOLDERS - COOLANT-THRU

Part Number	Taper	Tap Range		System	L	D	D1	T	C
		Hand	Pipe						
<b>C4005-0562-3.98(C)</b>	CT40	#0-9/16"	1/8"	#1	3.98"	1.57"	1.28"	0.27"	0.12"
<b>C4005-0875-5.40(C)</b>	CT40	5/16-7/8"	1/4-1/2"	#2	5.40"	2.20"	1.99"	0.39"	0.20"
<b>C4005-1375-9.54(C)</b>	CT40	13/16-1-3/8"	1/2-1"	#3	9.54"	2.95"	2.76"	0.71"	0.51"
<b>C5005-0562-3.98(C)</b>	CT50	#0-9/16"	1/8"	#1	3.98"	1.57"	1.28"	0.27"	0.12"
<b>C5005-0875-5.40(C)</b>	CT50	5/16-7/8"	1/4-1/2"	#2	5.40"	2.20"	1.99"	0.39"	0.20"
<b>C5005-1375-8.34(C)</b>	CT50	13/16-1-3/8"	1/2-1"	#3	8.34"	2.95"	2.76"	0.71"	0.51"

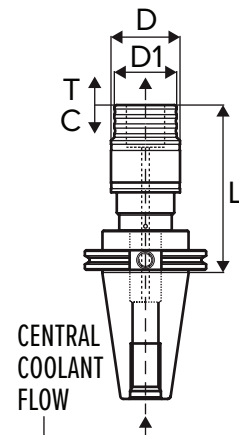

Note: Maximum pressure is 725 psi.



Tap Collets  
Pages 210-221



Tap Spanner Wrench  
Page 222

## CAT TAP HOLDERS

### FEATURES

- Made to fit all Bilz standard style tap collets
- Quick and easy interchangeability of tap collets
- Retention balls and drive keys provide higher positioning accuracy and stronger gripping force, reducing the possibility of tap slippage



**Utilizes quick change tap collets**



**Set-Up**  
Quick and easy



**T.I.R.**  
Minimal



**Coolant-Thru**  
Thru-tap coolant

### CAT40/50 RIGID TAP HOLDERS

Part Number	Taper	Tap Range		System	L	D
		Hand	Pipe			
<b>C40R5-0562-2.84</b>	CT40	#0-9/16"	1/8"	#1	2.84"	1.26"
<b>C40R5-0875-3.50</b>	CT40	5/16-7/8"	1/4-1/2"	#2	3.50"	1.97"
<b>C40R5-1375-6.24</b>	CT40	13/16-1-3/8"	1/2-1"	#3	6.24"	2.83"
<b>C50R5-0562-2.84</b>	CT50	#0-9/16"	1/8"	#1	2.84"	1.26"
<b>C50R5-0875-3.50</b>	CT50	5/16-7/8"	1/4-1/2"	#2	3.50"	1.97"
<b>C50R5-1375-5.04</b>	CT50	13/16-1-3/8"	1/2-1"	#3	5.04"	2.83"

**Note:**

- These holders are designed for use with synchronized machining centers.
- These holders have no tension or compression.

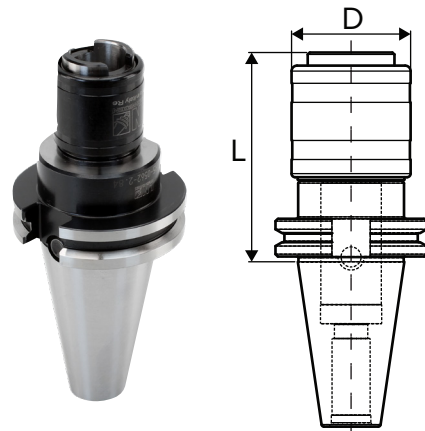

### CAT40/50 RIGID TAP HOLDERS COOLANT-THRU

Part Number	Taper	Tap Range		System	L	D
		Hand	Pipe			
<b>C40R5-0562-2.87(C)</b>	CT40	#0-9/16"	1/8"	#1	2.87"	1.26"
<b>C40R5-0875-3.50(C)</b>	CT40	5/16-7/8"	1/4-1/2"	#2	3.50"	1.97"
<b>C40R5-1375-6.24(C)</b>	CT40	13/16-1-3/8"	1/2-1"	#3	6.24"	2.83"
<b>C50R5-0562-2.87(C)</b>	CT50	#0-9/16"	1/8"	#1	2.87"	1.26"
<b>C50R5-0875-3.50(C)</b>	CT50	5/16-7/8"	1/4-1/2"	#2	3.50"	1.97"
<b>C50R5-1375-5.04(C)</b>	CT50	13/16-1-3/8"	1/2-1"	#3	5.04"	2.83"

**Note:**

- These holders are designed for use with synchronized machining centers.
- These holders have no tension or compression.
- Maximum pressure is 725 psi.

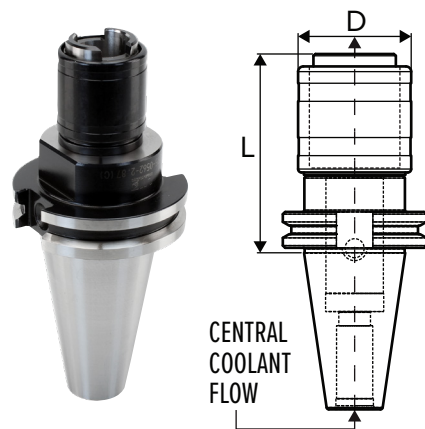

Tap Collets  
Pages 210-221



Tap Spanner Wrench  
Page 222

# TAP HOLDERS

## BT TAP HOLDERS

### FEATURES

- Made to fit all Bilz standard style tap collets
- Quick and easy interchangeability of tap collets
- Retention balls and drive keys provide higher positioning accuracy and stronger gripping force, reducing the possibility of tap slippage



Utilizes quick change tap collets



T.I.R. Minimal



Tension / Compression



Set-Up Quick and easy



Coolant-Thru Thru-tap coolant

### BT30/40/50 TENSION/COMPRESSION TAP HOLDERS

Part Number	Taper	Tap Range		System	L	D	T	C
		Hand	Pipe					
<b>B3005-0562-2.40</b>	BT30	#0-9/16"	1/8"	#1	2.40"	1.42"	0.295"	0.295"
<b>B4005-0562-2.91</b>	BT40	#0-9/16"	1/8"	#1	2.91"	1.43"	0.29"	0.29"
<b>B4005-0875-3.86</b>	BT40	5/16-7/8"	1/4-1/2"	#2	3.86"	2.09"	0.49"	0.49"
<b>B4005-1375-7.64</b>	BT40	13/16-1-3/8"	1/2-1"	#3	7.64"	3.07"	0.79"	0.79"
<b>B5005-0562-3.26</b>	BT50	#0-9/16"	1/8"	#1	3.26"	1.43"	0.29"	0.29"
<b>B5005-0875-4.21</b>	BT50	5/16-7/8"	1/4-1/2"	#2	4.21"	2.09"	0.49"	0.49"
<b>B5005-1375-6.73</b>	BT50	13/16-1-3/8"	1/2-1"	#3	6.73"	3.07"	0.79"	0.79"

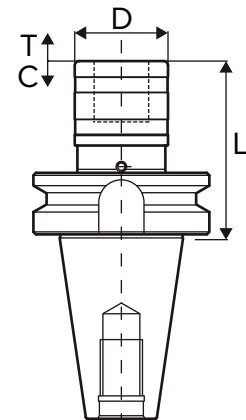

### BT30/40/50 TENSION/COMPRESSION TAP HOLDERS - COOLANT-THRU

Part Number	Taper	Tap Range		System	L	D	D1	T	C
		Hand	Pipe						
<b>B3005-0562-4.37(C)</b>	BT30	#0-9/16"	1/8"	#1	4.37"	1.57"	1.34"	0.27"	0.12"
<b>B4005-0562-3.98(C)</b>	BT40	#0-9/16"	1/8"	#1	3.98"	1.57"	1.28"	0.27"	0.12"
<b>B4005-0875-5.36(C)</b>	BT40	5/16-7/8"	1/4-1/2"	#2	5.36"	2.20"	1.99"	0.39"	0.20"
<b>B4005-1375-9.21(C)</b>	BT40	13/16-1-3/8"	1/2-1"	#3	9.21"	2.95"	2.76"	0.71"	0.51"
<b>B5005-0562-4.33(C)</b>	BT50	#0-9/16"	1/8"	#1	4.33"	1.57"	1.28"	0.27"	0.12"
<b>B5005-0875-5.75(C)</b>	BT50	5/16-7/8"	1/4-1/2"	#2	5.75"	2.20"	1.99"	0.39"	0.20"
<b>B5005-1375-8.30(C)</b>	BT50	13/16-1-3/8"	1/2-1"	#3	8.30"	2.95"	2.76"	0.71"	0.51"

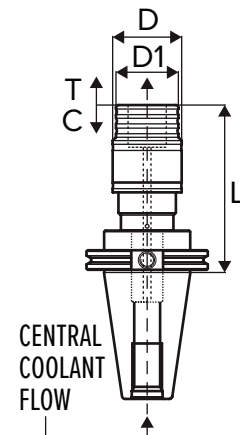

Note: Maximum pressure is 725 psi.



Tap Collets  
Pages 210-221



Tap Spanner Wrench  
Page 222

## BT TAP HOLDERS

### FEATURES

- Made to fit all Bilz standard style tap collets
- Quick and easy interchangeability of tap collets
- Retention balls and drive keys provide higher positioning accuracy and stronger gripping force, reducing the possibility of tap slippage



**Utilizes quick change tap collets**



**Set-Up**  
Quick and easy



**T.I.R.**  
Minimal



**Coolant-Thru**  
Thru-tap coolant

### BT30/40/50 RIGID TAP HOLDERS

Part Number	Taper	Tap Range		System	L	D
		Hand	Pipe			
<b>B30R5-0562-2.36</b>	BT30	#0-9/16"	1/8"	#1	2.36"	1.26"
<b>B40R5-0562-2.84</b>	BT40	#0-9/16"	1/8"	#1	2.84"	1.26"
<b>B40R5-0875-3.50</b>	BT40	#0-9/16"	1/8"	#1	3.50"	1.98"
<b>B40R5-1375-5.91</b>	BT40	#0-9/16"	1/8"	#1	5.91"	2.83"
<b>B50R5-0562-3.19</b>	BT50	#0-9/16"	1/8"	#1	3.19"	1.26"
<b>B50R5-0875-3.85</b>	BT50	#0-9/16"	1/8"	#1	3.85"	1.97"
<b>B50R5-1375-5.00</b>	BT50	#0-9/16"	1/8"	#1	5.00"	2.83"

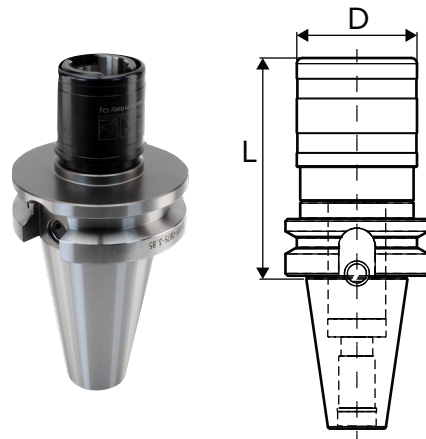

**Note:**

- These holders are designed for use with synchronized machining centers.
- These holders have no tension or compression.

### BT30/40/50 RIGID TAP HOLDERS COOLANT-THRU

Part Number	Taper	Tap Range		System	L	D
		Hand	Pipe			
<b>B30R5-0562-2.28(C)</b>	BT30	#0-9/16"	1/8"	#1	2.28"	1.26"
<b>B40R5-0562-2.87(C)</b>	BT40	#0-9/16"	1/8"	#1	2.87"	1.26"
<b>B40R5-0875-3.50(C)</b>	BT40	5/16-7/8"	1/4-1/2"	#2	3.50"	1.97"
<b>B40R5-1375-5.91(C)</b>	BT40	13/16-1-3/8"	1/2-1"	#3	5.91"	2.83"
<b>B50R5-0562-3.22(C)</b>	BT30	#0-9/16"	1/8"	#1	3.22"	1.26"
<b>B50R5-0875-3.85(C)</b>	BT30	5/16-7/8"	1/4-1/2"	#2	3.85"	1.97"
<b>B50R5-1375-5.00(C)</b>	BT30	13/16-1-3/8"	1/2-1"	#3	5.00"	2.83"

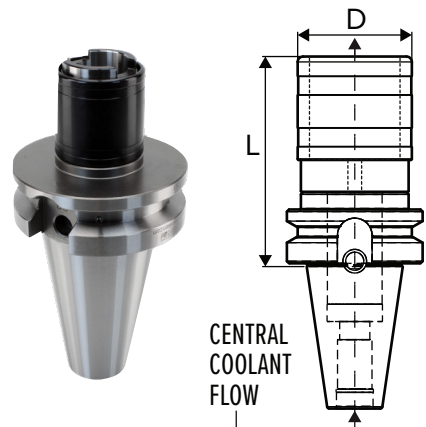

**Note:**

- These holders are designed for use with synchronized machining centers.
- These holders have no tension or compression.
- Maximum pressure is 725 psi.



Tap Collets  
Pages 210-221



Tap Spanner Wrench  
Page 222

# TAP HOLDERS

## HSK TAP HOLDERS

### FEATURES

- Made to fit all Bilz standard style tap collets
- Quick and easy interchangeability of tap collets
- Retention balls and drive keys provide higher positioning accuracy and stronger gripping force, reducing the possibility of tap slippage



Utilizes quick change tap collets



T.I.R. Minimal



Tension / Compression



Set-Up Quick and easy



Coolant-Thru Thru-tap coolant

### HSK63/100A TENSION/COMPRESSION TAP HOLDERS

Part Number	Tap Range		System	L	D	T	C
	Hand	Pipe					
<a href="#">HSK63A-TC0562-3.15</a>	#0-9/16"	1/8"	#1	3.15"	1.42"	0.29"	0.29"
<a href="#">HSK63A-TC0875-4.72</a>	5/16-7/8"	1/4-1/2"	#2	4.72"	2.09"	0.49"	0.49"
<a href="#">HSK63A-TC1375-7.72</a>	13/16-1-3/8"	1/2-1"	#3	7.72"	3.07"	0.68"	0.68"
<a href="#">HSK100A-TC0562-3.23</a>	#0-9/16"	1/8"	#1	3.23"	1.42"	0.29"	0.29"
<a href="#">HSK100A-TC0875-4.41</a>	5/16-7/8"	1/4-1/2"	#2	4.41"	2.09"	0.49"	0.49"
<a href="#">HSK100A-TC1375-7.95</a>	13/16-1-3/8"	1/2-1"	#3	7.95"	3.07"	0.68"	0.68"

Note: Coolant tube and coolant tube wrench are not included. See Page 222 for more details.

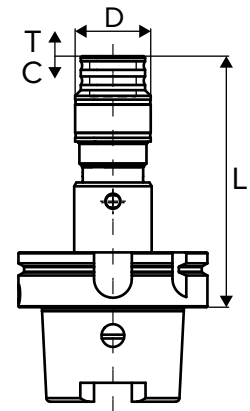

### HSK63/100A TENSION/COMPRESSION TAP HOLDERS - COOLANT-THRU

Part Number	Tap Range		System	L	D	D1	T	C
	Hand	Pipe						
<a href="#">HSK63A-TC0562-4.92(C)</a>	#0-9/16"	1/8"	#1	4.92"	1.57"	1.34"	0.29"	0.29"
<a href="#">HSK63A-TC0875-6.38(C)</a>	5/16-7/8"	1/4-1/2"	#2	6.38"	2.21"	1.97"	0.27"	0.12"
<a href="#">HSK63A-TC1375-9.41(C)</a>	13/16-1-3/8"	1/2-1"	#3	9.41"	3.07"	2.84"	0.68"	0.68"
<a href="#">HSK100A-TC0562-5.20(C)</a>	#0-9/16"	1/8"	#1	5.20"	1.57"	1.34"	0.29"	0.29"
<a href="#">HSK100A-TC0875-6.62(C)</a>	5/16-7/8"	1/4-1/2"	#2	6.62"	1.57"	1.28"	0.27"	0.12"

Note:

- Coolant tube and coolant tube wrench are not included. See Page 222 for more details.
- Maximum pressure is 725 psi.

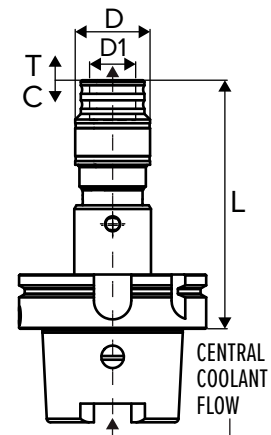

Tap Collets  
Pages 210-221



Tap Spanner  
Wrench  
Page 222



HSK  
Coolant Tube  
Page 222



HSK Coolant  
Tube Wrench  
Page 222

## HSK TAP HOLDERS

### FEATURES

- Made to fit all Bilz standard style tap collets
- Quick and easy interchangeability of tap collets
- Retention balls and drive keys provide higher positioning accuracy and stronger gripping force, reducing the possibility of tap slippage



**Utilizes quick change tap collets**



**Set-Up**  
Quick and easy



**T.I.R.**  
Minimal



**Coolant-Thru**  
Thru-tap coolant

### HSK40/63/100 RIGID TAP HOLDERS

Part Number	Tap Range		System	L	D
	Hand	Pipe			
<b>HSK40A-R0562-3.15</b>	#0-9/16"	1/8"	#1	3.15"	1.26"
<b>HSK63A-R0562-2.48</b>	#0-9/16"	1/8"	#1	2.48"	1.26"
<b>HSK63A-R0875-3.31</b>	5/16-7/8"	1/4-1/2"	#2	3.31"	1.97"
<b>HSK63A-R1375-5.12</b>	13/16-1-3/8"	1/2-1"	#3	5.12"	2.83"
<b>HSK100A-R0562-2.59</b>	#0-9/16"	1/8"	#1	2.59"	1.26"
<b>HSK100A-R0875-3.42</b>	5/16-7/8"	1/4-1/2"	#2	3.42"	1.97"
<b>HSK100A-R1375-4.57</b>	13/16-1-3/8"	1/2-1"	#3	4.57"	2.83"

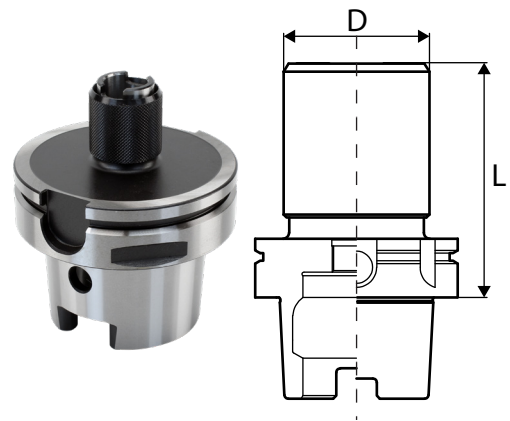

**Note:**

- Coolant tube and coolant tube wrench are not included. See Page 222 for more details.
- These holders are designed for use with synchronized machining centers.
- These holders have no tension or compression.

### HSK40/63/100 RIGID TAP HOLDERS COOLANT-THRU

Part Number	Tap Range		System	L	D
	Hand	Pipe			
<b>HSK40A-R0562-2.97(C)</b>	#0-9/16"	1/8"	#1	2.97"	1.26"
<b>HSK63A-R0562-2.76(C)</b>	#0-9/16"	1/8"	#1	2.76"	1.26"
<b>HSK63A-R0875-3.70(C)</b>	5/16-7/8"	1/4-1/2"	#2	3.70"	1.97"
<b>HSK100A-R0562-3.09(C)</b>	#0-9/16"	1/8"	#1	3.09"	1.26"
<b>HSK100A-R0875-3.94(C)</b>	5/16-7/8"	1/4-1/2"	#2	3.94"	1.97"
<b>HSK100A-R1375-5.32(C)</b>	13/16-1-3/8"	1/2-1"	#3	5.32"	2.84"

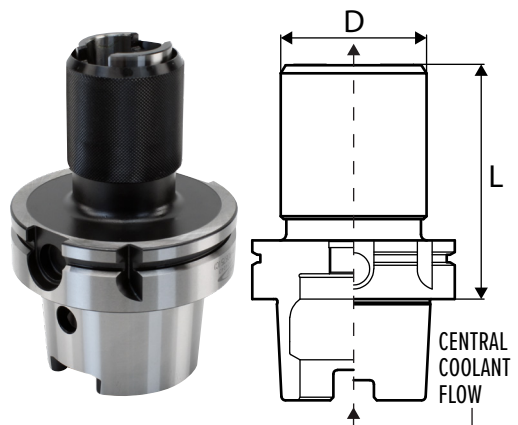

**Note:**

- Coolant tube and coolant tube wrench are not included. See Page 222 for more details.
- These holders are designed for use with synchronized machining centers.
- These holders have no tension or compression.
- Maximum pressure is 725 psi.



Tap Collets  
Pages 210-221



Tap Spanner  
Wrench  
Page 222



HSK  
Coolant Tube  
Page 222



HSK Coolant  
Tube Wrench  
Page 222

# TAP HOLDERS



TAP HOLDERS

## WELDON TAP HOLDERS

### FEATURES

- Made to fit all Bilz standard style tap collets
- Quick and easy interchangeability of tap collets
- Retention balls and drive keys provide higher positioning accuracy and stronger gripping force, reducing the possibility of tap slippage



**Utilizes quick change tap collets**



**T.I.R. Minimal**



**Tension / Compression**



**Set-Up Quick and easy**



**Coolant-Thru Thru-tap coolant**

### WELDON SHANK TENSION/COMPRESSION TAP HOLDERS

Part Number	Tap Range		System	D	D1	L1	L2	T	C
	Hand	Pipe							
W7505-0562-1.53	#0-9/16"	1/8"	#1	3/4"	1.43"	2.00"	1.53"	0.29"	0.29"
W1005-0562-1.53	#0-9/16"	1/8"	#1	1"	1.43"	2.28"	1.53"	0.29"	0.29"
W1205-0562-1.61	#0-9/16"	1/8"	#1	1-1/4"	1.43"	2.28"	1.61"	0.29"	0.29"
W1005-0875-2.48	5/16-7/8"	1/4-1/2"	#2	1"	2.09"	2.28"	2.48"	0.49"	0.49"
W1205-0875-2.48	5/16-7/8"	1/4-1/2"	#2	1-1/4"	2.09"	2.28"	2.48"	0.49"	0.49"
W1205-1375-5.00	13/16-1-3/8"	1/2-1"	#3	1-1/4"	3.07"	2.28"	5.00"	0.79"	0.79"
W1505-1375-4.65	13/16-1-3/8"	1/2-1"	#3	1-1/2"	3.07"	2.69"	4.65"	0.79"	0.79"

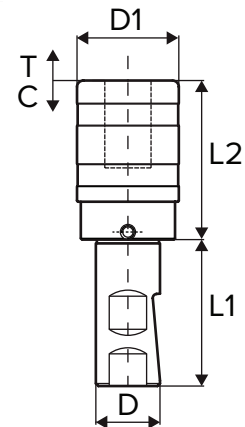

### WELDON SHANK TENSION/COMPRESSION TAP HOLDERS - COOLANT-THRU

Part Number	Tap Range		System	D	D1	D2	L1	L2	T	C
	Hand	Pipe								
W25MR5-0562-38(C)	#0-9/16"	1/8"	#1	0.984"	1.29"	1.57"	2.28"	2.60"	0.27"	0.12"
W25MR5-0875-54(C)	5/16-7/8"	1/8"	#1	1"	1.29"	1.57"	2.28"	2.60"	0.27"	0.12"
W1000-TC1-2.60(C)	#0-9/16"	1/8"	#1	1"	1.29"	1.57"	2.28"	2.60"	0.27"	0.12"
W1000-TC2-4.02(C)	5/16-7/8"	1/4-1/2"	#2	1"	1.99"	2.20"	2.28"	4.02"	0.39"	0.20"
W1205-0562-2.60(C)	#0-9/16"	1/8"	#1	1-1/4"	1.29"	1.28"	2.28"	2.60"	0.27"	0.12"
W1205-0875-4.02(C)	5/16-7/8"	1/4-1/2"	#2	1-1/4"	1.99"	2.20"	2.28"	4.02"	0.39"	0.20"
W1205-1375-6.57(C)	13/16-1-3/8"	1/2-1"	#3	1-1/4"	2.75"	2.95"	2.28"	6.57"	0.71"	0.51"
W1500-TC3-6.57(C)	13/16-1-3/8"	1/2-1"	#3	1-1/2"	2.75"	2.95"	2.69"	6.57"	0.71"	0.51"

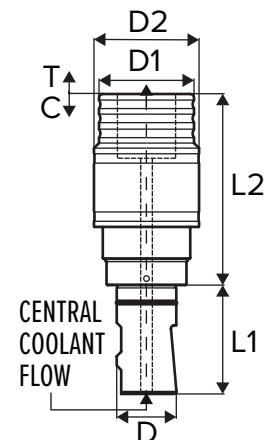

Note: Maximum pressure is 725 psi.



Tap Collets  
Pages 210-221



Tap Spanner Wrench  
Page 222

## WELDON TAP HOLDERS

### FEATURES

- Made to fit all Bilz standard style tap collets
- Quick and easy interchangeability of tap collets
- Retention balls and drive keys provide higher positioning accuracy and stronger gripping force, reducing the possibility of tap slippage



**Utilizes quick change tap collets**



**Set-Up**  
Quick and easy



**T.I.R.**  
Minimal



**Coolant-Thru**  
Thru-tap coolant

### WELDON SHANK RIGID TAP HOLDERS

Part Number	Tap Range		System	D	D1	L1	L2
	Hand	Pipe					
<b>W25MR5-0562-37</b>	#0-9/16"	1/8"	#1	0.984"	1.26"	2.08"	1.46"
<b>W25MR5-0875-56</b>	5/16-7/8"	1/4-1/2"	#2	0.984"	1.97"	2.08"	2.12"
<b>W10R5-0562-1.46</b>	#0-9/16"	1/8"	#1	1"	1.26"	2.28"	1.46"
<b>W10R5-0875-2.12</b>	5/16-7/8"	1/4-1/2"	#2	1"	1.97"	2.28"	2.12"
<b>W12R5-1375-3.27</b>	13/16-1-3/8"	1/2-1"	#3	1-1/4"	2.83"	2.28"	3.27"
<b>W15R5-1375-5.96</b>	13/16-1-3/8"	1/2-1"	#3	1-1/2"	2.83"	2.70"	3.28"

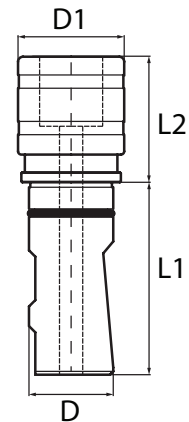

**Note:**

- These holders are designed for use with synchronized machining centers.
- These holders have no tension or compression.

### WELDON SHANK RIGID TAP HOLDERS COOLANT-THRU

Part Number	Tap Range		System	D	D1	L1	L2
	Hand	Pipe					
<b>W75R5-0562-1.46(C)</b>	#0-9/16"	1/8"	#1	3/4"	1.26"	2.03"	1.49"
<b>W25MR5-0562-38(C)</b>	#0-9/16"	1/8"	#1	0.984"	1.26"	2.08"	1.49"
<b>W25MR5-0875-54(C)</b>	5/16-7/8"	1/4-1/2"	#2	0.984"	1.97"	2.08"	2.12"
<b>W12R5-0562-1.65(C)</b>	#0-9/16"	1/8"	#1	1-1/4"	1.26"	2.28"	1.65"
<b>W12R5-0875-2.12(C)</b>	5/16-7/8"	1/4-1/2"	#2	1-1/4"	1.97"	2.28"	2.12"
<b>W1250-RT3-3.27(C)</b>	13/16-1-3/8"	1/2-1"	#3	1-1/4"	2.83"	2.28"	3.27"

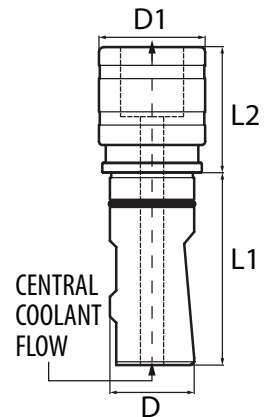

**Note:**

- These holders are designed for use with synchronized machining centers.
- These holders have no tension or compression.
- Maximum pressure is 725 psi.



# TAP HOLDERS



TAP HOLDERS

## STRAIGHT SHANK TAP HOLDERS

### FEATURES

- Made to fit all Bilz standard style tap collets
- Quick and easy interchangeability of tap collets
- Retention balls and drive keys provide higher positioning accuracy and stronger gripping force, reducing the possibility of tap slippage



**Utilizes quick change tap collets**



**T.I.R. Minimal**



**Tension / Compression**



**Set-Up Quick and easy**



**Coolant-Thru Thru-tap coolant**

### STRAIGHT SHANK TENSION/COMPRESSION TAP HOLDERS

Part Number	Tap Range		System	D	D1	L1	L2	T	C
	Hand	Pipe							
<b>S1005-0562-4.17</b>	#0-9/16"	1/8"	#1	1"	1.26"	3.50"	4.17"	0.79"	0.39"
<b>S1005-0875-5.61</b>	5/16-7/8"	1/4-1/2"	#2	1"	1.96"	3.50"	5.61"	0.85"	0.49"
<b>S1205-0875-5.61</b>	5/16-7/8"	1/4-1/2"	#2	1-1/4"	1.96"	4.00"	5.61"	0.85"	0.49"

**Note:**

- Straight Shank tooling may be used to extend tooling reach for extended length operations.
- This option is less costly than extended length integral shank tooling.
- Can be used on machining centers or lathes.

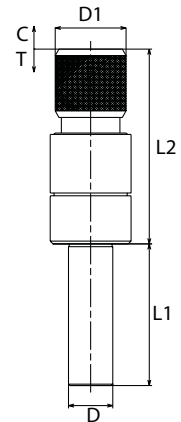

Tap Collets  
Pages 210-221



Tap Spanner Wrench  
Page 222

## TAP COLLETS

### POSITIVE DRIVE TAP COLLETS - ANSI STANDARD

Standard collets are used for standard and coolant-thru tap holders.

Part Number	System	Tap Size	Tap Shank $\phi$	Drive Square $\boxtimes$
NT05-006	#1	#0-6	0.141"	0.110"
NT05-008	#1	#8	0.168"	0.131"
NT05-010	#1	#10, 3/16"	0.194"	0.152"
NT05-012	#1	#12	0.220"	0.165"
NT05-016	#1	1/4"	0.255"	0.191"
NT05-020	#1	5/16"	0.318"	0.238"
NT05-024	#1	3/8"	0.381"	0.286"
NT05-028	#1	7/16"	0.323"	0.242"
NT05-032	#1	1/2"	0.367"	0.275"
NT05-036	#1	9/16"	0.429"	0.322"
NT10-020	#2	5/16"	0.318"	0.238"
NT10-024	#2	3/8"	0.381"	0.286"
NT10-028	#2	7/16"	0.323"	0.242"
NT10-032	#2	1/2"	0.367"	0.275"
NT10-036	#2	9/16"	0.429"	0.322"
NT10-040	#2	5/8"	0.480"	0.360"
NT10-044	#2	11/16"	0.542"	0.406"
NT10-048	#2	3/4"	0.590"	0.442"
NT10-052	#2	13/16"	0.652"	0.489"
NT10-056	#2	7/8"	0.697"	0.523"
NT15-052	#3	13/16"	0.652"	0.489"
NT15-056	#3	7/8"	0.697"	0.523"
NT15-060	#3	15/16"	0.760"	0.570"
NT15-064	#3	1"	0.800"	0.600"
NT15-072	#3	1-1/8"	0.896"	0.672"
NT15-080	#3	1-1/4"	1.021"	0.766"
NT15-088	#3	1-3/8"	1.108"	0.831"

Note: See pages 224-225 for details about dimensions cross over for ANSI, DIN, ISO, JIS Specification Taps.

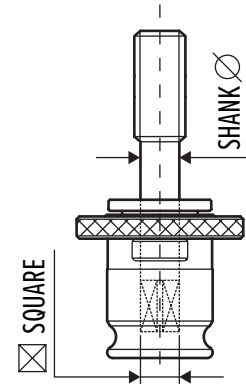

### DIMENSIONAL DATA

System	L	D1	D2
#1	0.27"	1.18"	0.75"
#2	0.43"	1.89"	1.22"
#3	0.55"	2.76"	1.89"

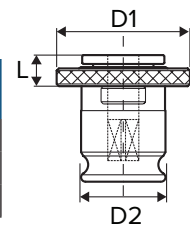

### POSITIVE DRIVE TAP COLLET SETS

Part Number	Description
NT05-SET-10	10 Piece System #1 Positive Drive Tap Collet Set: 0-9/16" hand
NT10-SET-10	10 Piece System #2 Positive Drive Tap Collet Set: 5/16" - 7/8" hand
NT15-SET-07	7 Piece System #3 Positive Drive Tap Collet Set: 13/16" - 1-3/8" hand

# TAP HOLDERS



## TAP COLLETS

### POSITIVE DRIVE TAP COLLETS - ANSI STANDARD - SLOTTED

Slotted collets are designed for use with standard taps for coolant along the flute.

Part Number	System	Tap Size	Tap Shank $\phi$	Drive Square $\boxtimes$
NT05-006(S)	#1	#0-6	0.141"	0.110"
NT05-008(S)	#1	#8	0.168"	0.131"
NT05-010(S)	#1	#10, 3/16"	0.194"	0.152"
NT05-012(S)	#1	#12	0.220"	0.165"
NT05-016(S)	#1	1/4"	0.255"	0.191"
NT05-020(S)	#1	5/16"	0.318"	0.238"
NT05-024(S)	#1	3/8"	0.381"	0.286"
NT05-028(S)	#1	7/16"	0.323"	0.242"
NT05-032(S)	#1	1/2"	0.367"	0.275"
NT05-036(S)	#1	9/16"	0.429"	0.322"
NT10-020(S)	#2	5/16"	0.318"	0.238"
NT10-024(S)	#2	3/8"	0.381"	0.286"
NT10-028(S)	#2	7/16"	0.323"	0.242"
NT10-032(S)	#2	1/2"	0.367"	0.275"
NT10-036(S)	#2	9/16"	0.429"	0.322"
NT10-040(S)	#2	5/8"	0.480"	0.360"
NT10-044(S)	#2	11/16"	0.542"	0.406"
NT10-048(S)	#2	3/4"	0.590"	0.442"
NT10-052(S)	#2	13/16"	0.652"	0.489"
NT10-056(S)	#2	7/8"	0.697"	0.523"
NT15-052(S)	#3	13/16"	0.652"	0.489"
NT15-056(S)	#3	7/8"	0.697"	0.523"
NT15-060(S)	#3	15/16"	0.760"	0.570"
NT15-064(S)	#3	1"	0.800"	0.600"
NT15-072(S)	#3	1-1/8"	0.896"	0.672"
NT15-080(S)	#3	1-1/4"	1.021"	0.766"
NT15-088(S)	#3	1-3/8"	1.108"	0.831"

Note: See pages 224-225 for details about dimensions cross over for ANSI, DIN, ISO, JIS Specification Taps.

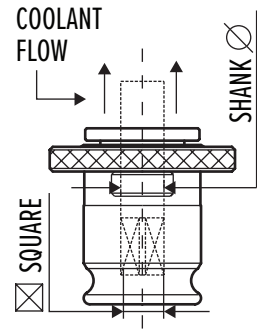

### DIMENSIONAL DATA

System	L	D1	D2
#1	0.27"	1.18"	0.75"
#2	0.43"	1.89"	1.22"
#3	0.55"	2.76"	1.89"

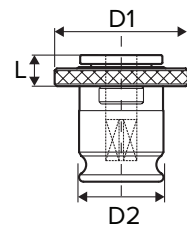

## TAP COLLETS

### POSITIVE DRIVE PIPE TAP COLLETS - ANSI STANDARD

Part Number	System	Tap Size	Tap Shank $\phi$	Drive Square $\boxtimes$
NTPT05-008S	#1	1/8"S	0.313"	0.234"
NTPT05-008L	#1	1/8"L	0.437"	0.328"
NTPT10-016	#2	1/4"	0.562"	0.421"
NTPT10-024	#2	3/8"	0.700"	0.531"
NTPT10-032	#2	1/2"	0.687"	0.515"
NTPT15-032	#3	1/2"	0.687"	0.515"
NTPT15-048	#3	3/4"	0.906"	0.679"
NTPT15-064	#3	1"	1.125"	0.843"

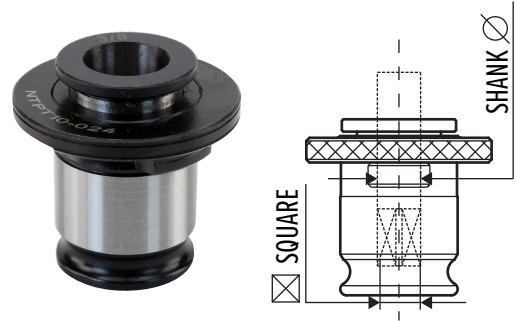

### POSITIVE DRIVE PIPE TAP COLLETS - ANSI STANDARD - SLOTTED

Slotted collets are designed for use with standard taps for coolant along the flute.

Part Number	System	Tap Size	Tap Shank $\phi$	Drive Square $\boxtimes$
NTPT05-008S(S)	#1	1/8"S	0.313"	0.234"
NTPT05-008L(S)	#1	1/8"L	0.437"	0.328"
NTPT10-016(S)	#2	1/4"	0.562"	0.421"
NTPT10-024(S)	#2	3/8"	0.700"	0.531"
NTPT10-032(S)	#2	1/2"	0.687"	0.515"
NTPT15-032(S)	#3	1/2"	0.687"	0.515"
NTPT15-048(S)	#3	3/4"	0.906"	0.679"
NTPT15-064(S)	#3	1/2"	1.125"	0.843"

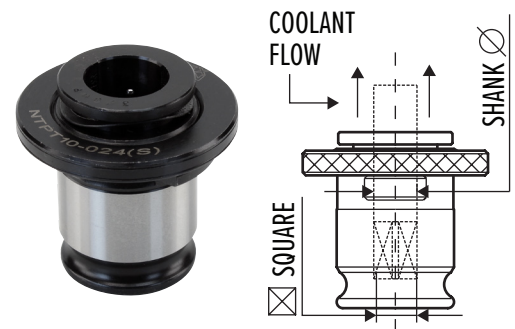

### POSITIVE DRIVE PIPE TAP COLLET SETS

Part Number	Description
NTP05-SET-12	12 Piece System #1 Positive Drive Tap Collet Set: 0 - 9/16" hand and 1/8" pipe large & small
NTP10-SET-13	13 Piece System #2 Positive Drive Tap Collet Set: 5/16" - 7/8" hand and 1/4" - 1/2" pipe
NTP15-SET-10	10 Piece System #3 Positive Drive Tap Collet Set: 13/16" - 1-3/8" hand and 1/2" - 1" pipe

Note: See pages 224-225 for details about dimensions cross over for ANSI, DIN, ISO, JIS Specification Taps.

### DIMENSIONAL DATA

System	L	D1	D2
#1	0.27"	1.18"	0.75"
#2	0.43"	1.89"	1.22"
#3	0.55"	2.76"	1.89"

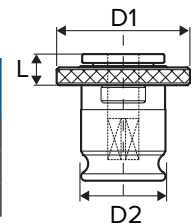

# TAP HOLDERS

## TAP COLLETS

### POSITIVE DRIVE TAP COLLETS - ISO 529 STANDARD

Standard collets are used for standard and coolant-thru tap holders.

Part Number	System	Tap Size	Tap Shank $\phi$	Drive Square $\boxtimes$
SE1-2.24X1.8	#1	M3	2.24mm	1.80mm
SE1-2.50X2.0	#1	M3.5, M2	2.50mm	2.00mm
SE1-2.80X2.24	#1	M2.5, M2.2	2.80mm	2.24mm
SE1-3.15X2.50	#1	M4, M3	3.15mm	2.50mm
SE1-3.55X2.80	#1	M4.5, M3.5	3.55mm	2.80mm
SE1-4.0X3.15	#1	M5, M4	4.00mm	3.15mm
SE1-4.5X3.55	#1	M6	4.50mm	3.55mm
SE1-5.0X4.0	#1	M5	5.00mm	4.00mm
SE1-5.6X4.5	#1	M5	5.60mm	4.50mm
SE1-6.3X5.0	#1	M8, M6	6.30mm	5.00mm
SE1-7.1X5.6	#1	M7	7.10mm	5.60mm
SE1-8.0X6.3	#1	M11, M10, M8	8.00mm	6.30mm
SE1-9.0X7.1	#1	M12, M9	9.00mm	7.10mm
SE1-10.0X8.0	#1	M10	10.0mm	8.00mm
SE1-11.2X9.0	#1	M14	11.2mm	9.00mm
SE2-4.0X3.15	#2	M5, M4	4.00mm	3.15mm
SE2-4.5X3.55	#2	M6	4.50mm	3.55mm
SE2-5.0X4.0	#2	M5	5.00mm	4.00mm
SE2-5.6X4.5	#2	M5	5.60mm	4.50mm
SE2-6.3X5.0	#2	M8, M6	6.30mm	5.00mm
SE2-7.1X5.6	#2	M7	7.10mm	5.60mm
SE2-8.0X6.3	#2	M11, M10, M8	8.00mm	6.30mm
SE2-9.0X7.1	#2	M12, M9	9.00mm	7.10mm
SE2-10.0X8.0	#2	M10	10.0mm	8.00mm
SE2-11.2X9.0	#2	M14	11.2mm	9.00mm
SE2-12.5X10.0	#2	M16	12.5mm	10.0mm
SE2-14.0X11.2	#2	M20, M18	14.0mm	11.2mm
SE2-16.0X12.5	#2	M22	16.0mm	12.5mm
SE2-18.0X14.0	#2	M24	18.0mm	14.0mm
SE3-9.0X7.1	#3	M12, M9	9.00mm	7.10mm
SE3-10.0X8.0	#3	M10	10.0mm	8.00mm
SE3-11.2X9.0	#3	M14	11.2mm	9.00mm
SE3-12.5X10.0	#3	M16	12.5mm	10.0mm
SE3-14.0X11.2	#3	M20, M18	14.0mm	11.2mm
SE3-16.0X12.5	#3	M22	16.0mm	12.5mm
SE3-18.0X14.0	#3	M24	18.0mm	14.0mm
SE3-20.0X16.0	#3	M30, M27	20.0mm	16.0mm
SE3-22.4X18.0	#3	M33	22.4mm	18.0mm
SE3-25.0X20.0	#3	M36, M33	25.0mm	20.0mm
SE3-28.0X22.4	#3	M39, M40, M42	28.0mm	22.4mm

Note: See pages 224-225 for details about dimensions cross over for ANSI, DIN, ISO, JIS Specification Taps.

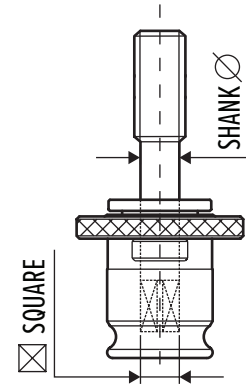

### DIMENSIONAL DATA

System	L	D1	D2
#1	0.27"	1.18"	0.75"
#2	0.43"	1.89"	1.22"
#3	0.55"	2.76"	1.89"

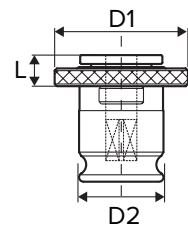

## TAP COLLETS

### POSITIVE DRIVE TAP COLLETS - DIN 371/376 STANDARD

Standard collets are used for standard and coolant-thru tap holders.

Part Number	System	Tap Size	Tap Shank $\phi$	Drive Square $\boxtimes$
SE1-2.5X2.1	#1	M1.4, M1.8, M3	2.50mm	2.10mm
SE1-2.8X2.1	#1	M2, M2.2, M2.5, M4	2.80mm	2.10mm
SE1-3.5X2.7	#1	M3, M5	3.50mm	2.70mm
SE1-4.0X3.0	#1	M3.5	4.00mm	3.00mm
SE1-4.5X3.4	#1	M4, M6	4.50mm	3.40mm
SE1-6.0X4.9	#1	M5, M6, M8	6.00mm	4.90mm
SE1-7.0X5.5	#1	M10	7.00mm	5.50mm
SE1-8.0X6.2	#1	M8, M10	8.00mm	6.20mm
SE1-9.0X7.0	#1	M12	9.00mm	7.00mm
SE1-10.0X8.0	#1	M10	10.0mm	8.00mm
SE1-11.0X9.0	#1	M14	11.0mm	9.00mm
SE2-2.8X2.1	#2	M2, M2.2, M2.5, M4	2.80mm	2.10mm
SE2-3.5X2.7	#2	M3, M5	3.50mm	2.70mm
SE2-4.0X3.0	#2	M3.5	4.00mm	3.00mm
SE2-6.0X4.9	#2	M5, M6, M8	6.00mm	4.90mm
SE2-7.0X5.5	#2	M10	7.00mm	5.50mm
SE2-8.0X6.2	#2	M8, M10	8.00mm	6.20mm
SE2-9.0X7.0	#2	M12	9.00mm	7.00mm
SE2-10.0X8.0	#2	M10	10.00mm	8.00mm
SE2-11.0X9.0	#2	M14	11.0mm	9.00mm
SE2-12.0X9.0	#2	M16	12.0mm	9.00mm
SE2-14.0X11.0	#2	M18	14.0mm	11.00mm
SE2-16.0X12.0	#2	M20	16.0mm	12.00mm
SE2-18.0X14.5	#2	M22, M24	18.0mm	14.50mm
SE3-9.0X7.0	#3	M12	9.00mm	7.00mm
SE3-10.0X8.0	#3	M10	10.00mm	8.00mm
SE3-11.0X9.0	#3	M14	11.0mm	9.00mm
SE3-12.0X9.0	#3	M16	12.0mm	9.00mm
SE3-14.0X11.0	#3	M18	14.0mm	11.0mm
SE3-16.0X12.0	#3	M20	16.0mm	12.0mm
SE3-18.0X14.5	#3	M22, M24	18.0mm	14.5mm
SE3-20.0X16.0	#3	M27, M30	20.0mm	16.0mm
SE3-22.0X18.0	#3	M30	22.0mm	18.0mm
SE3-25.0X20.0	#3	M33, M36	25.0mm	20.0mm
SE3-28.0X22.0	#3	M36	28.0mm	22.0mm

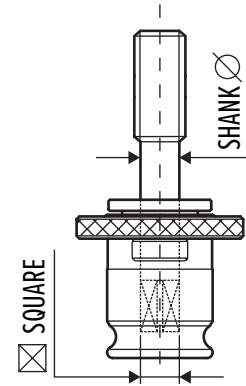

### DIMENSIONAL DATA

System	L	D1	D2
#1	0.27"	1.18"	0.75"
#2	0.43"	1.89"	1.22"
#3	0.55"	2.76"	1.89"

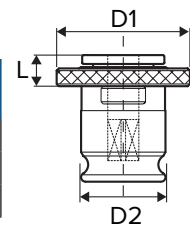

Note: See pages 224-225 for details about dimensions cross over for ANSI, DIN, ISO, JIS Specification Taps.



# TAP HOLDERS



## TAP COLLETS

### POSITIVE DRIVE TAP COLLETS - JIS STANDARD

Standard collets are used for standard and coolant-thru tap holders..

Part Number	System	Tap Size	Tap Shank $\phi$	Drive Square $\boxtimes$
SE1-3.0X2.5	#1	M2	3.00mm	2.50mm
SE1-4.0X3.2	#1	M3	4.00mm	3.20mm
SE1-5.0X4.0	#1	M4, M4.5	5.00mm	4.00mm
SE1-5.5X4.5	#1	M5, M5.5	5.50mm	4.50mm
SE1-6.0X4.5	#1	M6	6.00mm	4.50mm
SE1-6.2X5.0	#1	M7, M8	6.20mm	5.00mm
SE1-7.0X5.5	#1	M9, M10	7.00mm	5.50mm
SE1-8.0X6.0	#1	M11	8.00mm	6.00mm
SE1-8.5X6.5	#1	M12	8.50mm	6.50mm
SE1-9.5X7.0	#1	M13	9.50mm	7.00mm
SE1-10.5X8.0	#1	M14, M15	10.5mm	8.00mm
SE2-6.0X4.5	#2	M6	6.00mm	4.50mm
SE2-6.2X5.0	#2	M7, M8	6.20mm	5.00mm
SE2-7.0X5.5	#2	M9, M10	7.00mm	5.50mm
SE2-8.0X6.0	#2	M11	8.00mm	6.00mm
SE2-8.5X6.5	#2	M12	8.50mm	6.50mm
SE2-9.5X7.0	#2	M13	9.50mm	7.00mm
SE2-10.5X8.0	#2	M14, M15	10.5mm	8.00mm
SE2-12.5X10.0	#2	M16	12.5mm	10.0mm
SE2-13.0X10.0	#2	M17	13.0mm	10.0mm
SE2-14.0X11.0	#2	M18	14.0mm	11.0mm
SE2-15.0X12.0	#2	M20	15.0mm	12.0mm
SE2-17.0X13.0	#2	M22	17.0mm	13.0mm
SE3-10.5X8.0	#3	M14, M15	10.5mm	8.00mm
SE3-12.5X10.0	#3	M16	12.5mm	10.0mm
SE3-13.0X10.0	#3	M17	13.0mm	10.0mm
SE3-14.0X11.0	#3	M18	14.0mm	11.0mm
SE3-15.0X12.0	#3	M20	15.0mm	12.0mm
SE3-17.0X13.0	#3	M22	17.0mm	13.0mm
SE3-19.0X15.0	#3	M24, M25	19.0mm	15.0mm
SE3-20.0X15.0	#3	M26, M27	20.0mm	15.0mm
SE3-21.0X17.0	#3	M28	21.0mm	17.0mm
SE3-23.0X17.0	#3	M30	23.0mm	17.0mm
SE3-24.0X19.0	#3	M32	24.0mm	19.0mm
SE3-25.0X19.0	#3	M33	25.0mm	19.0mm
SE3-26.0X21.0	#3	M34, M35	26.0mm	21.0mm
SE3-28.0X21.0	#3	M36, M38	28.0mm	21.0mm

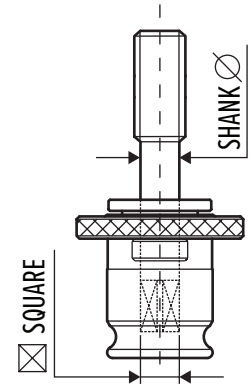

### DIMENSIONAL DATA

System	L	D1	D2
#1	0.27"	1.18"	0.75"
#2	0.43"	1.89"	1.22"
#3	0.55"	2.76"	1.89"

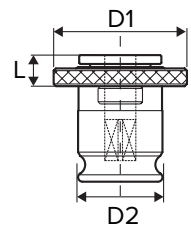

Note: See pages 224-225 for details about dimensions cross over for ANSI, DIN, ISO, JIS Specification Taps.



## TAP COLLETS

### TORQUE CONTROL TAP COLLETS - ANSI STANDARD

Standard collets are used for standard and coolant-thru tap holders.  
Adjustable torque - see preset torque tables on page 226.

Part Number	System	Tap Size	Tap Shank $\phi$	Drive Square $\boxtimes$
T05-006	#1	#0-6	0.141"	0.110"
T05-008	#1	#8	0.168"	0.131"
T05-010	#1	#10	0.194"	0.152"
T05-012	#1	#12	0.220"	0.165"
T05-016	#1	1/4"	0.255"	0.191"
T05-020	#1	5/16"	0.318"	0.238"
T05-024	#1	3/8"	0.381"	0.286"
T05-028	#1	7/16"	0.323"	0.242"
T05-032	#1	1/2"	0.367"	0.275"
T05-036	#1	9/16"	0.429"	0.322"
T10-020	#2	5/16"	0.318"	0.238"
T10-024	#2	3/8"	0.381"	0.286"
T10-028	#2	7/16"	0.323"	0.242"
T10-032	#2	1/2"	0.367"	0.275"
T10-036	#2	9/16"	0.429"	0.322"
T10-040	#2	5/8"	0.480"	0.360"
T10-044	#2	11/16"	0.542"	0.406"
T10-048	#2	3/4"	0.590"	0.442"
T10-052	#2	13/16"	0.652"	0.489"
T10-056	#2	7/8"	0.697"	0.523"
T10-064*	#2	1"	0.800"	0.600"
T15-052	#3	13/16"	0.652"	0.489"
T15-056	#3	7/8"	0.697"	0.523"
T15-060	#3	15/16"	0.760"	0.570"
T15-064	#3	1"	0.800"	0.600"
T15-072	#3	1-1/8"	0.896"	0.672"
T15-080	#3	1-1/4"	1.021"	0.766"
T15-088	#3	1-3/8"	1.108"	0.831"

Note:

- \*The tap is held with set screws.
- See pages 224-225 for details about dimensions cross over for ANSI, DIN, ISO, JIS Specification Taps.

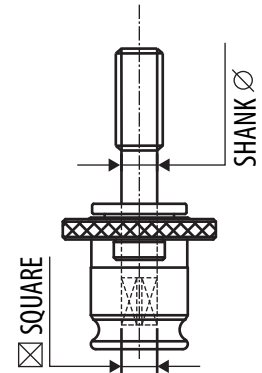

### DIMENSIONAL DATA

System	L	D1	D2
#1	0.98"	1.28"	0.75"
#2	1.34"	1.99"	1.22"
#3	1.77"	2.83"	1.89"

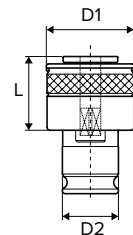

### TORQUE CONTROL TAP COLLET SETS

Part Number	Description
T05-SET-10	10 Piece System #1 Torque Control Tap Collet Set: #0 - 9/16" hand
T10-SET-10	10 Piece System #2 Torque Control Tap Collet Set: 5/16" - 7/8" hand
T15-SET-07	7 Piece System #3 Torque Control Tap Collet Set: 13/16" - 1-3/8" hand



# TAP HOLDERS



## TAP COLLETS

### TORQUE CONTROL TAP COLLETS - ANSI STANDARD -SLOTTED

Slotted collets are designed for use with standard taps for coolant along the flute. Adjustable torque - see preset torque tables on page 226.

Part Number	System	Tap Size	Tap Shank $\phi$	Drive Square $\boxtimes$
T05-006(S)	#1	#0-6	0.141"	0.110"
T05-008(S)	#1	#8	0.168"	0.131"
T05-010(S)	#1	#10	0.194"	0.152"
T05-012(S)	#1	#12	0.220"	0.165"
T05-016(S)	#1	1/4"	0.255"	0.191"
T05-020(S)	#1	5/16"	0.318"	0.238"
T05-024(S)	#1	3/8"	0.381"	0.286"
T05-028(S)	#1	7/16"	0.323"	0.242"
T05-032(S)	#1	1/2"	0.367"	0.275"
T05-036(S)	#1	9/16"	0.429"	0.322"
T10-020(S)	#2	5/16"	0.318"	0.238"
T10-024(S)	#2	3/8"	0.381"	0.286"
T10-028(S)	#2	7/16"	0.323"	0.242"
T10-032(S)	#2	1/2"	0.367"	0.275"
T10-036(S)	#2	9/16"	0.429"	0.322"
T10-040(S)	#2	5/8"	0.480"	0.360"
T10-044(S)	#2	11/16"	0.542"	0.406"
T10-048(S)	#2	3/4"	0.590"	0.442"
T10-052(S)	#2	13/16"	0.652"	0.489"
T10-056(S)	#2	7/8"	0.697"	0.523"
T10-064(S)*	#2	1"	0.800"	0.600"
T15-052(S)	#3	13/16"	0.652"	0.489"
T15-056(S)	#3	7/8"	0.697"	0.523"
T15-060(S)	#3	15/16"	0.760"	0.570"
T15-064(S)	#3	1"	0.800"	0.600"
T15-072(S)	#3	1-1/8"	0.896"	0.672"
T15-080(S)	#3	1-1/4"	1.021"	0.766"
T15-088(S)	#3	1-3/8"	1.108"	0.831"

Note:

- \*The tap is held with set screws.
- See pages 224-225 for details about dimensions cross over for ANSI, DIN, ISO, JIS Specification Taps.

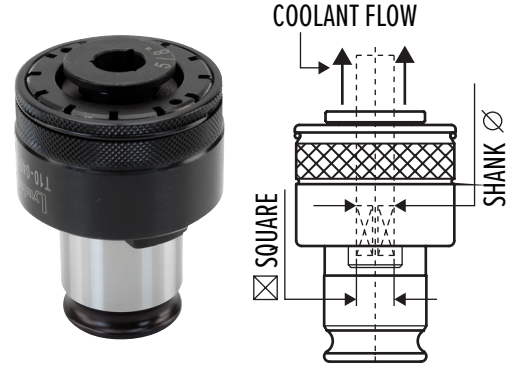

### DIMENSIONAL DATA

System	L	D1	D2
#1	0.98"	1.28"	0.75"
#2	1.34"	1.99"	1.22"
#3	1.77"	2.83"	1.89"

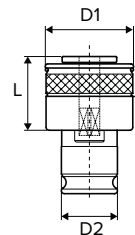

## TAP COLLETS

### TORQUE CONTROL PIPE TAP COLLETS - ANSI STANDARD

Adjustable torque - see preset torque tables on page 226.

Part Number	System	Tap Size	Tap Shank $\phi$	Drive Square $\boxtimes$
TPT05-008S	#1	1/8"S	0.313"	0.234"
TPT05-008L	#1	1/8"L	0.437"	0.328"
TPT10-016	#2	1/4"	0.562"	0.421"
TPT10-024	#2	3/8"	0.700"	0.531"
TPT10-032	#2	1/2"	0.687"	0.515"
TPT15-032	#3	1/2"	0.687"	0.515"
TPT15-048	#3	3/4"	0.906"	0.679"
TPT15-064	#3	1"	1.125"	0.843"

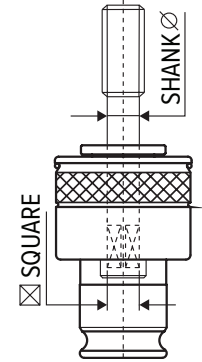

### TORQUE CONTROL PIPE TAP COLLETS - ANSI STANDARD - SLOTTED

Slotted collets are designed for use with standard taps for coolant along the flute.

Adjustable torque - see preset torque tables on page 226.

Part Number	System	Tap Size	Tap Shank $\phi$	Drive Square $\boxtimes$
TPT05-008S(S)	#1	1/8"S	0.313"	0.234"
TPT05-008L(S)	#1	1/8"L	0.437"	0.328"
TPT10-016(S)	#2	1/4"	0.562"	0.421"
TPT10-024(S)	#2	3/8"	0.700"	0.531"
TPT10-032(S)	#2	1/2"	0.687"	0.515"
TPT15-032(S)	#3	1/2"	0.687"	0.515"
TPT15-048(S)	#3	3/4"	0.906"	0.679"
TPT15-064(S)	#3	1"	1.125"	0.843"

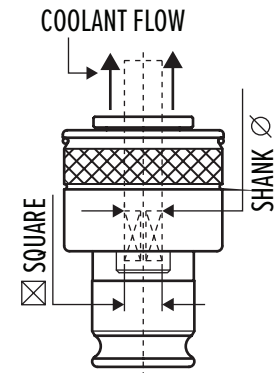

### TORQUE CONTROL PIPE TAP COLLET SETS

Part Number	Description
TPO5-SET-12	12 Piece System #1 Torque Control Tap Collet Set: #0-9/16" hand and 1/8" pipe large & small
TP10-SET-13	13 Piece System #2 Torque Control Tap Collet Set: 5/16" - 7/8" hand and 1/4" - 1/2" pipe
TP15-SET-10	10 Piece System #3 Torque Control Tap Collet Set: 13/16" - 1-3/8" hand and 1/2" - 1" pipe

### DIMENSIONAL DATA

System	L	D1	D2
#1	0.98"	1.28"	0.75"
#2	1.34"	1.99"	1.22"
#3	1.77"	2.83"	1.89"

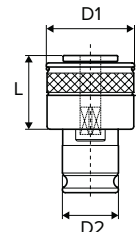

# TAP HOLDERS



TAP HOLDERS

## TAP COLLETS

### TORQUE CONTROL TAP COLLETS - ISO 529 STANDARD

Standard collets are used for standard and coolant-thru tap holders.  
Adjustable torque - see preset torque tables on page 226.

Part Number	System	Tap Size	Tap Shank $\phi$	Drive Square $\boxtimes$
SES1-2.50X2.0	#1	M3.5, M2	2.50mm	2.00mm
SES1-2.80X2.24	#1	M2.2, M2.5	2.80mm	2.24mm
SES1-3.15X2.50	#1	M4, M3	3.15mm	2.50mm
SES1-3.55X2.80	#1	M4.5, M3.5	3.55mm	2.80mm
SES1-4.0X3.15	#1	M5, M4	4.00mm	3.15mm
SES1-4.5X3.55	#1	M6	4.50mm	3.55mm
SES1-5.0X4.0	#1	M5	5.00mm	4.00mm
SES1-5.6X4.5	#1	M5.5, M7	5.60mm	4.50mm
SES1-6.3X5.0	#1	M8, M6	6.30mm	5.00mm
SES1-7.1X5.6	#1	M7	7.10mm	5.60mm
SES1-8.0X6.3	#1	M11, M10, M8	8.00mm	6.30mm
SES1-9.0X7.1	#1	M12, M9	9.00mm	7.10mm
SES1-10.0X8.0	#1	M10	10.0mm	8.00mm
SES1-11.2X9.0	#1	M14	11.2mm	9.00mm
SES2-4.0X3.15	#2	M4, M5	4.00mm	3.15mm
SES2-4.5X3.55	#2	M6	4.50mm	3.55mm
SES2-5.0X4.0	#2	M5	5.00mm	4.00mm
SES2-5.6X4.5	#2	M5.5, M7	5.60mm	4.50mm
SES2-6.3X5.0	#2	M8, M6	6.30mm	5.00mm
SES2-7.1X5.6	#2	M7	7.10mm	5.60mm
SES2-8.0X6.3	#2	M11, M10, M8	8.00mm	6.30mm
SES2-9.0X7.1	#2	M12, M9	9.00mm	7.10mm
SES2-10.0X8.0	#2	M10	10.0mm	8.00mm
SES2-11.2X9.0	#2	M14	11.2mm	9.00mm
SES2-12.5X10.0	#2	M16	12.5mm	10.0mm
SES2-13.0X10.0	#2	M17	13.0mm	10.0mm
SES2-14.0X11.2	#2	M20, M18	14.0mm	11.2mm
SES2-16.0X12.5	#2	M22	16.0mm	12.5mm
SES2-18.0X14.0	#2	M24	18.0mm	14.0mm
SES2-19.0X15.0	#2	M24, M25	19.0mm	15.0mm
SES3-9.0X7.1	#3	M9, M12	9.0mm	7.10mm
SES3-10.0X8.0	#3	M10	10.0mm	8.00mm
SES3-11.2X9.0	#3	M14	11.2mm	9.00mm
SES3-12.5X10.0	#3	M16	12.5mm	10.0mm
SES3-14.0X11.2	#3	M18, M20	14.0mm	11.2mm
SES3-18.0X14.0	#3	M24	18.0mm	14.0mm
SES3-20.0X16.0	#3	M30, M27	20.0mm	16.0mm
SES3-22.4X18.0	#3	M33	22.4mm	18.0mm
SES3-25.0X20.0	#3	M36, M33	25.0mm	20.0mm
SES3-28.0X22.4	#3	M42, M39	28.0mm	22.4mm

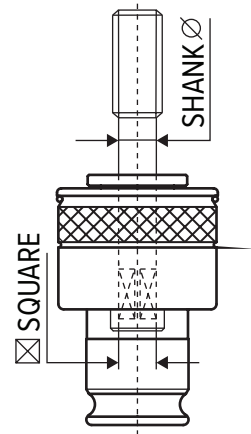

### DIMENSIONAL DATA

System	L	D1	D2
#1	0.98"	1.28"	0.75"
#2	1.34"	1.99"	1.22"
#3	1.77"	2.83"	1.89"

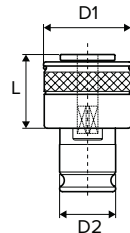

## TAP COLLETS

### TORQUE CONTROL TAP COLLETS - DIN 371/376 STANDARD

Standard collets are used for standard and coolant-thru tap holders.  
Adjustable torque - see preset torque tables on page 226.

Part Number	System	Tap Size	Tap Shank $\phi$	Drive Square $\boxtimes$
SES1-2.5X2.1	#1	M1.4, M1.8, M3	2.50mm	2.10mm
SES1-2.8X2.1	#1	M2, M2.2, M2.5, M4	2.80mm	2.10mm
SES1-3.5X2.7	#1	M3, M5	3.50mm	2.70mm
SES1-4.0X3.0	#1	M3.5	4.00mm	3.00mm
SES1-4.5X3.4	#1	M4, M6	4.50mm	3.40mm
SES1-6.0X4.9	#1	M5, M6, M8	6.00mm	4.90mm
SES1-7.0X5.5	#1	M10	7.00mm	5.50mm
SES1-8.0X6.2	#1	M8, M10	8.00mm	6.20mm
SES1-9.0X7.0	#1	M12	9.00mm	7.00mm
SES1-10.0X8.0	#1	M10	10.0mm	8.00mm
SES1-11.0X9.0	#1	M14	11.0mm	9.00mm
SES2-3.5X2.7	#2	M3, M5	3.50mm	2.70mm
SES2-4.0X3.0	#2	M3.5	4.00mm	3.00mm
SES2-4.5X3.4	#2	M4, M6	4.50mm	3.40mm
SES2-6.0X4.9	#2	M5, M6, M8	6.00mm	4.90mm
SES2-7.0X5.5	#2	M10	7.00mm	5.50mm
SES2-8.0X6.2	#2	M8, M10	8.00mm	6.20mm
SES2-9.0X7.0	#2	M12	9.00mm	7.00mm
SES2-10.0X8.0	#2	M10	10.0mm	8.00mm
SES2-11.0X9.0	#2	M14	11.0mm	9.00mm
SES2-12.0X9.0	#2	M16	12.0mm	9.00mm
SES2-14.0X11.0	#2	M18	14.0mm	11.0mm
SES2-16.0X12.0	#2	M20	16.0mm	12.0mm
SES2-18.0X14.5	#2	M22, M24	18.0mm	14.5mm
SES3-8.0X6.2	#2	M8, M10	8.00mm	6.20mm
SES3-9.0X7.0	#3	M12	9.00mm	7.00mm
SES3-10.0X8.0	#3	M10	10.0mm	8.00mm
SES3-11.0X9.0	#3	M14	11.0mm	9.00mm
SES3-12.0X9.0	#3	M16	12.0mm	9.00mm
SES3-14.0X11.0	#3	M18	14.0mm	11.0mm
SES3-16.0X12.0	#3	M20	16.0mm	12.0mm
SES3-18.0X14.5	#3	M22, M24	18.0mm	14.5mm
SES3-20.0X16.0	#3	M27, M30	20.0mm	16.0mm
SES3-22.0X18.0	#3	M30	22.0mm	18.0mm
SES3-25.0X20.0	#3	M33, M36	25.0mm	20.0mm
SES3-28.0X22.0	#3	M36	28.0mm	22.0mm

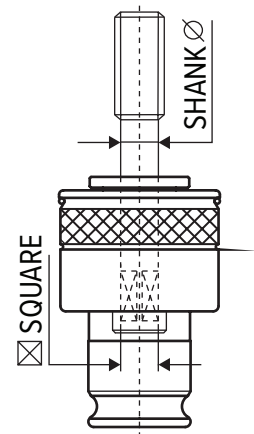

### DIMENSIONAL DATA

System	L	D1	D2
#1	0.98"	1.28"	0.75"
#2	1.34"	1.99"	1.22"
#3	1.77"	2.83"	1.89"

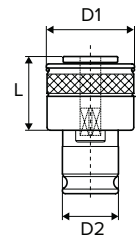

# TAP HOLDERS



TAP HOLDERS

## TAP COLLETS

### TORQUE CONTROL TAP COLLETS - JIS STANDARD

Standard collets are used for standard and coolant-thru tap holders.  
Adjustable torque - see preset torque tables on page 226.

Part Number	System	Tap Size	Tap Shank $\phi$	Drive Square $\boxtimes$
SES1-3.0X2.5	#1	M2	3.00mm	2.50mm
SES1-4.0X3.2	#1	M3	4.00mm	3.20mm
SES1-5.0X4.0	#1	M4, M4.5	5.00mm	4.00mm
SES1-5.5X4.5	#1	M5, M5.5	5.50mm	4.50mm
SES1-6.0X4.5	#1	M6	6.00mm	4.50mm
SES1-6.2X5.0	#1	M7, M8	6.20mm	5.00mm
SES1-7.0X5.5	#1	M9, M10	7.00mm	5.50mm
SES1-8.0X6.0	#1	M11	8.00mm	6.00mm
SES1-8.5X6.5	#1	M12	8.50mm	6.50mm
SES1-10.5X8.0	#1	M14, M15	10.5mm	8.00mm
SES2-6.0X4.5	#2	M6	6.00mm	4.50mm
SES2-6.2X5.0	#2	M7, M8	6.20mm	5.00mm
SES2-7.0X5.5	#2	M9, M10	7.00mm	5.50mm
SES2-8.0X6.0	#2	M11	8.00mm	6.00mm
SES2-8.5X6.5	#2	M12	8.50mm	6.50mm
SES2-9.5X7.0	#2	M13	9.50mm	7.00mm
SES2-10.5X8.0	#2	M14, M15	10.5mm	8.00mm
SES2-12.5X10.0	#2	M16	12.5mm	10.0mm
SES3-13.0X10.0	#2	M16	13.0mm	10.0mm
SES2-14.0X11.0	#2	M18	14.0mm	11.0mm
SES2-15.0X12.0	#2	M20	15.0mm	12.0mm
SES2-17.0X13.0	#2	M22	17.0mm	13.0mm
SES3-10.5X8.0	#3	M14, M15	10.5mm	8.00mm
SES3-12.5X10.0	#3	M16	12.5mm	10.0mm
SES3-13.0X10.0	#3	M17	13.0mm	10.0mm
SES3-14.0X11.0	#3	M18	14.0mm	11.0mm
SES3-15.0X12.0	#3	M20	15.0mm	12.0mm
SES3-17.0X13.0	#3	M22	17.0mm	13.0mm
SES3-19.0X15.0	#3	M24, M25	19.0mm	15.0mm
SES3-20.0X15.0	#3	M26, M27	20.0mm	15.0mm
SES3-21.0X17.0	#3	M28	21.0mm	17.0mm
SES3-23.0X17.0	#3	M30	23.0mm	17.0mm
SES3-23.0X17.0	#3	M30	23.0mm	17.0mm
SES3-24.0X19.0	#3	M32	24.0mm	19.0mm
SES3-25.0X19.0	#3	M33	25.0mm	19.0mm
SES3-26.0X21.0	#3	M34, M35	26.0mm	21.0mm
SES3-28.0X21.0	#3	M36, M38	28.0mm	21.0mm

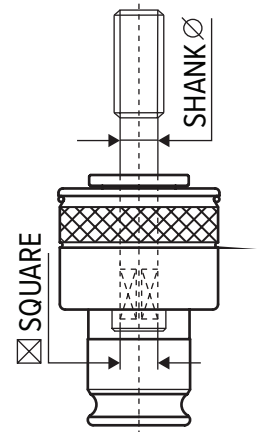

### DIMENSIONAL DATA

System	L	D1	D2
#1	0.98"	1.28"	0.75"
#2	1.34"	1.99"	1.22"
#3	1.77"	2.83"	1.89"

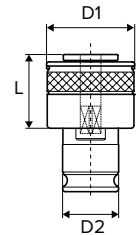

## TAP HOLDER ACCESSORIES

### TAP COLLET REDUCERS

Part Number	Description
<b>CRE-2/1</b>	System #2 Reduction Adapter to System #1
<b>CRE-3/2</b>	System #3 Reduction Adapter to System #2



### TAP COLLET RACKS

Part Number	Description
<b>RACK-ER20/1TAP</b>	System #1 Tap Collet Rack, 24 piece capacity
<b>RACK-ER32/2TAP</b>	System #2 Tap Collet Rack, 32 piece capacity



### SPANNER WRENCH FOR TAP HOLDERS

Part Number	Description
<b>T05-SPAN</b>	Fits System #1 Torque Control Tap Collets
<b>T10-SPAN</b>	Fits System #2 Torque Control Tap Collets
<b>T15-SPAN</b>	Fits System #3 Torque Control Tap Collets



### COOLANT TUBE WRENCH FOR HSK HOLDERS

Part Number	Description
<b>HSK40-WRENCH</b>	Wrench for HSK40 Coolant Tube
<b>HSK63-WRENCH</b>	Wrench for HSK63 Coolant Tube
<b>HSK100-WRENCH</b>	Wrench for HSK100 Coolant Tube



### COOLANT TUBE FOR HSK HOLDERS

Part Number	Description
<b>HSK40-TUBE</b>	Coolant Tube for HSK40 holder
<b>HSK63-TUBE</b>	Coolant Tube for HSK63 holder
<b>HSK100-TUBE</b>	Coolant Tube for HSK100 holder





## TAPPING - TECHNICAL DETAILS

### Tap Shank Standards

- Tap shanks are manufactured to many international standards, each specified by their country of origin. Although most taps sold in North America comply with the ANSI B94.9 standard, we appreciate your assistance to help further qualify the matching tap collet necessary by providing the round shank size and the drive square dimensions.
- Please note not all taps were designed to be held in a tap collet compliant to ANSI, ISO, DIN or JIS standards. Please call us to discuss more alternatives for tapping.

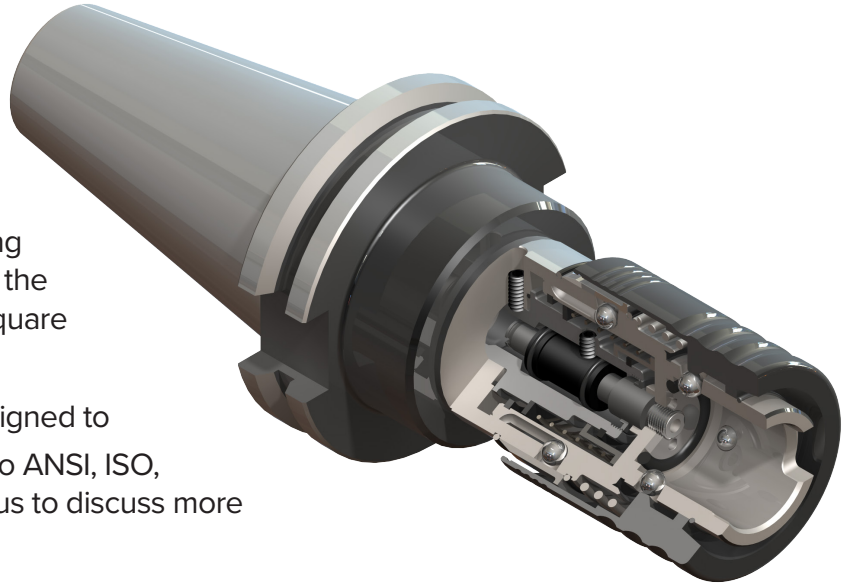

### Tap Collet Systems

- All Lyndex-Nikken tap collets are based on the “Bilz” standard quick-change system and will interchange with other manufacturers compliant to the same standard.
- Lyndex-Nikken does not offer tap collets for the Intertap system.
- Please take into consideration the nature of each application before determining which system (system 1,2 or 3) suits your needs. If the same tap collet size is offered within two different systems, we recommend that harder materials should utilize a larger tap collet series to help sustain the required torque capacity and rigidity for the operation.

### Rigid Tap Holders

- Rigid Tap Holders should only be used on equipment that have the ability to synchronize spindle rotation and spindle feed, commonly referred to as “Direct Tapping”, “Rigid Tapping” or “Electronic Lead Screw Tapping”.
- Rigid Tap Holders do not have the tension and compression ability as a traditional float mechanism and therefore offer no protection from overloads such as under-sized holes, wornout taps or misplaced cored holes in castings.
- The use of Rigid Tap Holders on non-synchronized machinery will result in poor threads and/or damage to tapping holder or collets.

## TAP DIMENSIONAL DATA

TAP HOLDERS

Shank Diameter		Square Diameter		U.S.		JIS	DIN 371	DIN 376	ISO
Inch	Metric	Inch	Metric	Metric	Inch	Metric	Metric	Metric	Metric
0.088	2.2	0.070	1.8				M3		
0.098	2.5	0.078	2.0				M3.5, M2		
0.098	2.5	0.083	2.1						M1 - M1.8
0.109	2.8	0.088	2.2				M2.5, M2.2		
0.110	2.8	0.083	2.1						M2 - M2.5
0.123	3.2	0.098	2.5				M4, M3		
0.138	3.5	0.106	2.7						M3
0.139	3.6	0.109	2.8				M4.5, M3.5		
0.141	3.6	0.110	2.8	M1.6 - M3.5	#0 - #6				
0.156	4.0	0.123	3.2				M5, M4		
0.157	4.0	0.118	3.0						M3.5
0.168	4.3	0.131	3.3	M4	#8				
0.176	4.5	0.139	3.6				M6		
0.177	4.5	0.134	3.4						M4
0.194	4.9	0.152	3.9	M5	#10				
0.196	5.0	0.156	4.0				M5		
0.197	5.0	0.157	4.0			M4			
0.217	5.5	0.177	4.5			M5			
0.219	5.6	0.176	4.5				M5		
0.220	5.6	0.165	4.2	M6	#12				
0.225	5.7	0.191	4.9		1/4"				
0.236	6.0	0.193	4.9					M8	
0.236	6.0	0.177	4.5			M6			
0.236	6.0	0.193	4.9						M5, M6
0.244	6.2	0.197	5.0			M7, M8			
0.246	6.3	0.196	5.0				M8, M6		
0.276	7.0	0.217	5.5			M9, M10		M10	
0.278	7.1	0.219	5.6				M7		
0.313	8.0	0.246	6.3				M11, M10, M8		
0.315	8.0	0.236	6.0			M11			
0.315	8.0	0.244	6.2						M8
0.318	8.1	0.238	6.0	M7, M8	5/16"				
0.323	8.2	0.242	6.1		7/16"				
0.335	8.5	0.256	6.5			M12			
0.352	9.0	0.278	7.1				M12, M9		
0.354	9.0	0.276	7.0					M12	
0.367	9.3	0.275	7.0	M12	1/2"				
0.381	9.7	0.286	7.3	M10	3/8"				
0.391	10.0	0.313	8.0				M10		
0.394	10.0	0.315	8.0						M10
0.413	10.5	0.315	8.0			M14, M15			
0.429	10.9	0.322	8.2	M14	9/16"				
0.433	11.0	0.354	9.0					M14	
0.438	11.2	0.352	9.0				M14		
0.451	11.5	0.406	10.3	M18	11/16"				
0.472	12.0	0.354	9.0					M16	
0.480	12.2	0.360	9.1	M16	5/8"				
0.489	12.5	0.391	10.0				M16		
0.492	12.5	0.394	10.0			M16			

# TAP HOLDERS



## TAP DIMENSIONAL DATA

Shank Diameter		Square Diameter		U.S.		JIS	DIN 371	DIN 376	ISO
Inch	Metric	Inch	Metric	Metric	Inch	Metric	Metric	Metric	Metric
0.512	13.0	0.394	10.0			M17			
0.547	14.0	0.438	11.2				M20, M18		
0.551	14.0	0.433	11.0			M18		M18	
0.590	15.0	0.442	11.2		3/4"				
0.591	15.0	0.472	12.0			M20			
0.626	16.0	0.489	12.5				M22		
0.630	16.0	0.472	12.0					M20	
0.652	16.6	0.489	12.4	M20	13/16"				
0.669	17.0	0.512	13.0			M22			
0.697	17.7	0.523	13.3	M22	7/8"				
0.704	18.0	0.547	14.0				M24		
0.709	18.0	0.571	14.5					M22, M24	
0.748	19.0	0.591	15.0			M25			
0.760	19.3	0.570	14.5	M24	15/16"				
0.782	20.0	0.626	16.0				M30, M27		
0.787	20.0	0.630	16.0					M27	
0.787	20.0	0.591	15.0			M26, M27			
0.800	20.3	0.600	15.2	M25	1"				
0.827	21.0	0.669	17.0			M28			
0.866	22.0	0.709	18.0					M30	
0.876	22.4	0.704	18.0				M33		
0.896	22.8	0.672	17.1	M27	1-1/16"				
0.906	23.0	0.669	17.0			M30			
0.945	24.0	0.748	19.0			M32			
0.978	25.0	0.782	20.0				M36, M33		
0.984	25.0	0.787	20.0					M33	
0.984	25.0	0.748	19.0			M33			
1.021	25.9	0.766	19.5	M30	1-3/16"				
1.024	26.0	0.827	21.0			M34, M35			
1.095	28.0	0.876	22.4				M42, M39		
1.102	28.0	0.866	22.0					M36	
1.102	28.0	0.827	21.0			M36, M38			
1.108	28.1	0.831	21.1	M33	1-5/16"				
1.181	30.0	0.906	23.0			M39, M40			
1.260	32.0	0.945	24.0					M39, M42	
1.260	32.0	1.024	26.0			M42			
1.417	36.0	1.142	29.0					M45, M48	
1.575	40.0	1.260	32.0					M52	

## TORQUE CONTROL TAP COLLET TORQUE SPECIFICATIONS

### PRESET TORQUE FOR TAP COLLETS - ANSI

Tap Size	Torque Setting (ft./lbs.)
#0-1	0.14
#2	0.22
#3	0.29
#4	0.36
#5	0.58
#6	0.72
#8	1
#10	2
#12	3

Tap Size	Torque Setting (ft./lbs.)
1/4"	4
5/16"	7
3/8"	12
7/16"	16
1/2"	24
9/16"	29
5/8"	36
11/16"	44
3/4"	51

Tap Size	Torque Setting (ft./lbs.)
13/16"	57
7/8"	72
15/16"	77
1"	101
1-1/8"	145

TAP HOLDERS

### PRESET TORQUE FOR TAP COLLETS - ISO

Tap Shank x Square	Tap Size	Torque Setting (N.m)	
2.24 x 1.8	M 3	0.5	○
2.5 x 2	M 2	0.3	■
	M 3.5	0.8	○
2.8 x 2.24	M 2.2	0.35	■
	M 2.5	0.4	○
3.15 x 2.5	M 3	0.5	■
	M 4	1.2	○
3.55 x 2.8	M 3.5	0.8	■
	M 4.5	1.6	○
4 x 3.15	M 4	1.2	■
	M 5	2	○
4.5 x 3.55	M 4.5	1.6	■
	M 6	4	○
5 x 4	M 5	2	○
	M 7	6	○
5.6 x 4.5	M 6	4	■
	M 8	8	○
7.1 x 5.6	M 7	6	○
	M 10	16	■
8 x 6.3	M 8	8	○
	M 10	16	■
	M 11	18	■
	M 12	22	○
10 x 8	M 10	16	○
	M 14	36	○
11.2 x 9	M 16	40	○
	M 20	70	■
14 x 11.2	M 18	63	○
	M 22	80	○
16 x 12.5	M 24	125	○
	M 30	220	○
22.4 x 18	M 33	240	○
	M 36	280	■
25 x 20	M 36	280	○
	M 39	320	○
28 x 22.4	M 39	320	○
	M 42	420	■

### PRESET TORQUE FOR TAP COLLETS - DIN

Tap Shank x Square	Tap Size	Torque Setting (N.m)	
2.5 x 2.1	M 1.8	0.3	○
	M 3	0.5	■
2.8 x 2.1	M 2	0.3	■
	M 2.2	0.35	■
	M 2.5	0.4	○
	M 4	1.2	■
3.5 x 2.7	M 3	0.5	○
	M 5	2	■
4 x 3	M 3.5	0.8	○
	M 4	1.2	○
4.5 x 3.4	M 6	4	■
	M 5	2	■
6 x 4.9	M 6	4	■
	M 8	8	○
7 x 5.5	M 10	16	○
	M 8	8	○
8 x 6.2	M 8	8	○
	M 11	18	■
9 x 7	M 12	22	○
	M 10	16	○
10 x 8	M 14	36	○
	M 16	40	○
11 x 9	M 16	40	■
	M 18	63	○
12 x 9	M 16	40	○
	M 18	63	○
14 x 11	M 16	40	■
	M 18	63	○
16 x 12	M 20	70	○
	M 22	80	■
18 x 14.5	M 24	125	○
	M 27	140	○
20 x 16	M 30	220	○
	M 33	240	○
22 x 18	M 36	280	■
	M 36	280	○
25 x 20	M 36	280	○
	M 36	280	○
28 x 22	M 36	280	○
	M 36	280	○

Note:

- - Standard setting
- - Setting on request

### PRESET TORQUE FOR TAP COLLETS - JIS

Tap Shank x Square	Tap Size	Torque Setting (N.m)
3 x 2.5	M 2	0.6
4 x 3.2	M 3	1
5 x 4	M 4	2.3
5.5 x 4.5	M 5	3.6
6 x 4.5	M 6	5.9
6.2 x 5	M 8	12
7 x 5.5	M 10	22
8 x 6	M 11	25
8.5 x 6.5	M 12	31
9.5 x 7	M 13	39
10.5 x 8	M 14	46
12.5 x 10	M 16	51
13 x 10	M 17	67
14 x 11	M 18	80
15 x 12	M 20	88
17 x 13	M 22	98
19 x 15	M 24	132
20 x 15	M 27	157
21 x 17	M 28	175
23 x 17	M 30	225
24 x 19	M 32	235
25 x 19	M 33	245
26 x 21	M 34	265
28 x 21	M 36	304

