

## NMTB, HSK and Straight Shank

Drill/Morse

- Compact design and small head prevent drill slippage during operation
- Balanced to 12,000 RPM
- Coolant-thru capable



**Speed:** up to 12,000 RPM



**Set-up:** quick and easy



**Coolant-Thru:** available



Drilling



Reaming

Please note that the maximum RPM listed in our catalog may vary depending on the toolholder shank, weight, balanceability and the G rating.

### NMTB40/50

Part Number	Taper	Capacity	L	L1	D
NMTB40-NPU8-76	NMTB40	5/16" (8.0mm)	3.25"	3.52"	1.36"
NMTB40-NPU13-86	NMTB40	1/2" (13.0mm)	3.62"	4.06"	1.81"
NMTB50-NPU13-86	NMTB50	1/2" (13.0mm)	3.62"	4.06"	1.81"

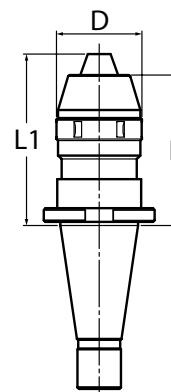

### HSK40A/100A

Part Number	Taper	Capacity	L	L1	D
HSK40A-NPU8-114	HSK40A	0-5/16" (0-8.0mm)	4.48"	4.76"	1.52"
HSK100A-NPU13C-145	HSK100A	1/2" (13.0mm)	5.98"	6.42"	1.81"

Note: Coolant Tubes and Coolant Tube Wrenches are sold separately. See page 153 for more details.

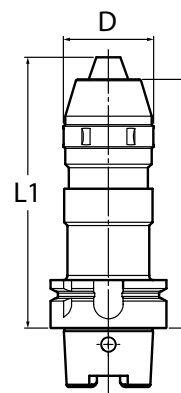

### Straight Shank

Part Number	Capacity	D	D1	L	L1
D1.1/4-NPU13-6.23	3/32-1/2" (2-13.0mm)	1.92"	1.1/4"	6.23"	2.44"
D1.1/2-NPU13-6.35	3/32-1/2" (2-13.0mm)	1.92"	1.1/2"	6.35"	2.75"

