



ER16 Offset OD Drill/Milling Unit 2 Output Y-Axis (Main)

Part #: MNL12-ER16Y-OFF-MD Mori Seiki Part #: T32267



Clockwise Input

Clockwise Output

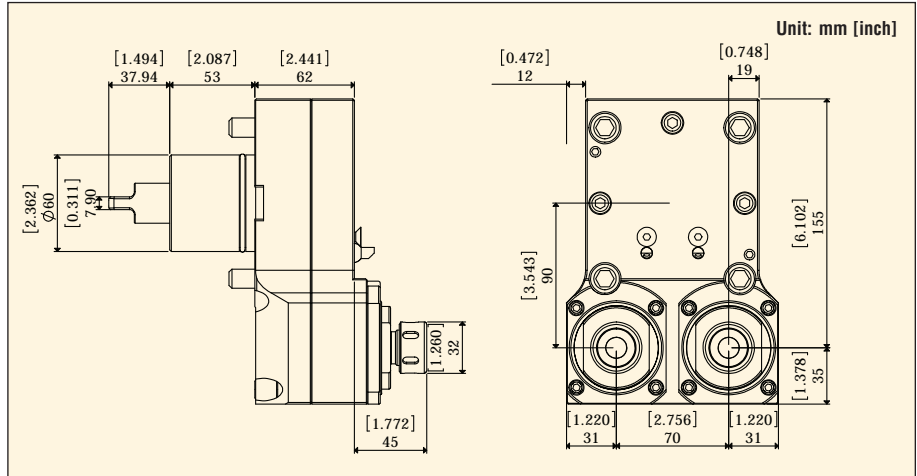
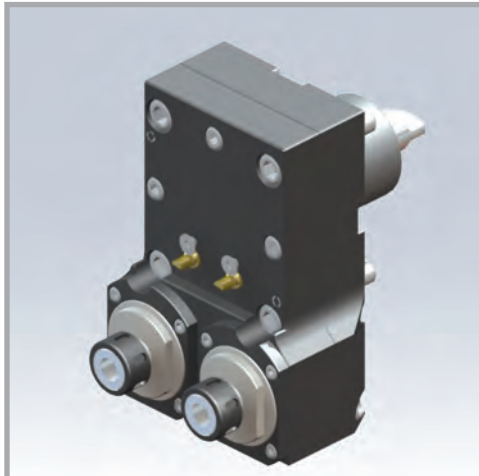

External or Internal Coolant	Radial/Axial	Max. RPM	Gear Ratio	Max. Torque Output	Collet Size	Replacement Nut	Coolant Nozzle	Spanner Wrench	
								for Spindle	for Nut
External	Radial	6000	1:1	29.5ft-lbs (40N-m)	ER16 (1/64" to 13/32")	NA16	HI10337110	SP-41	FK-4

Please refer to pages 77 - 80 for ER Series Collets and ER Tap Collets details.

ER25 OD Drill/Milling Unit, 2 Output X-Axis (Main & Sub)

Part #: MNL12-ER25X-MSD



Clockwise Input

Clockwise Output

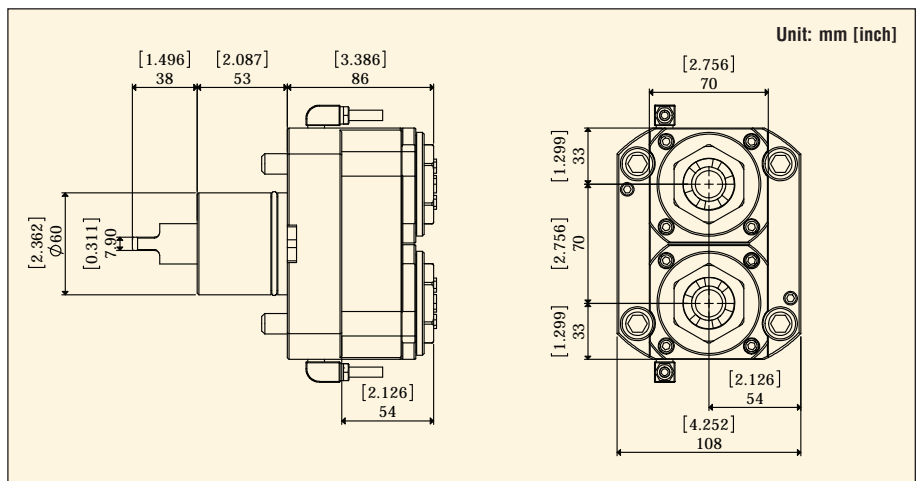
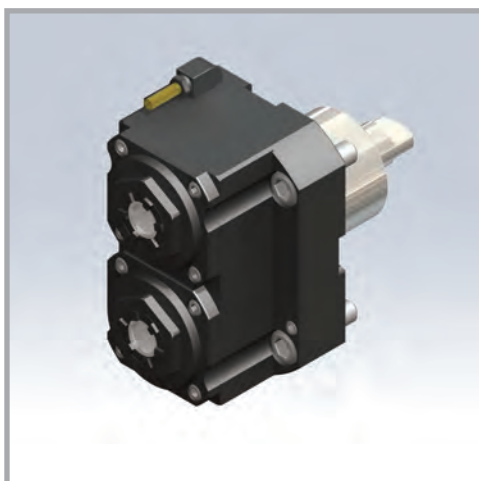

External or Internal Coolant	Radial/Axial	Max. RPM	Gear Ratio	Max. Torque Output	Collet Size	Replacement Nut	Coolant Nozzle	Spanner Wrench	
								for Spindle	for Nut
External	Radial	6000	1:1	7.37ft-lbs (10N-m)	ER25 (1/16" to 5/8")	NUT-ER25I	PAP-CU-6X4X100-SET	SP-41	WRENCH-ER25I

Please refer to pages 77 - 80 for ER Series Collets and ER Tap Collets details.